



2/29 Wagtail Crescent, BATEHAVEN, NSW 2536

Effortless Living in a Near-New Designer Duplex

Presented in near-new condition, this contemporary 3-bedroom duplex offers a seamless blend of modern design, quality finishes and an easy-care lifestyle, all enhanced by the added benefit of no strata fees.

From the outset, the home showcases low-maintenance street appeal, with neatly presented, easy-care landscaping creating a welcoming and polished first impression that carries through to the private alfresco setting.

Step inside to a light-filled, generously proportioned entry, where high ceilings and extra-tall doors immediately establish a sense of space and quiet sophistication. Underfoot, elegant tiles inspired by travertine and limestone provide a cohesive flow throughout the open-plan living areas, enhancing both style and practicality.

The kitchen forms a true centrepiece, combining coastal warmth with contemporary edge. Beautifully finished with Quartz Torino benchtops and matching splashbacks, it is complemented by crisp white tones and timber cabinetry that extends to the ceiling with a refined bulkhead. Quality Franke appliances, including an integrated dishwasher, ensure the

space is as functional as it is visually striking.

Natural light filters through awning windows positioned throughout the home, inviting

The particulars contained herein are supplied for information only and shall not be taken as a representation in any respect on the part of the vendor or its agent. Interested parties should contact the nominated person or office for full and current details.

TYPE: For Sale

INTERNET ID: 121P4855

SALE DETAILS

\$849,000

CONTACT DETAILS

Rebecca Shephard
0413 580 309

fresh coastal breezes while maintaining privacy with streamlined block-out blinds. The open-plan living and dining area connects effortlessly to the alfresco and private rear yard, creating a relaxed indoor-outdoor flow that is ideal for both entertaining and everyday living, all with

minimal upkeep required.

The home offers three well-appointed bedrooms, with built-in wardrobes to the additional bedrooms. The master suite provides a peaceful retreat, complete with a walk-through robe and a beautifully finished ensuite. The main bathroom continues the home's cohesive palette

and includes a deep soaking bath, perfect for unwinding, along with a separate toilet and a cleverly integrated laundry that maximises space without compromising on style.

Comfort has been carefully considered, with Mitsubishi Electric ducted and zoned air conditioning allowing personalised climate control throughout the home. A single remote garage with internal access and additional rear storage adds everyday convenience, while the flat, fully fenced block with quality Colorbond fencing provides privacy, security and ease

of living.

Positioned opposite a peaceful reserve, this home delivers a lifestyle defined by simplicity and quality.

Whether you are seeking a forever home, a refined downsizer, a coastal weekender or a smart investment, this immaculate property offers a complete, move-in-ready opportunity where everything has been thoughtfully completed, simply move in and enjoy.

- Land Area 714.50 square metres
- Bedrooms: 3
- Bathrooms: 2
- Car Parks: 1











Approximate floor area
177 square metres

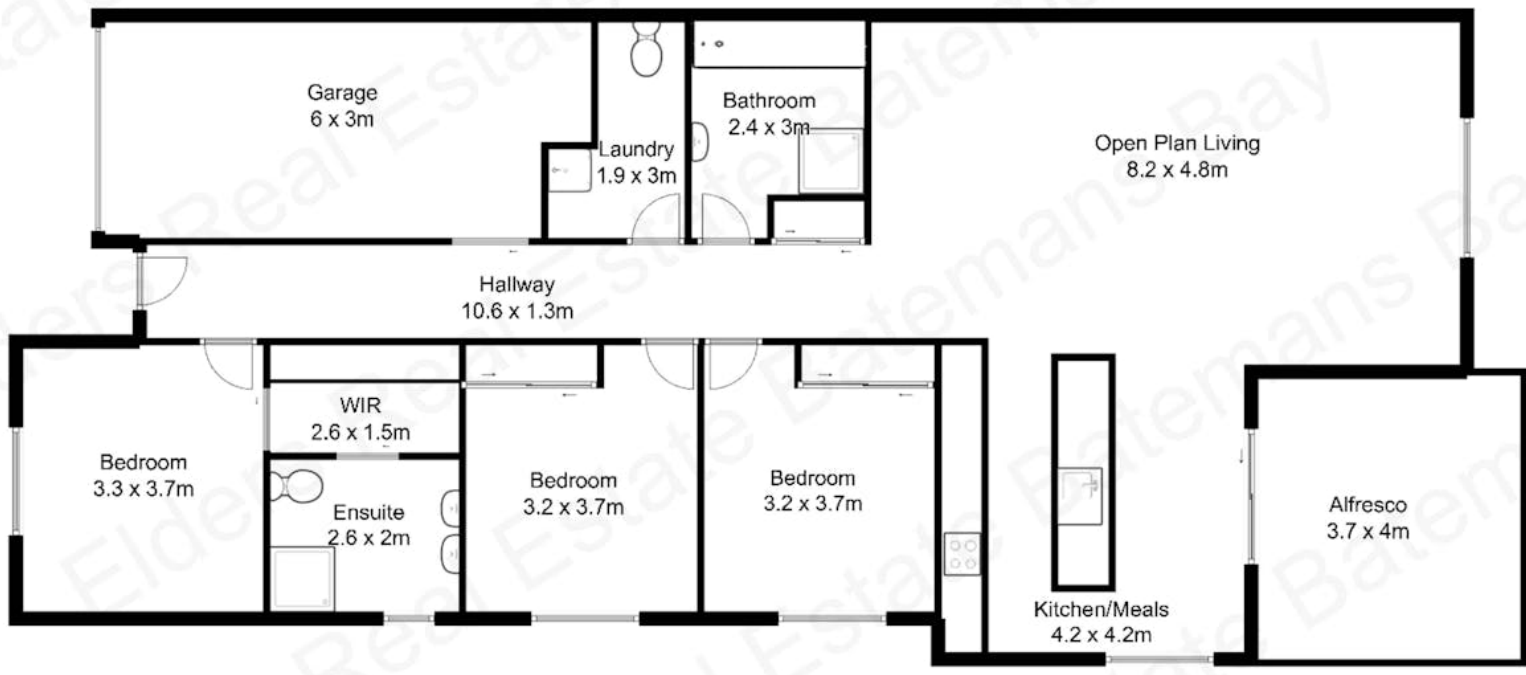

All measurements and boundaries are approximate and are intended as a guide only

