

13 Richardson Road, RAYMOND TERRACE, NSW 2324

A Great Place To Start

This very comfortable two-bedroom home is perfect for people wanting to downsize, get into the property market or secure a solid investment. Raymond Terrace is a convenient and bustling suburb central to Newcastle, Maitland or Port Stephens.

Property Features:

2 spacious bedrooms with a ceiling fan in the main bedroom

Neat and tidy bathroom

Double parking includes garage & carport

Reverse cycle air conditioning for year-round comfort

Study area/ third bedroom

Fully fenced backyard

Prime location close to shops, transport, schools & parks

TYPE: Under Contract

INTERNET ID: 124P2318

SALE DETAILS

PREVIEW

CONTACT DETAILS

Advantage Group – Hunter Valley

Shop 8, Thornton Shopping Centre

Thornton, NSW

(02) 4964 1862

Garry Fairhurst

0414 486 103

Elders Advantage Group has sourced this property information from what we believe to be reliable sources; however, we do not guarantee its accuracy. Prospective buyers are encouraged to conduct their own independent investigations. All photographs, maps and images are for marketing purposes only and are intended to be indicative representations.

Other features: Carpeted, Close to Schools, Close to Shops, Close to Transport

- Land Area 663.90 square metres
- Bedrooms: 2
- Bathrooms: 1
- Single garage
- Single carport

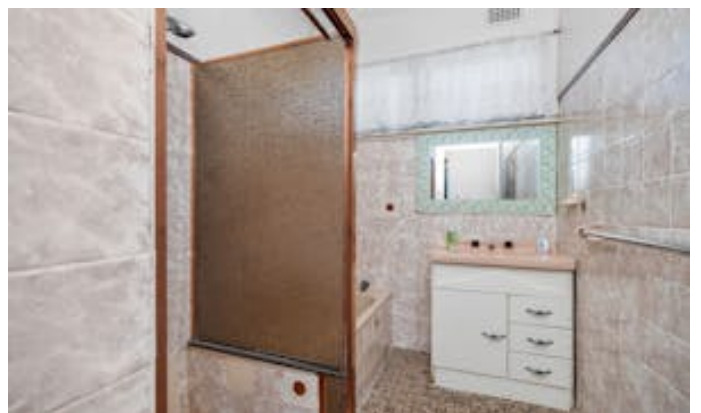



13 Richardson Road, Raymond Terrace

Main Floor Total Interior 86sqm



Site Plan

Back



Front

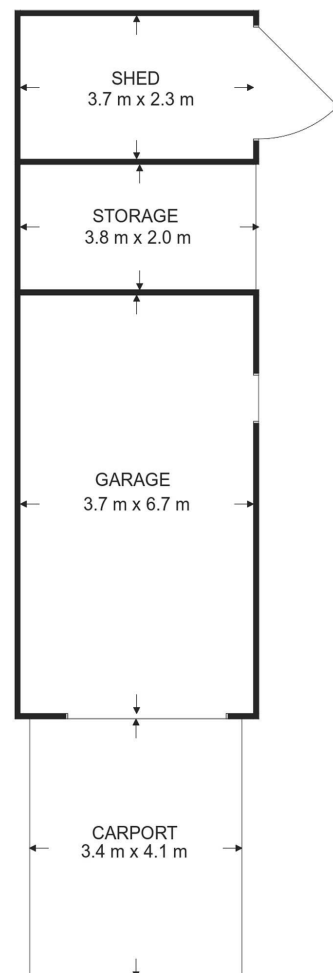
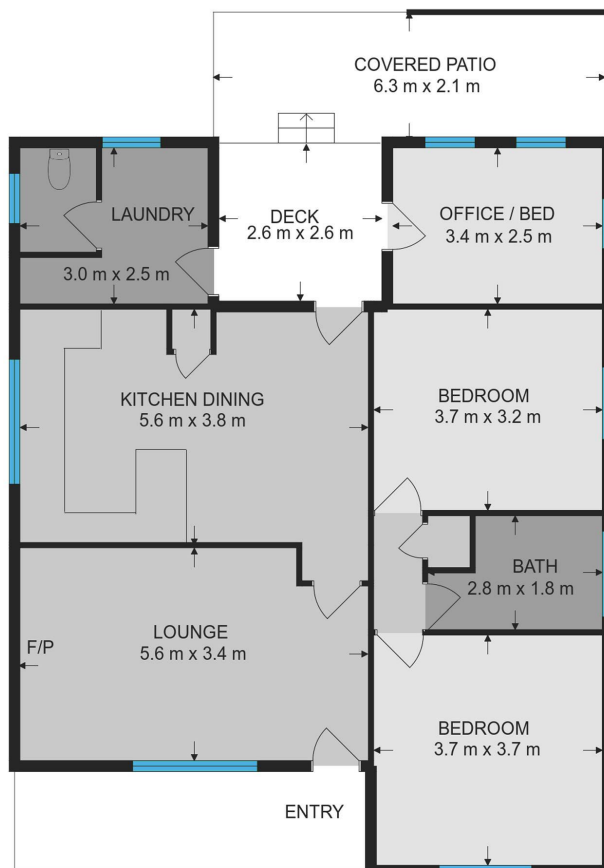

Advantage Group

Measurements are approximate and are to be used only as a guide