



25 Kingsley Avenue, ROMAINE, TAS, AU 7320

QUIET POSITION, VERY WELL PRESENTED

Located in a quiet and sheltered position in popular Romaine stands this very well presented double storey brick home on a 792m² block overlooking the Romaine Reserve green belt, with both Romaine Primary and Parklands High Schools nearby.

Step inside to discover excellent sun filled living areas complimented with air-con, beautiful near new kitchen with great storage space including soft closing drawers, 3 good sized bedrooms all with built-ins, neat bathroom plus single garage and large storage/rumpus downstairs.

The large area of lawn at the rear is well maintained with the opportunity to put your gardening flair to good use or enjoy the chance to grow veggies and plant your favourite fruit trees.

Properties in this price bracket and of this quality are being keenly sought after so don't hesitate to call me for an inspection.

Other features: Built-In Wardrobes, Close to Schools, Close to Shops, Close to Transport, Garden

- Land Area 0.0792 hectares
- Building Area: 125 0.0125 hectares

The particulars contained herein are supplied for information only and shall not be taken as a representation in any respect on the part of the vendor or its agent. Interested parties should contact the nominated person or office for full and current details.

TYPE: Sold

INTERNET ID: 18537695

SALE DETAILS

\$249,000

CONTACT DETAILS

Elders Real Estate Burnie

114 Wilson Street

Burnie, TAS

03 6432 2311

Bruce Jubb

0417 987 828

- Bedrooms: 3
- Bathrooms: 1
- Single garage
- Air Conditioning





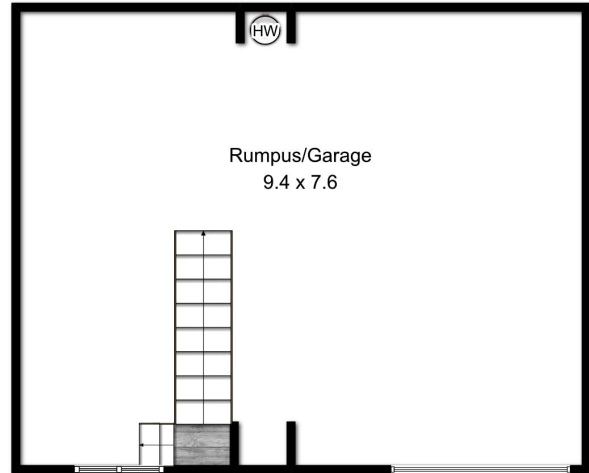

Produced by Open2view.com for Elders Burnie
Fixtures and fittings are for display purposes only.
Not to scale.
This floorplan is a sketch,
and all dimensions stated are approximate.
All room measurements are in metres.
Approx total floor area 188 sq m
Excluding Balcony

