

## 270-272, 250 Ellikers Lane, CAMBRAI, SA 5353

Ellikers Lane - Cambrai - Substantial Cropping & Grazing Land Aggregation

**1,001.40 hectares, 2,474.46 acres**

To be offered as whole or in 3 non-contingent Allotments

As a whole 1001 Ha or 2474.5 Acres over 4 Freehold Titles - The majority of the land is established sandy loam over clay with some limestone ridges.

Lot 1 - "Schroeders" (Sect 270 & 271) and "Wienckes" (Sect. 272) 466Ha or 1151.5 Acres in total, generally flat ground, sandy loam over clay with some limestone. Road frontage on three sides. No Improvements.

Lot 2 - "Ross's" (Sect 267 & 268) 361.8Ha or 894 Acres features comfortable 3 bedroom home and shedding, equipped bore and dam. Established sandy loam over clay and limestone with areas of native scrub for shelter belts.

Lot 3 - "Paynes" (Sect 250) 173.6Ha generally flat ground sandy loam over clay and limestone with frontage to Angas Valley Road and Ellikers Lane.

**TYPE:** Sold

**INTERNET ID:** 22623406

**SALE DETAILS**

Expressions of Interest  
closing 12noon  
11/12/2020

**CONTACT DETAILS**

**Murray Bridge**  
93 Railway Terrace  
TAILEM BEND, SA  
08 8572 8006  
RLA: 62833

**Gavin Clarke**  
0417 859 733

Mixed farming enterprise occupies a total portfolio area of 1001 hectares or 2474.5 acres, the aggregation is presently utilised of productive cropping, sheep breeding and finishing enterprise. It combines broad acre cropping with grazing.

A fantastic opportunity to acquire a portfolio of this scale in the region to add to an existing aggregation.

Expression of Interest Closing Friday 11th December 2020 at 12 Noon

- Land Area 1001.4 hectares
- Bedrooms: 3
- Bathrooms: 1

## HOMESTEAD

Bedrooms	3
Bathrooms	1

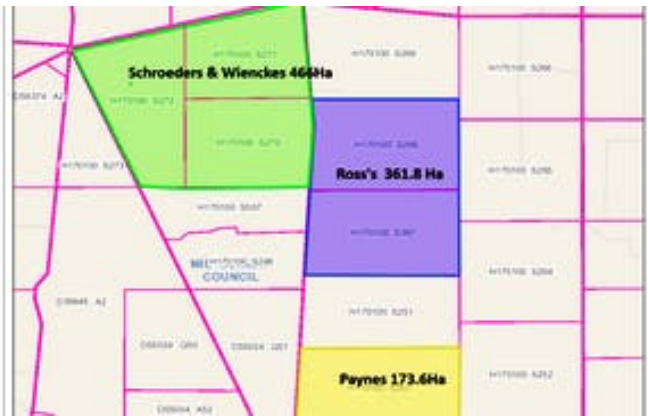







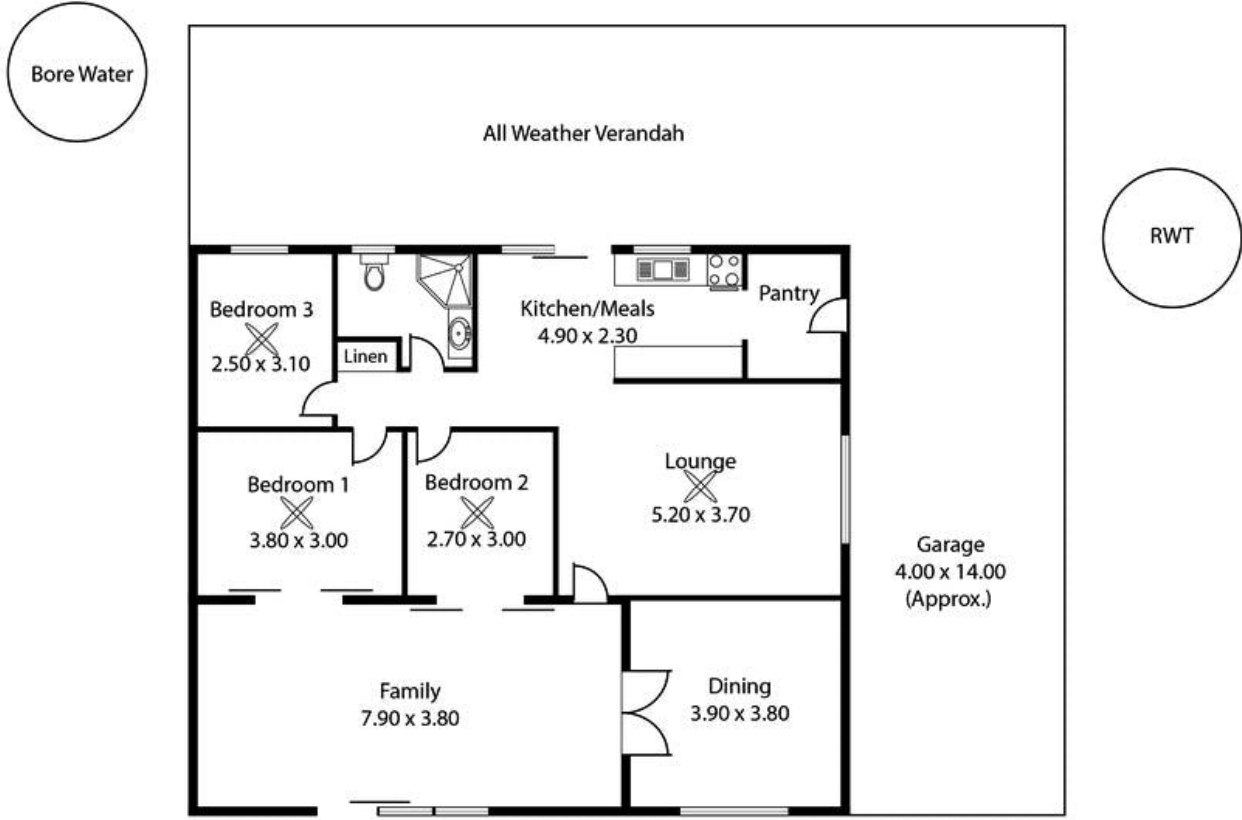

Living:	132.68 sqm ( 1428.2 sq ft)
Verandah:	49.60 sqm ( 533.8 sq ft)
Garage:	56.00 sqm ( 602.8 sq ft)
<b>Total:</b>	<b>238.28 sqm ( 2564.8 sq ft)</b>

This Drawing is for illustration purposes only. All measurements are approximate and details intended to be relied upon should be independently verified.