



8/40 Esplanade , TIN CAN BAY, QLD 4580

BEAUTIFUL BAYSIDE BARGAIN

I would like to present this opportunity to acquire an exceptional unit in a serene complex, ideal for investors or first-time homebuyers seeking a tranquil escape with expansive water views of Tin Can Bay.

This well-appointed unit features two bedrooms, with the master including air conditioning and both offering built-in robes and ceiling fans.

It also comprises a bathroom with a large shower, a combined laundry, and a separate toilet.

The kitchen is equipped with ample storage and a dishwasher, while the open-plan living and dining area includes air conditioning for comfort.

The beautiful patio offers stunning views of the BBQ area, the pool and the beautiful Tin Can Bay Inlet.

Additionally, a dedicated car park is allocated to the unit.

With the option of furnished or unfurnished the potential for holiday letting is supported by an onsite manager, this property represents a significant opportunity.

TYPE: For Sale

INTERNET ID: 22P1627

SALE DETAILS

\$425,000

CONTACT DETAILS

Elders Real Estate Gympie

153 Mary Street

Gympie, QLD

07 5482 6444

Shellie Bennett

#0414 632 960#

I encourage you to schedule an inspection at your earliest convenience to experience this prime location.

Other features: Area Views, Pool, Water Front, Water Views

- Land Area 116.00 square metres
- Bedrooms: 2
- Bathrooms: 1
- Single carport





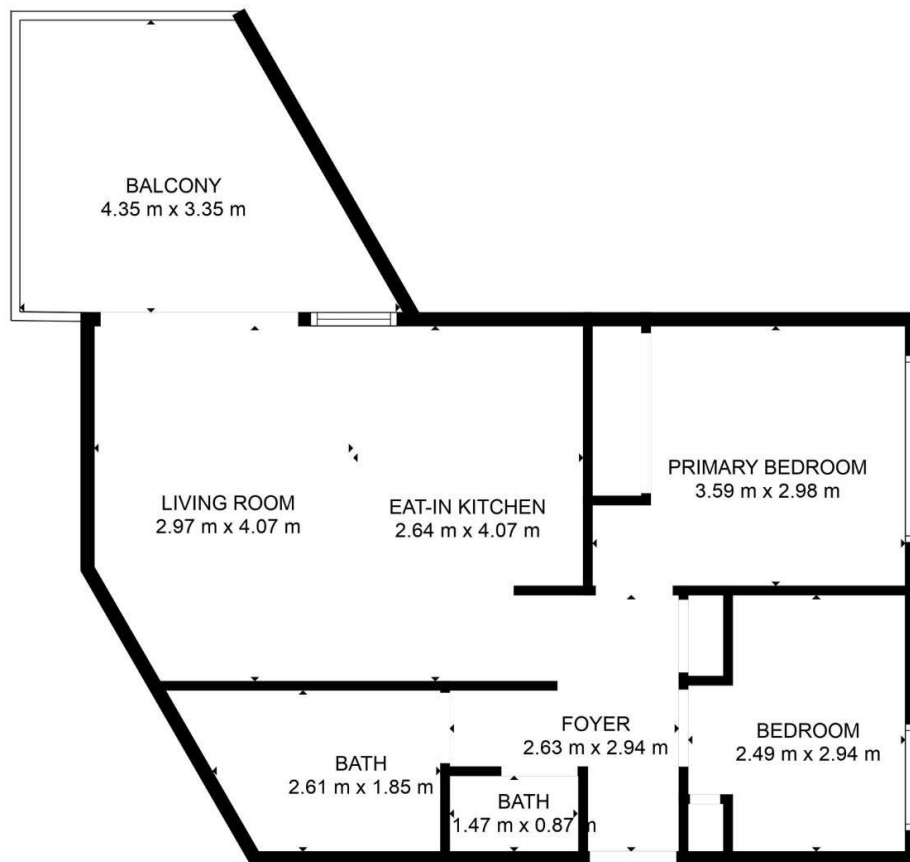

TOTAL: 53 m²
 FLOOR 1: 53 m²
 EXCLUDED AREAS: BALCONY: 11 m², WALLS: 5 m²

FLOOR PLAN CREATED BY CUBICASA APP. MEASUREMENTS DEEMED HIGHLY RELIABLE BUT NOT GUARANTEED.

