



10 Ness Street, GOOLWA BEACH, SA 5214

Endless Summers Await

Set in the heart of sought after Goolwa Beach, 10 Ness Street is the ultimate seachange or holiday escape you've been waiting for. This comfortable and lovely 4 bedroom home is perfectly positioned just a short stroll from the sand and surf and huge reserve, the kind of lifestyle only the coast can offer.

Whether you're catching morning waves, walking the dog along the shoreline or enjoying lazy afternoons with family and friends, this home places you right at the doorstep of all the best Goolwa Beach has to offer.

Step onto the inviting front deck, a lovely spot to enjoy your morning coffee or unwind after a day at the beach. Then head inside where you'll find a functional and welcoming floorplan, with an open plan family and dining area flowing seamlessly into the well-appointed kitchen featuring electric cooking, ample bench space and loads of cupboards to keep everything neatly tucked away.

A separate lounge room sits at the front of the home, bathed in natural light and overlooking the front garden, the perfect space to relax and unwind. S/S reverse cycle heating and cooling provides year-round comfort.

TYPE: For Sale

INTERNET ID: 26P1463

SALE DETAILS

\$710,000 - \$740,000

CONTACT DETAILS

Elders Goolwa

9 Cadell Street

Goolwa, SA

08 8555 3511

RLA: 213003

Lucas Bradley

0438 404 492

4 generously sized bedrooms, each with BIRobes and 3 equipped with ceiling fans and all serviced by the central bathroom along with a separate laundry for everyday ease.

Outside, the property continues to deliver with a drive through carport offering easy access to the rear garage offering a great setup for storing surfboards, bikes and workshop space. Rainwater is also plumbed to the home offering an eco-friendly touch.

All this set on a well maintained allotment with rear lawn and easy care gardens. Whether you're searching for a permanent residence, investment or a coastal family holiday retreat, this home is ready to welcome you in.

- Bedrooms: 4
- Bathrooms: 1
- Car Parks: 4









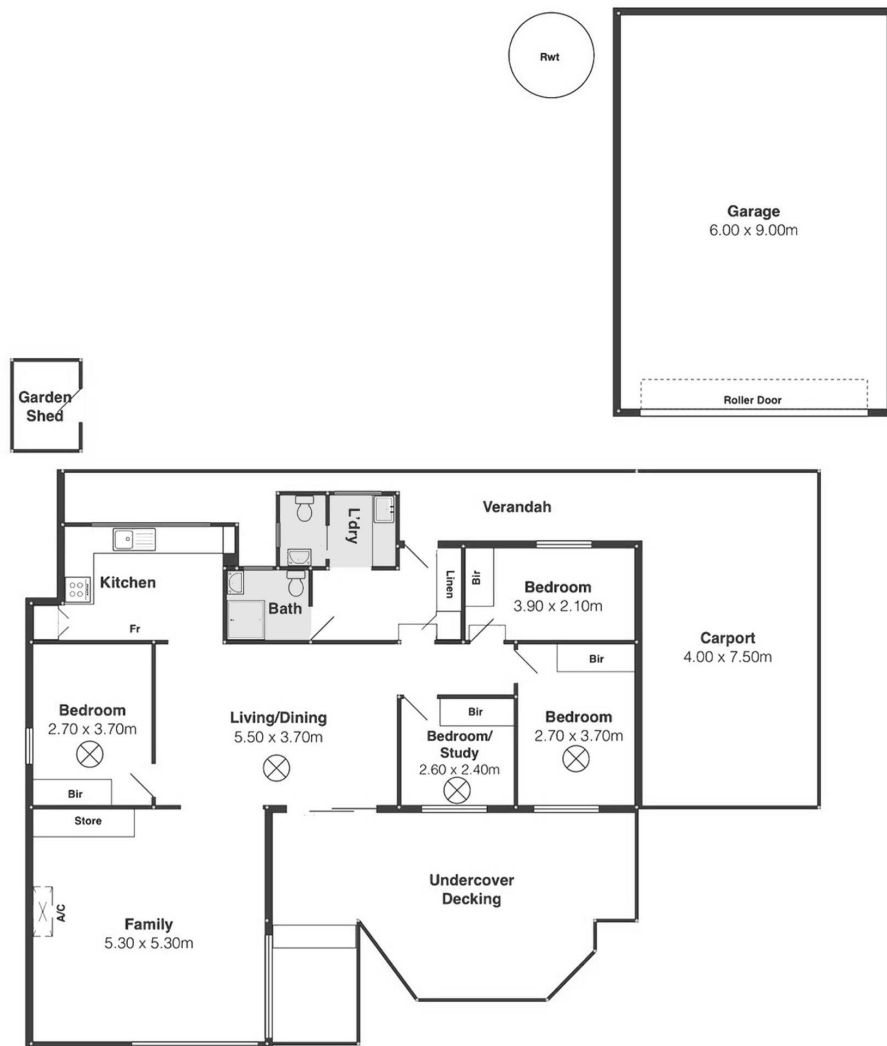

10 Ness St, Goolwa Beach

Scale in metres. This drawing is for illustration purposes only. All measurements are approximate and details intended to be relied upon should be independently verified.



PRODUCED BY
SOUTH COAST STUDIOS