



10 Richards Street, GOOLWA, SA 5214

What a Location!

10 Richards Street, Goolwa, is a neat and comfortable home that would be a great starter, investment, retirement option or holiday getaway. Built in 1977, the home has been well cared for and sits on an allotment of some 632 square metres. It is certainly not a large home, but surprisingly there is plenty of room to move with the addition of a rear sunroom. There is scope for improvements, but everything is in good order, with recent kitchen, bathroom and laundry upgrade. It is ready to go. What you can't deny is the position, it is difficult to be closer to the river, with the Riverview Deli, who do a great coffee, just at the end of the street. A short stroll to Goolwa's Wharf Complex and markets as well as the main street, this is a must see.

Features Include

3 bedrooms - master with robes and fan

Neat bathroom with bath - separate toilet

Front, light filled living area with AC

New kitchen with new appliances

Kitchen / dining area with ceiling fan

TYPE: For Sale

INTERNET ID: 26P1468

SALE DETAILS

\$675,000

CONTACT DETAILS

Elders Goolwa

9 Cadell Street

Goolwa, SA

08 8555 3511

RLA: 213003

Ryan Bridges

0414 379 528

The particulars contained herein are supplied for information only and shall not be taken as a representation in any respect on the part of the vendor or its agent. Interested parties should contact the nominated person or office for full and current details.

Upgraded walk through laundry with linen press

Rear sunroom with AC

Outdoor veranda with good protection from the wind

Immaculate yards with plenty of fruit and veg

Carport and single garage

Additional garden shed

Amazing location - only 150 metres to the Riverview Deli

You wont regret owning a home in this location. The current owners have loved where they live, but its time to move on. Call Ryan Bridges for more information or to arrange a viewing.

- Land Area 632.00 square metres
- Bedrooms: 3
- Bathrooms: 1
- Single garage
- Single carport









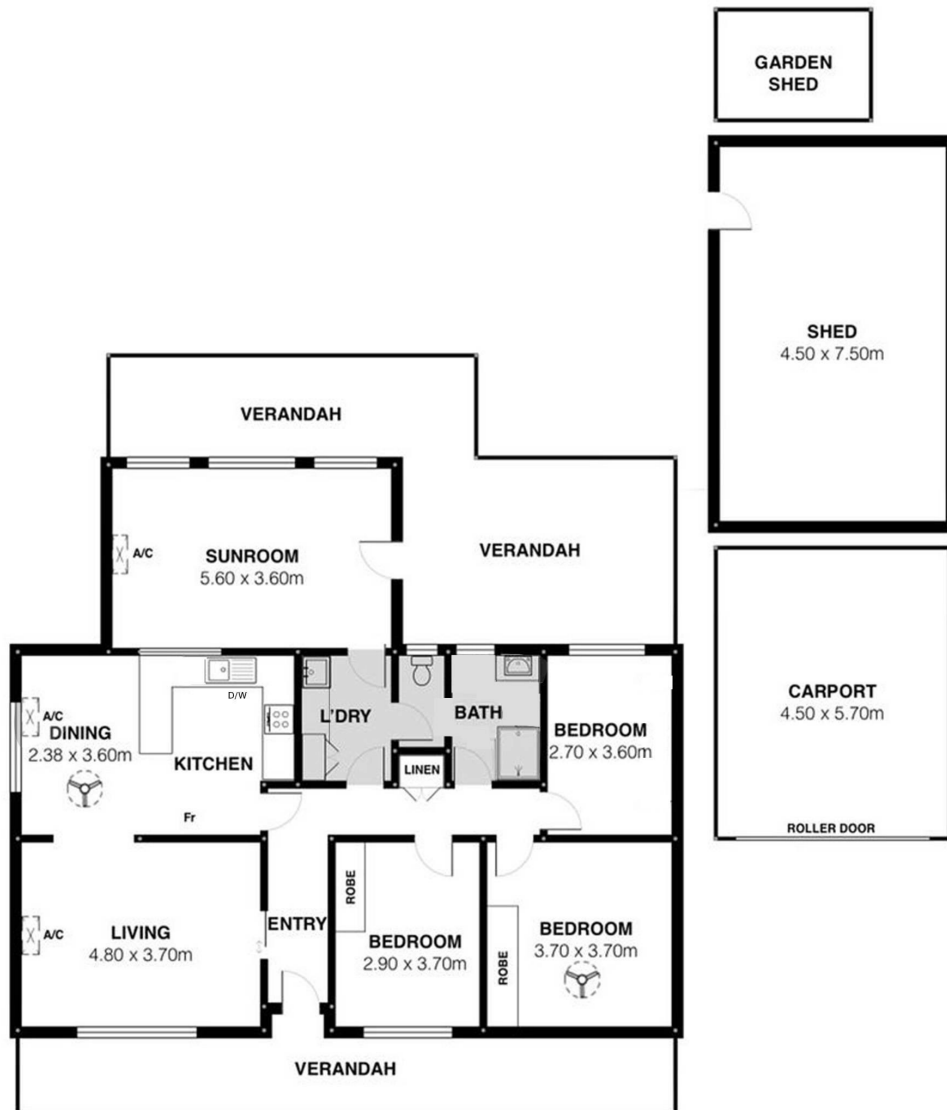

10 Richards St, Goolwa

Scale in metres. This drawing is for illustration purposes only. All measurements are approximate and details intended to be relied upon should be independently verified.



PRODUCED BY
SOUTH COAST STUDIOS