



62 Mundoo Channel Drive, HINDMARSH ISLAND, SA 5214

A Slice of Coorong Paradise

Positioned directly on the saltwater side of Hindmarsh Island and acting as the gateway to the stunning Coorong National Park, this property presents an incredible opportunity to secure the ultimate family holiday retreat, or better yet, enjoy a permanent lifestyle that feels like a getaway every day.

Imagine launching your boat and mooring it on your very own private jetty, ready to cruise down to the Coorong at your leisure. For the keen angler, you don't even need to leave home, simply cast a line straight from your doorstep and reel in your catch of the day. This is waterfront living at its very best.

Inside, the home offers four generously sized bedrooms, the master complete with its own ensuite. The main bathroom features a spa bath and separate toilet, providing comfort for family and guests. A combustion fireplace in the lounge creates a warm and inviting atmosphere during the cooler months, while a split system air conditioner keeps the home comfortable year-round.

The property is equally impressive outdoors. Enjoy summer evenings under the covered entertaining area, the perfect space to host family and friends while soaking in the beautiful vistas and balmy breezes. Excellent shedding of approximately 6m x 5m

The particulars contained herein are supplied for information only and shall not be taken as a representation in any respect on the part of the vendor or its agent. Interested parties should contact the nominated person or office for full and current details.

TYPE: For Sale

INTERNET ID: 26P1487

SALE DETAILS

\$695,000 - \$725,000

CONTACT DETAILS

Elders Goolwa

9 Cadell Street

Goolwa, SA

08 8555 3511

RLA: 213003

Shenae Williams

0408 029 703

offers a great workspace area with the added benefit of a toilet and laundry, while a garden shed provides even more storage options. Approximately 30,000L of rainwater services the home also.

Beyond the features, it's the lifestyle that truly sets this property apart. With the Coorong National Park at your doorstep, opportunities for adventure are endless, from boating, kayaking and paddleboarding or simply taking in the incredible birdlife that calls this wonderful place home. Whether you're looking for a permanent residence, a weekender to gather with family and friends, or a holiday investment, this property delivers versatility, lifestyle and long-term value in one package.

All of this is just a short drive from Goolwa's township, where you'll find shops, caf  s, schools, and everyday conveniences, giving you the best of both worlds: tranquillity on the water, with amenities close at hand.

NB: Please note, this is a Leasehold property under Lease No. 2432687 until 31/12/2060, however there is an option to purchase the lease, contact Agent for further details.

- Bedrooms: 4
- Bathrooms: 2
- Car Parks: 1









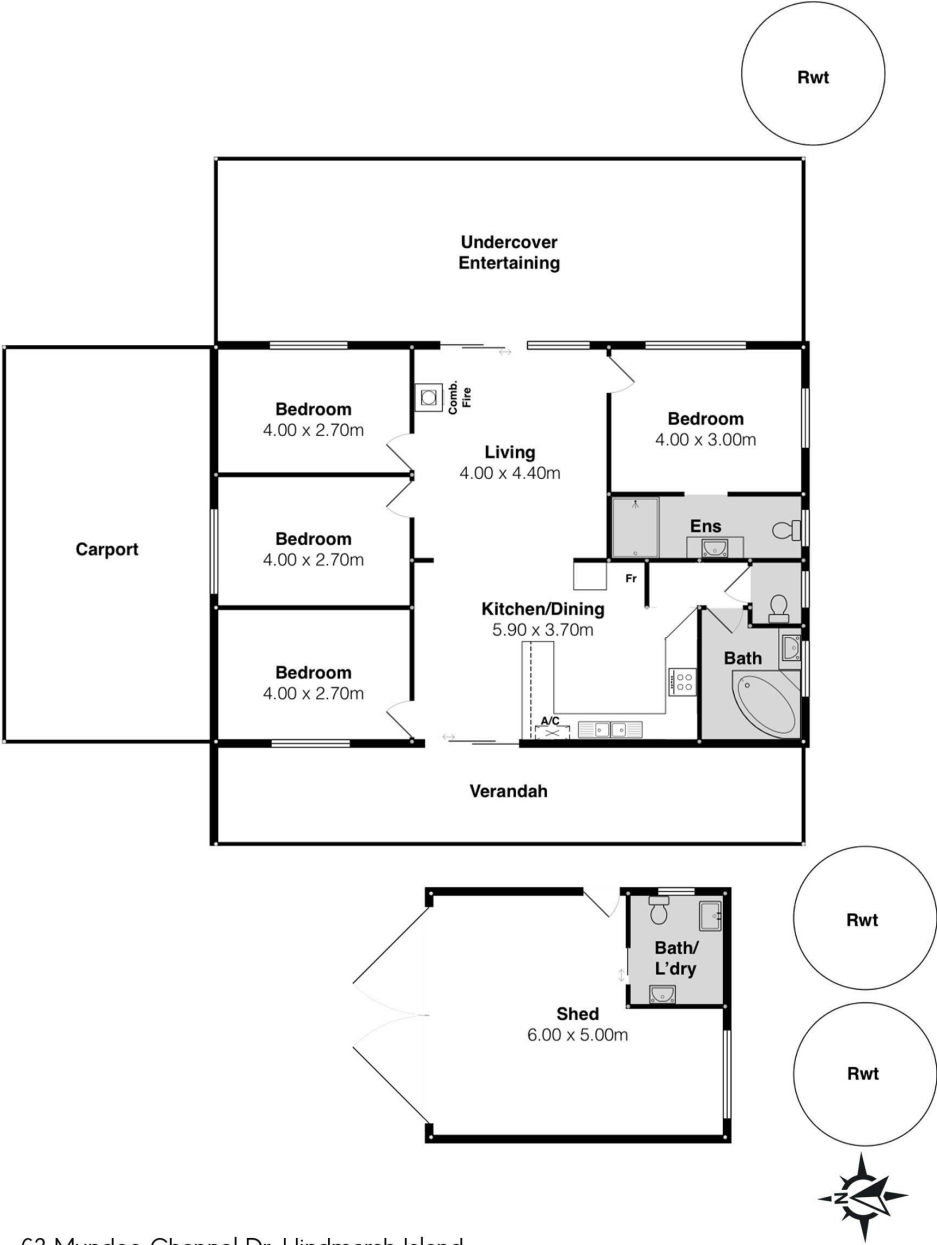

62 Mundoo Channel Dr, Hindmarsh Island

Scale in metres. This drawing is for illustration purposes only. All measurements are approximate and details intended to be relied upon should be independently verified.

PRODUCED BY
SOUTH COAST STUDIOS