



28 Forward Avenue, LOVEDAY, SA 5345

"Family Comfort Meets Country Calm, Where Every Day Feels Like a Getaway"

Welcome to 28 Forward Avenue, Loveday - a private lifestyle haven with a resort-inspired feel and the space to truly unwind.

Set across a generous 2669m², this four-bedroom home is surrounded by established gardens that create a sense of peace and privacy. The open plan living area forms the heart of the home, warmed by a large combustion heater and supported by split systems throughout for year-round comfort.

The newly upgraded bathroom brings a fresh modern touch, while every room enjoys outlooks to the greenery outside.

Outdoors, life slows down. A picture-perfect grass tennis court with LED lighting invites evening matches under the stars, while a two-bay carport and two-bay insulated shed offer ample space for vehicles, hobbies or the ultimate man cave.

Entertaining is effortless under the shady canopy of mature trees, where a spacious alfresco area overlooks neighbouring vineyards - a backdrop that changes with the seasons.

The particulars contained herein are supplied for information only and shall not be taken as a representation in any respect on the part of the vendor or its agent. Interested parties should contact the nominated person or office for full and current details.

TYPE: For Sale

INTERNET ID: 300P162014

SALE DETAILS

\$615,000

CONTACT DETAILS

Elders Riverland

2 East Terrace

LOXTON, SA

8588 6066

RLA: 62833

Karen Nash

0437 236 669

The property is fully fenced, includes 1MEG of CIT water delivery rights and allocation, and offers all the charm of country living just a short drive from Barmera.

Whether it's space for the family, room for recreation, or a quiet place to escape, this Loveday address delivers it all. A true slice of paradise.

Disclaimer: In preparing this information we have used our best endeavours to ensure details contained herein are true and accurate, however we accept no responsibility and disclaim all liability in respect of any errors, omissions or inaccuracies. Prospective purchasers should make their own enquiries to verify the information contained herein.
RLA62833

- Bedrooms: 4
- Bathrooms: 1
- Car Parks: 2





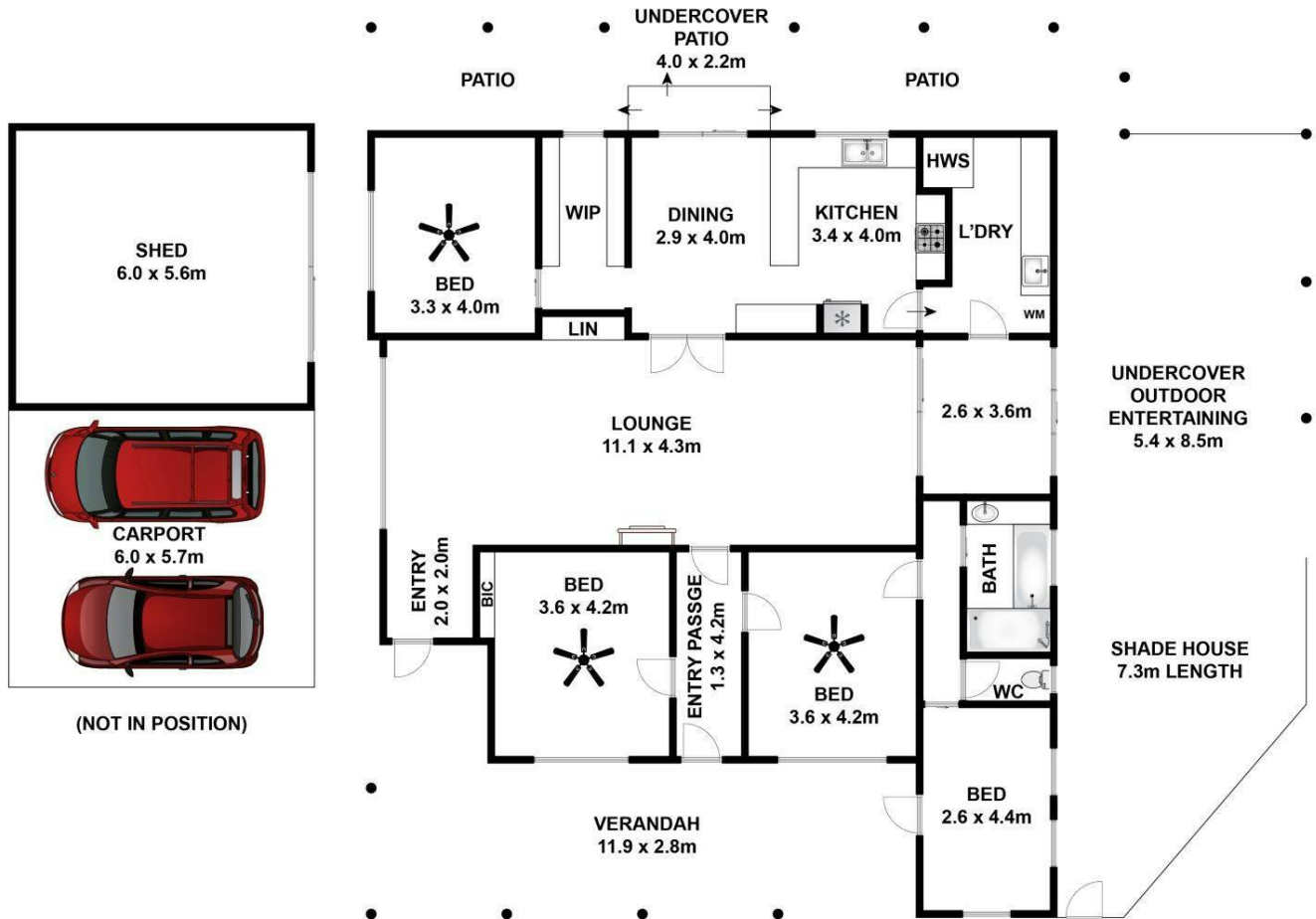

Approx House Area 181m²

Whilst bwrm.com.au has made every attempt to ensure the accuracy of the floor plan contained here, measurements are approximate and no responsibility is taken for any error, omission, or mis-statement. This plan is for illustrative purposes only.

28 Forward Avenue, Loveday

Elders Real Estate