



2/21 George Crescent, FANNIE BAY, NT 0820

LIFESTYLE LOCATION CLOSE TO THE BEACH

- Bright ground-level living/dining area offers spacious open-plan living
- Kitchen with breakfast bar and electric stove
- Large covered entertainer's patio plus in-ground spa to courtyard
- Huge wrap-around courtyard with wide gate access from the street
- Three upstairs bedrooms all with built-in robes; balcony to master
- Second and third bedrooms open onto a shared second balcony
- Bathroom with frameless glass shower and floor-to-ceiling tiles
- Upstairs laundry chute to ground-level laundry off patio access
- Second toilet and built-in linen cupboard to laundry adds convenience
- Single carport plus off-street parking for a second car; external storeroom

Other features: Close to Schools, Close to Shops, Close to Transport, Spa

- Land Area 358.00 square metres
- Bedrooms: 3
- Bathrooms: 1
- Car Parks: 2

TYPE: Sold

INTERNET ID: 300P183074

SALE DETAILS

SOLD

CONTACT DETAILS

Darwin

70 Smith Street

DARWIN, NT

08 8946 0500

Rayna Kirikino

0400 456 484

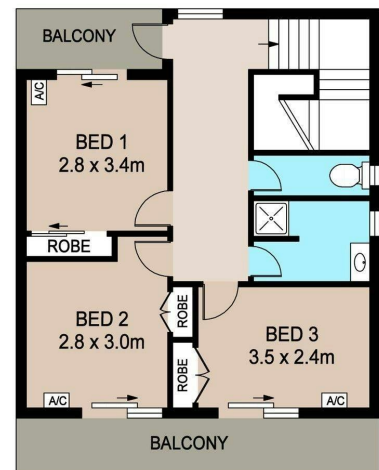

2/21 GEORGE CRESCENT, FANNIE BAY

DISCLAIMER: PLANS SHOWN ARE FOR MARKETING PURPOSES ONLY. ALL DIMENSIONS ARE APPROXIMATE AND NOT TO SCALE. THEY ARE SUBJECT TO ERRORS AND INACCURACIES AND NO LIABILITY WILL BE ACCEPTED. INTERESTED PARTIES SHOULD MAKE THEIR OWN INQUIRES.