



82 Havenside Drive, GARBUTT, QLD 4814

A Modern and Stylish Property with Phenomenal Positioning, 3 Bed 2 Bath, 2 Car, and Media Room.

Welcome to 82 Havenside Drive in the Haven Estate.

Have you been searching for a stylish, inner-city home, or investment property with minimal maintenance required?

82 Havenside Drive is positioned in the heart of the sought-after Haven Estate, and only minutes from the Strand, Townsville CBD, Castle Hill and Walking Tracks, The Townsville Airport, and many more key Townsville locations. A 1min walk from an aquatic center, and only a couple of minutes walk from the new Skate Park just down the road, this property is as convenient as it is comfortable.

Immaculately maintained, this low-set 3 bedroom home offers open plan kitchen-lounge-entertaining while ensuring the bedrooms are both accessible and inviting. The master bed has a walk thru wardrobe into a tastefully designed bathroom with dual basins, and classy tiles in the shower recess. This property really does have it all with 3 bedrooms and a media room to keep competing entertainment needs separated. The media room has also been used as a bedroom by tenants, and could easily double as a 4th bed, providing amazing versatility.

TYPE: For Sale

INTERNET ID: 300P183416

SALE DETAILS

Offers Over \$660,000

CONTACT DETAILS

Stephen Lane
0488022067

This amazing inner-city living property provides 166sqm of space with high ceilings, allowing for cool living spaces, and promoting the aesthetically pleasing design of open plan living.

Key Points:

- Three Bedrooms
- Media Room Doubles as 4th Bedroom
- 2 Car Remote Garage
- Stunning Kitchen with Convenient Pantry
- Open and Sizeable Back Yard
- Council Rates Approx. \$2269 Per Half Year
- Close to Everything - 3km from the CBD, Strand, Schools and Shops
- Master Bedroom with Walk-Thru Robe and Stunning Ensuite
- Fully Fenced

If you have been dreaming of the inner-city lifestyle, this property is ready and waiting for you to make the move.

Currently Tenanted on long term 3 year Lease finishing in 20/01/2026 and managed by the amazing Elders Real Estate Property Management Team. The current tenants are the only people to have ever occupied this nearly 3 year old property since it was built, and the property is in fantastic condition.

To discuss this property, please contact Stephen Lane from Elders Real Estate in Townsville on 0488 022 067

Other features: Close to Schools, Close to Shops, Close to Transport

- Land Area 317.00 square metres
- Building Area: 166.00 square metres
- Bedrooms: 3
- Bathrooms: 2
- Double garage

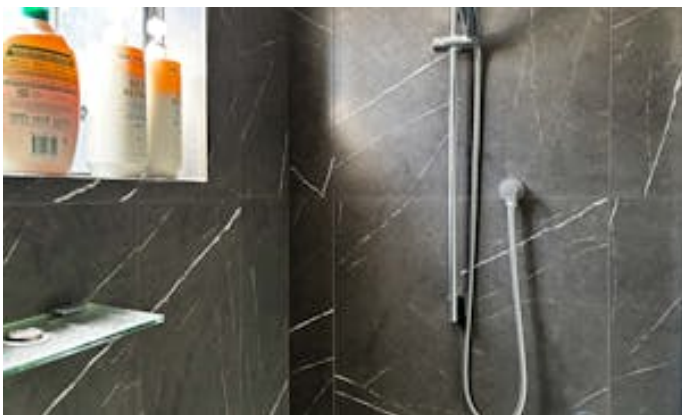



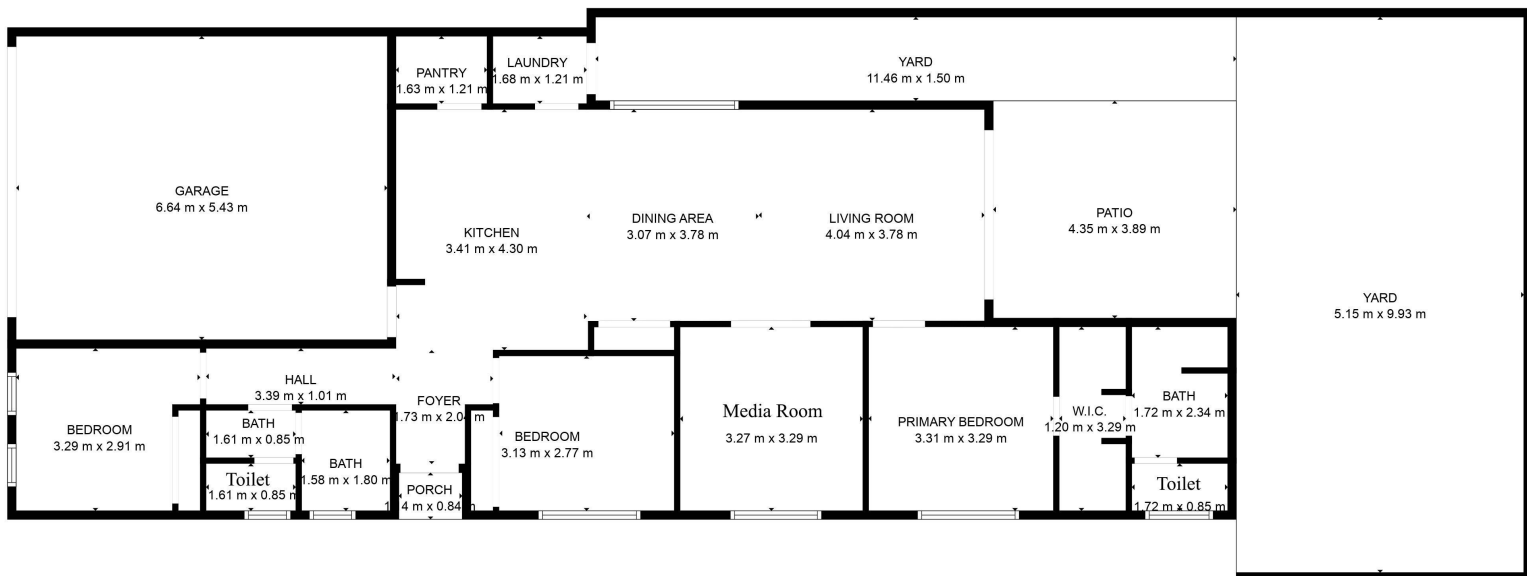

TOTAL: 166 m2
 FLOOR 1: 113 m2
 PATIO: 17 m2, PORCH: 1 m2, GARAGE: 36 m2

FLOOR PLAN CREATED BY CUBICASA APP. MEASUREMENTS DEEMED HIGHLY RELIABLE BUT NOT GUARANTEED.