



70 Flynn Circuit, BELLAMACK, NT 0832

EXECUTIVE ENTERTAINER!

Creating an executive family retreat with premium finishes throughout, this gorgeous four-bedroom home delivers sophisticated everyday living ideal for the keen entertainer.

- ï#- Luxury four-bedroom home situated on leafy fringes of Bellamack
- ï#- Expansive layout elevated by modern appointments and elegant finishes
- ï#- Appealing open-plan living space creates inviting hub of home
- ï#- Designer kitchen boasts sleek stone surfaces and premium appliances
- ï#- Fabulous entertainer's alfresco with outdoor kitchen prep space
- ï#- Manicured yard and sparkling saltwater pool seamlessly extend alfresco
- ï#- Private master features dual built-in robes and luxe ensuite
- ï#- Three further robed bedrooms serviced by sleek main bathroom
- ï#- Additional features inc. internal laundry with storage + extra cabinetry to rear hall, split-system AC

The particulars contained herein are supplied for information only and shall not be taken as a representation in any respect on the part of the vendor or its agent. Interested parties should contact the nominated person or office for full and current details.

TYPE: For Sale

INTERNET ID: 300P184329

SALE DETAILS

PRICE GUIDE
\$875,000

CONTACT DETAILS

Darwin
70 Smith Street
DARWIN, NT
08 8946 0500

Gennie Cox
0411 151 911

i#- 6.49 kW Solar energy system + Solar HWS

i#- Double lockup garage, plus high clearance carport for boat or caravan

i#- Second full-length concrete drive to LHS for extra parking

Contemporary convenience meets elegant sophistication, this home ticks every box for the modern family seeking a higher level of living in a quiet, leafy location moments from central Palmerston.

Revealing a generously proportioned interior, the home welcomes you with an effortless sense of style, while remaining comfortable, inviting and perfectly practical.

At the heart of it all, the beautiful open-plan creates a spacious retreat, where you are introduced to the stunning polished floor tiles, refined neutrals and abundant natural light that seamlessly elevate the entire interior.

Overlooking this space is the gorgeous gourmet kitchen, where keen chefs will appreciate sleek stone work surfaces and high quality appliances, alongside plentiful storage and an oversized waterfall island lit by pendant lighting.

From here, indoor living naturally flows outdoors, where you are greeted by one of the home's standout attractions. As perfect for alfresco family dining as it is for entertaining, the marvellous verandah is somewhere you will love spending time in. Complete with outdoor kitchen prep space and custom feature walls, this alfresco space is framed by manicured lawns and a sparkling saltwater pool within the private backyard.

As for sleep space, the master offers a wonderful haven for parents at the front of the home, complemented by dual built-in robes and a chic ensuite with dual vanity and twin shower. Three further robed bedrooms are serviced by a polished main bathroom with shower, bath and separate WC.

Completing this incredibly appealing package is 6.49 Kw Solar energy system + Solar HWS to help bring down power bills, split-system AC throughout, and an internal laundry with yard access.

There is also a double lockup garage with floor-to-ceiling shelving and internal access, along with a separate 8.0 x 8.0m high clearance carport for the boat or caravan. Double colourbond gates to the front of the home and an additional full-length concrete drive to LHS for extra parking and access to the garden shed.

There is a park with playground a short stroll away, and it's only moments to schools, shops and all major amenities.

Don't miss this magnificent opportunity! Organise your inspection today.

Other features: Close to Schools, Close to Shops, Close to Transport, Exhaust, High Clearance, Pool, Prestige Homes

- Land Area 876.00 square metres
- Building Area: 269.00 square metres
- Bedrooms: 4
- Bathrooms: 2
- Car Parks: 2
- Double garage
- Double carport

The particulars contained herein are supplied for information only and shall not be taken as a representation in any respect on the part of the vendor or its agent. Interested parties should contact the nominated person or office for full and current details.

- Ensuite









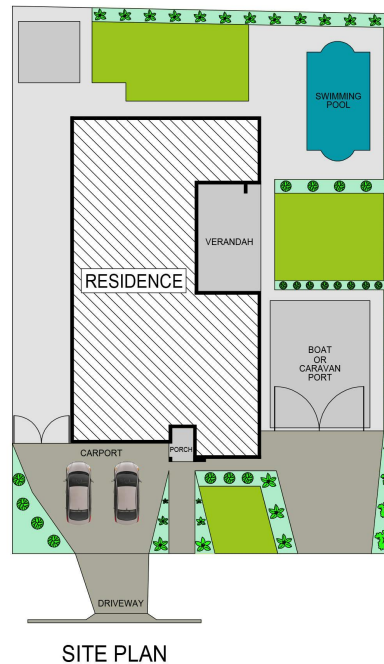

70 FLYNN CIRCUIT, BELLAMACK

DISCLAIMER:

PLANS SHOWN ARE FOR MARKETING PURPOSES ONLY. ALL DIMENSIONS ARE APPROXIMATE AND NOT TO SCALE. THEY ARE SUBJECT TO ERRORS AND INACCURACIES AND NO LIABILITY WILL BE ACCEPTED. INTERESTED PARTIES SHOULD MAKE THEIR OWN INQUIRIES.