



26 Pilchera Bore Road, BORRIKA, SA 5309

Come Home to The Country

Imagine waking up to the sound of birdsong and simple tranquillity, the sun rising over open paddocks, and no nearby neighbours - only space, peace, and the kind of quiet that lets you hear yourself think. This isn't just a home; it's an invitation to a simpler, way of life.

Set on approximately two acres, this one-of-a-kind property was once a country schoolhouse. A slice of Borrika's history. Today, it's been lovingly transformed into a warm and welcoming family home - full of character, charm, and country soul.

Step inside and feel the history in the timber, the sense of purpose in every thoughtfully adapted space.

Downstairs, there are three bedrooms, while upstairs has been cleverly designed to provide a cosy forth loft style bedroom along with a playroom or study offering flexibility for growing families or creative pursuits.

The heart of the home is the spacious open-plan living and dining area, where you'll gather around the slow-combustion fire in winter or keep cool with split-system air conditioning in the heat of summer.

This is a home built to work with the land - running entirely on rainwater, with the convenience of switching to bore water when needed.

The particulars contained herein are supplied for information only and shall not be taken as a representation in any respect on the part of the vendor or its agent. Interested parties should contact the nominated person or office for full and current details.

TYPE: For Sale

INTERNET ID: 300P184912

SALE DETAILS

\$320,000

CONTACT DETAILS

Murray Bridge

93 Railway Terrace

TAILEM BEND, SA

08 8572 8006

RLA: 62833

Ali Bolt

0437 290 698

Gas hot water and the 2.2kW solar system help support sustainable living. Outside, an undercover entertaining area invites long, lazy meals with family and friends overlooking a large lawned area where you can also entertain under the shade of the old gum tree.

And just a few steps away from the main house! Your own little retreat - a modern outback-style retreat with a kitchenette, lounge, split system air conditioning, a private bedroom and ensuite. Whether it's for guests, a teenager's haven, a parents getaway, or potential Airbnb income, the possibilities are endless.

Wander the property and you'll find something for everyone - fruit trees, a basketball court, monkey bars, swings, and even an outdoor bath for moonlit soaks with a chilled glass of wine. Chickens have their own coop, tools their own shed, and there's more than enough space to plant a garden or have a few sheep.

Though this peaceful sanctuary feels a world away, it's just a short country drive to the township of Karoonda, where you'll find the local school, a grocery store, weekend footy, local bowls, or head to the local pub for a meal and a beverage. It's a welcoming community spirit that's hard to find elsewhere.

This is more than a home - it's a lifestyle, a return to what matters, and a rare opportunity to write your own rural story. Whether you're raising a family, starting fresh, or just ready for a slower, more grounded way of life, this is your chance to make the move.

Come home to the country - your new beginning starts here.

Contact Ali Bolt for a personal tour on 0437 290 698. Don't hesitate or you may miss out!

Disclaimer: We have in preparing this information used our best endeavours to ensure that the information contained herein is true and accurate but accept no responsibility and disclaim all liability in respect of any errors, omissions, inaccuracies, or misstatements that may occur. Prospective purchasers should make their own enquiries to verify the information contained herein. Elders Real Estate RLA62833

- Land Area 2 acres
- Bedrooms: 5
- Bathrooms: 2
- Car Parks: 8









26 Pilchera Bore Road,
BORRIKA

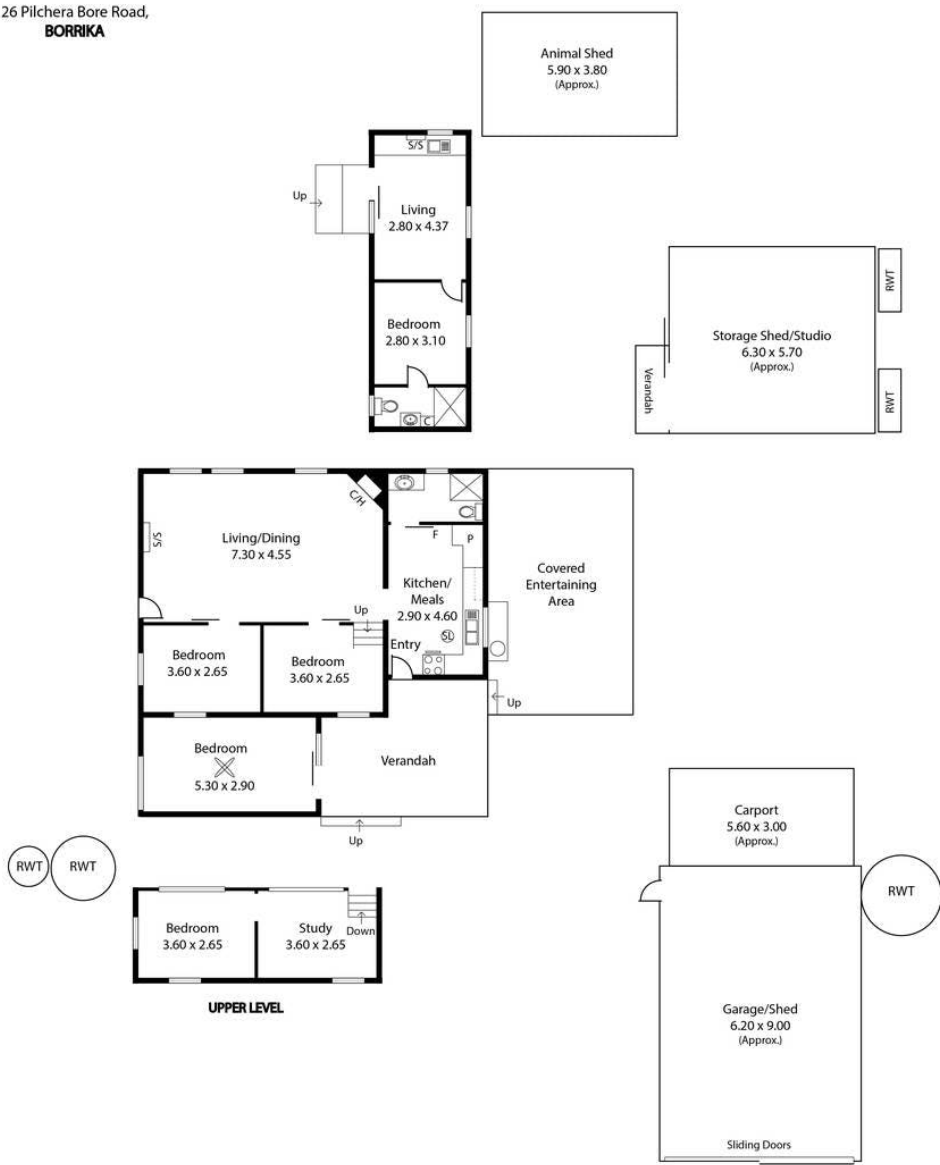

Main House Living:	116.36 sqm
Separate House Living:	29.76 sqm
Verandah:	19.02 sqm
Ent. Area:	34.20 sqm
Carport:	16.80 sqm
Garage:	55.80 sqm
Total:	271.94 sqm

This Drawing is for illustration purposes only.
Not To Scale. All measurements are internal and approximate.
Details intended to be relied upon should be independently verified.
Produced by [Open2view.com](#)