

65 Victoria Drive, GRAY, NT 0830

SPACIOUS & PRACTICAL

Welcome to 65 Victoria Drive â## perfectly positioned just minutes from Palmerston CBD, with local schools, parks, shops, and public transport all close by.

Property Features:

- Air-conditioned throughout for year-round comfort
- Spacious open-plan living and dining area
- Well-appointed kitchen with ample storage
- Internal laundry conveniently located off the kitchen
- Three generous bedrooms
- Central bathroom with bath/shower combo
- Separate toilet for added convenience
- Inground spa for relaxing and entertaining

TYPE: For Rent

INTERNET ID: 300P185627

RENTAL DETAILS

Rent / Lease:

\$600 per week

CONTACT DETAILS

Darwin

70 Smith Street
DARWIN, NT
08 8946 0500

Amy Hamilton
0418 893 403

- Fully fenced front and back yard
- Great-sized backyard with garden shed
- Pets considered on application

Available now!

How to apply? A link will be sent via 2Apply once the property has been inspected.

Elders does NOT accept 1FORM applications. Please leave your details to register for the next available inspection.

Other features: Close to Schools, Close to Shops, Close to Transport

- This property is: Unfurnished
- Pets: No
- Available Now
- Bedrooms: 3
- Bathrooms: 1





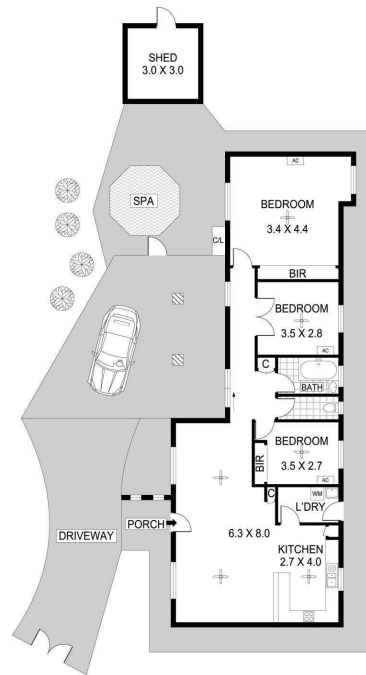

Scale in metres indicative only. Dimensions are approximate. All information contained herein is gathered from sources we believe to be reliable. However we cannot guarantee its accuracy and interested persons should rely on their own enquiries.

65 Victoria Drive, Gray