



## 19 Olympia Crescent, HACKHAM WEST, SA 5163

### Space, Comfort and Location

This bright and spacious 3-bedroom house offers plenty of room for the whole family, with thoughtful features and an unbeatable location.

#### Property Features:

- 3 large bedrooms with built-in robes and ceiling fans for year-round comfort
- Central bathroom with a separate toilet for convenience
- Open-plan kitchen and meals area, perfect for family gatherings
- Separate living room filled with natural light, creating a warm and inviting atmosphere
- Expansive outdoor entertainment area ideal for relaxing or hosting guests
- Fully fenced backyard providing privacy and a safe space for kids and pets
- Established gardens adding charm and curb appeal
- Driveway with off-street parking and ample yard space

**TYPE:** For Rent

**INTERNET ID:** 300P186057

#### RENTAL DETAILS

**Rent / Lease:**

**\$600 p/w**

#### CONTACT DETAILS

**Normanville**

91 Main Road  
Normanville, SA  
08 8598 6100

**Sally Howell**

0409 780 609

- Ducted cooling throughout for a comfortable climate all year

Location Highlights:

- Schools: Walking distance to Hackham West Primary School, and close to Wirreanda Secondary School & Woodcroft College
- Shopping: Minutes from Colonnades Shopping Centre, Southgate Plaza & local convenience stores
- Parks & Recreation: Near Ridgway Reserve, Hackham West Playground & Southern Districts Baseball Club
- Transport: Close to bus routes and the Southern Expressway, making your CBD commute easy
- Beaches & Nature: A short drive to Christies Beach, Port Noarlunga foreshore, and Onkaparinga River trails

Enjoy the perfect blend of comfortable indoor living and spacious outdoor areas in a great community setting.

- This property is: Unfurnished
- Pets: No
- Available on: 16/09/25
- Land Area 778.00 square metres
- Building Area: 141.00 square metres
- Bedrooms: 3
- Bathrooms: 1
- Car Parks: 2
- Single garage
- Single carport













19 Olympia Crescent,  
HACKHAM WEST

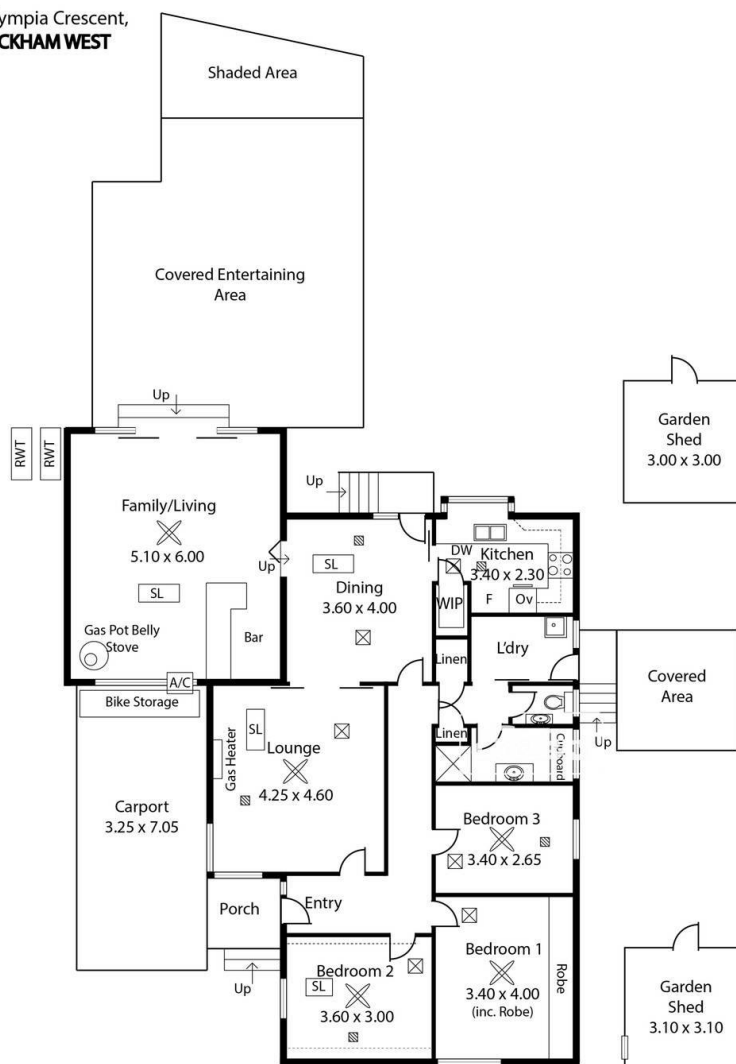

Living: 148.00 sqm  
Porch: 2.70 sqm  
Ent. Area: 50.00 sqm  
Carport: 22.75 sqm  
Total: 223.45 sqm

This Drawing is for illustration purposes only.  
Not To Scale. All measurements are internal and approximate.  
Details intended to be relied upon should be independently verified.  
Produced by [Open2view.com](http://Open2view.com)