



22 Kulde Road, TALEM BEND, SA 5260

Unlock the Potential – A Great Opportunity to Patch, Paint & Prosper

This solid 3-bedroom composite construction home is ready for your personal touch to bring it back to life. Situated on a generous 1,018sqm allotment, this property offers plenty of space both inside and out, perfect for families or those looking to invest and create their dream home.

Featuring a formal lounge and a spacious family room, there's ample room for everyone to relax and entertain. The bathroom has been thoughtfully upgraded and there is a separate toilet for added convenience. Enjoy the bright and versatile sleepout/sunroom – an ideal spot for a home office, hobby room, or casual living area.

Practical features include a carport and a garage, providing secure parking and storage options. Best of all, this home is conveniently located close to all local services, making everyday living easy.

If you're ready to roll up your sleeves and add value, this property offers endless potential in a sought-after location. Don't miss your chance to create something special!

- Approx 1,018sqm allotment

The particulars contained herein are supplied for information only and shall not be taken as a representation in any respect on the part of the vendor or its agent. Interested parties should contact the nominated person or office for full and current details.

TYPE: For Sale

INTERNET ID: 300P186148

SALE DETAILS

**Best Offers by 26th
September USP Guide
\$220,000**

CONTACT DETAILS

Murray Bridge

93 Railway Terrace
TAILEM BEND, SA
08 8572 8006
RLA: 62833

John Robinson

0409 609 457

- 3 Bedroom composite construction home
- Formal lounge and spacious family room
- Upgraded bathroom & separate toilet
- Sleepout/sunroom
- Carport & garage
- Close to all local services

Contact us today to arrange a viewing and explore the possibilities!

Disclaimer: We have in preparing this information used our best endeavours to ensure that the information contained herein is true and accurate but accept no responsibility and disclaim all liability in respect of any errors, omissions, inaccuracies, or misstatements that may occur. Prospective purchasers should make their own enquiries to verify the information contained herein. Elders Real Estate RLA62833

- Land Area 1,018.00 square metre
- Bedrooms: 3
- Bathrooms: 1
- Car Parks: 4







22 Kulde Road,
TAILEM BEND

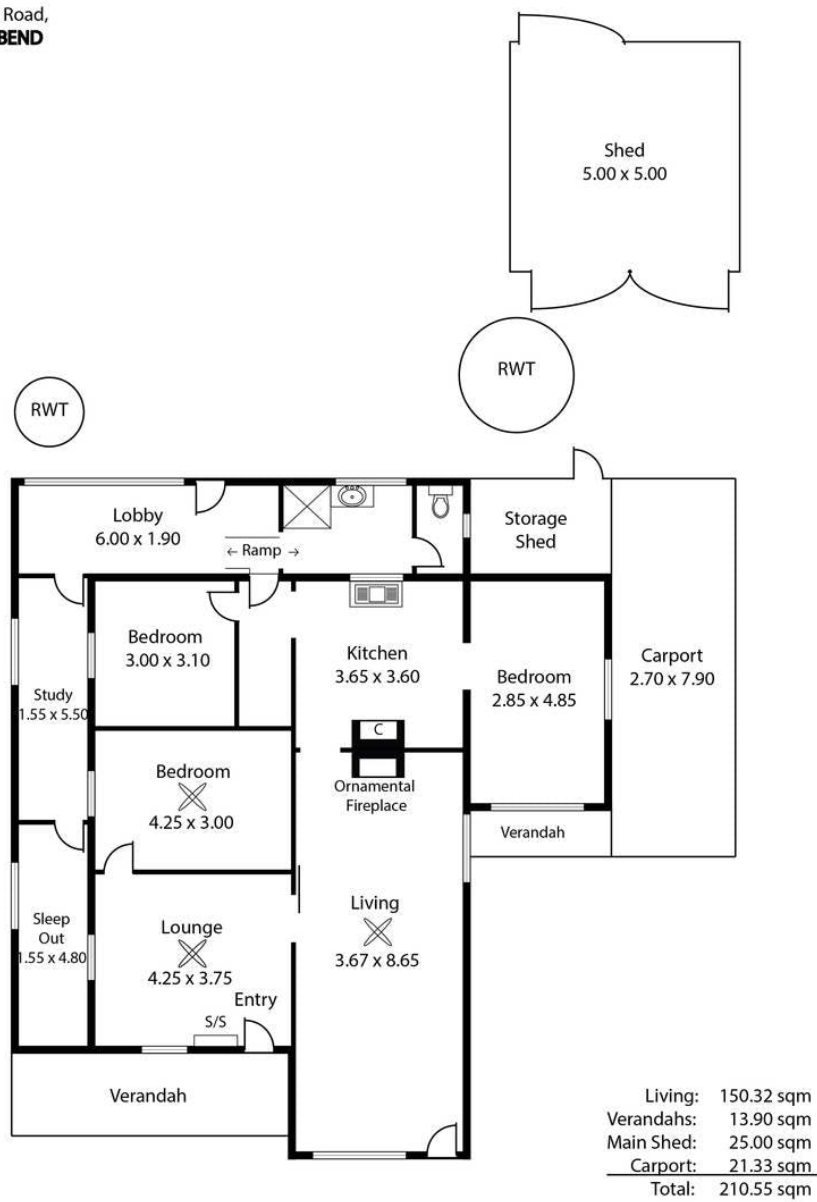

This Drawing is for illustration purposes only.
Not To Scale. All measurements are internal and approximate.
Details intended to be relied upon should be independently verified.
Produced by Open2view.com