



4 Hayward Terrace, LOXTON, SA 5333

Affordable Living in the Heart of Loxton!

Presenting an affordable property option in the Loxton market, ideal for those looking to expand their property portfolio or seeking a low maintenance home close to the Loxton Hospital.

The central hub of the home is the lounge room, a comfortable space with plenty of light year-round and featuring a split system for heating and cooling.

Leading from the lounge is the dining area and kitchen. The kitchen is a comfortable space with storage options and even provides elevated views across to Katarapko Island and beyond.

The sleeping zones consist of 3-bedroom options all serviceable spaces with ceiling fans, and the master is of a generous size.

Outside the property offers a generous yard, a 3.5m x 6m shed and a low maintenance yard perfect for investor types.

TYPE: For Sale

INTERNET ID: 300P186937

SALE DETAILS

\$345,000

CONTACT DETAILS

Elders Riverland

2 East Terrace

LOXTON, SA

8588 6066

RLA: 62833

Raphael Liddle

0405 005 138

Located opposite the Loxton Hospital and a short distance to the CBD of Loxton, schools and more, this affordable and well-cared for home will suit those seeking a low maintenance property on a large residential allotment in a prime location.

The property offers very attractive rental yields. For projected rental returns please contact listing agent Raph Liddle.

Property Particulars:

Date Built 1977

Land Size 911m2

Shed/Garage 3.5m x 6m

Council Rates \$2,100 per annum (Approximately)

Sa Water domestic water

Disclaimer: In preparing this information we have used our best endeavours to ensure details contained herein are true and accurate, however we accept no responsibility and disclaim all liability in respect of any errors, omissions, or inaccuracies. Prospective purchasers should make their own enquiries to verify the information contained herein. RLA62833

- Land Area 911.00 square metres
- Bedrooms: 3
- Bathrooms: 1
- Single garage
- Single carport





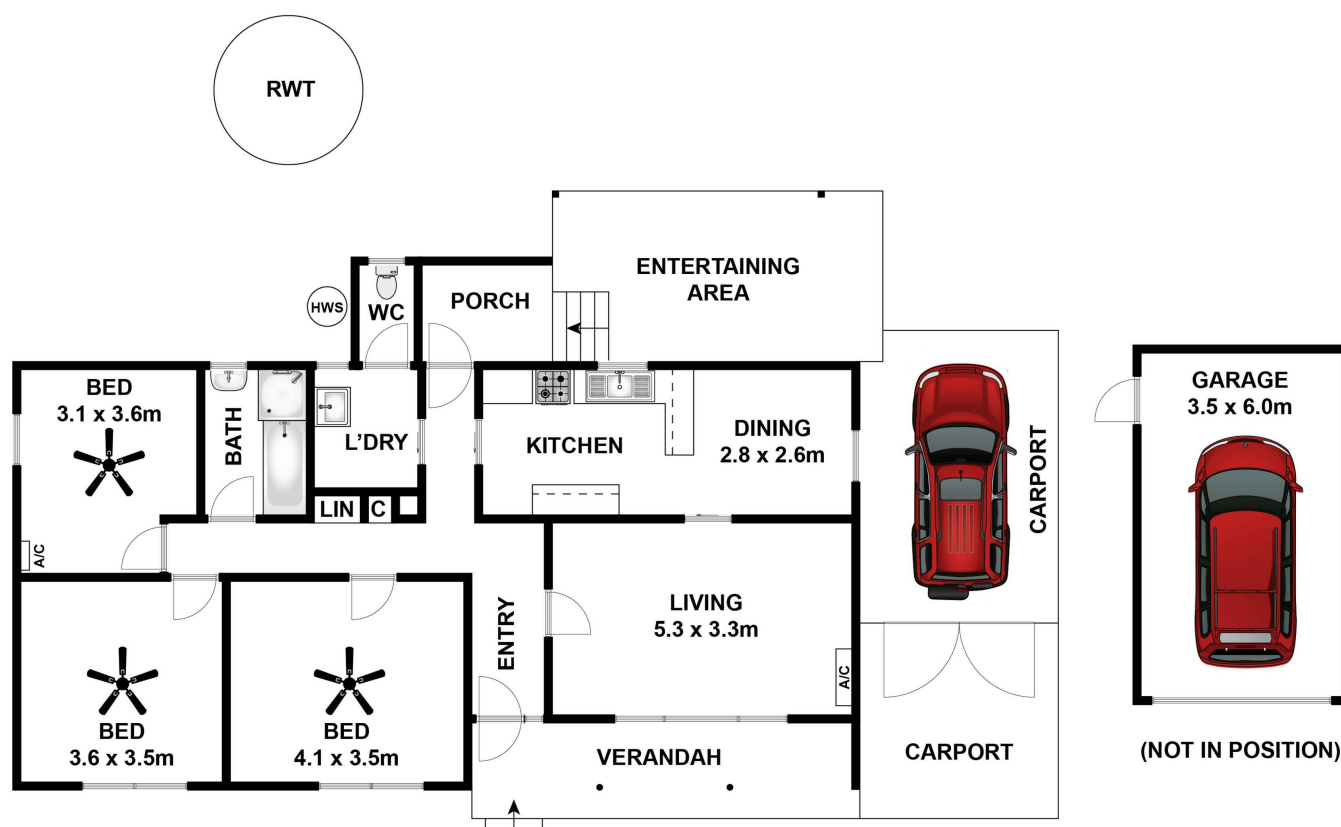

Approx House Area 103m²

Whilst bwrm.com.au has made every attempt to ensure the accuracy of the floor plan contained here, measurements are approximate and no responsibility is taken for any error, omission, or mis-statement. This plan is for illustrative purposes only.



4 Hayward Terrace, Loxton

Elders

Real Estate