



12 Blackmore Court, GUNN, NT 0832

SWEET DREAMS START HERE!

When you step past the wrought iron gateway into the front entrance foyer you know immediately that a new stylish lifestyle awaits you in this tastefully presented modern home.

Nestled amongst beautifully established, irrigated gardens and lawns and flawlessly presented both inside and out this family home is one to have on your 'must inspect' list.

Large, luxurious main bedroom, located on one side of the home, opens out onto a tranquil rear courtyard and features a stunning ensuite bathroom featuring a corner bath, separate shower alcove plus vanity, walk-in wardrobe and separate toilet.

Modern family sized kitchen, designed for a perfect partnership between the chef and the family is the heart of the home. It features a large breakfast bar, double sink, dishwasher, ceramic hot plates, wall oven and space for microwave.

Open plan family and dining area also extends seamlessly through double slide doors out to the private patio and gardens. Perfect for family BBQs, or a quiet time after a dip

The particulars contained herein are supplied for information only and shall not be taken as a representation in any respect on the part of the vendor or its agent. Interested parties should contact the nominated person or office for full and current details.

TYPE: For Sale

INTERNET ID: 300P187060

SALE DETAILS

PRICE GUIDE
\$763,000

CONTACT DETAILS

Darwin
70 Smith Street
DARWIN, NT
08 8946 0500

Sue Cox
0422 131 315

in the sparkling inground pool.

A separate lounge room at the front of the home allows the family to enjoy the space, comfort and peace of not being in each other's way!

The other two bedrooms are along a hallway on opposite side of the home, separated by the family bathroom that also features a separate shower alcove, bath and large vanity.

Other features included sparkling tiled floors, split system air-conditioning, fully enclosed double garage, plus side access gates. Perfect for the boat or trailer and all adding to the allure of this special home.

Situated in one of Palmerston's fully established residential suburbs, with-in minutes to nearby Shopping centres, schools and an easy stroll to nearby Sanctuary Lakes parklands & walking trails that make this peaceful suburb so sought after.

Other features: Close to Schools, Close to Shops, Close to Transport, Exhaust, Openable Windows, Roller Door Access

- Land Area 600.00 square metres
- Building Area: 248.00 square metres
- Bedrooms: 3
- Bathrooms: 2
- Double garage
- Ensuite







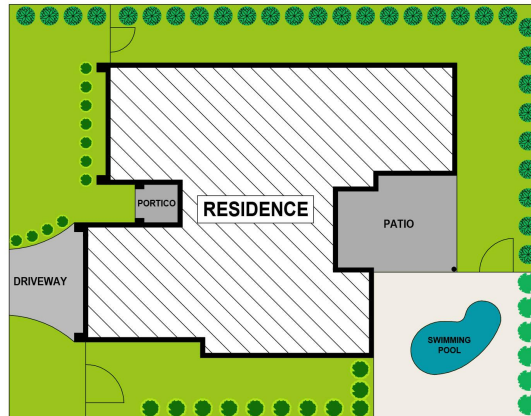

SITE PLAN



12 BLACKMORE COURT, GUNN

DISCLAIMER:
PLANS SHOWN ARE FOR MARKETING PURPOSES ONLY. ALL DIMENSIONS ARE APPROXIMATE AND NOT TO SCALE. THEY ARE SUBJECT TO ERRORS AND INACCURACIES AND NO LIABILITY WILL BE ACCEPTED. INTERESTED PARTIES SHOULD MAKE THEIR OWN INQUIRIES.