

## 2 Bagot Road, ELIZABETH SOUTH, SA 5112

### Modern, Affordable & Low-Maintenance Living

An outstanding opportunity to secure a brand-new home (built in 2024) in the heart of Elizabeth South. Whether you're a first-home buyer, investor, or downsizer, this stylish property offers low-maintenance living at an affordable price point.

#### Property Features:

- 2 spacious bedrooms
- 1 modern bathroom
- 1 secure car space
- Land size: 145m<sup>2</sup> (approx.)
- Year built: 2024
- Property type: House

Set on Allotment 1 in Deposited Plan 133841 (CT 6296/203), this home provides a compact and practical footprint, perfect for easy living or an attractive rental option.

The particulars contained herein are supplied for information only and shall not be taken as a representation in any respect on the part of the vendor or its agent. Interested parties should contact the nominated person or office for full and current details.

**TYPE:** For Sale

**INTERNET ID:** 300P187246

#### SALE DETAILS

**\$490,000 - \$510,000**

#### CONTACT DETAILS

**Barossa**  
127 Murray Street  
Tanunda, SA  
(08) 8562 2883  
RLA: 62833

**Tristan Watt**  
0418 617 287

Why you'll love it:

- Brand new construction – move in with nothing to do
- Affordable entry into the market with strong rental appeal
- Convenient location close to schools, shops, public transport, and Elizabeth Shopping Centre
- Easy-care allotment for a low-maintenance lifestyle

Recent sales in the area highlight this property's strong growth and rental demand – making it an ideal addition to any portfolio or an affordable start for first-home buyers.

Disclaimer:

We have in preparing this information used our best endeavours to ensure that the information contained herein is true and accurate but accept no responsibility and disclaim all liability in respect of any errors, omissions, inaccuracies, or misstatements that may occur. Prospective purchasers should make their own enquiries to verify the information contained herein. Elders Real Estate RLA62833

Other features: Close to Schools, Close to Shops, Close to Transport, Roller Door Access, Toilet Facilities

- Land Area 145.00 square metres
- Building Area: 79.00 square metres
- Bedrooms: 2
- Bathrooms: 2
- Car Parks: 1





2 Bagot Road,  
ELIZABETH SOUTH

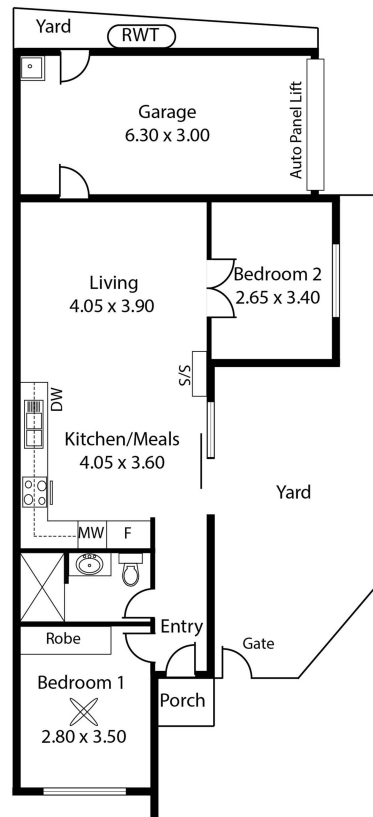

Living: 64.62 sqm  
Porch: 1.20 sqm  
Garage: 20.80 sqm  
Total: 86.62 sqm

This Drawing is for illustration purposes only.  
Not To Scale. All measurements are internal and approximate.  
Details intended to be relied upon should be independently verified.  
Produced by [Open2view.com.au](https://www.open2view.com.au)