



2A Berryman Avenue, MANNUM, SA 5238

Prime Location, Big Potential – Renovate, Invest or Hold

Positioned in a superbly convenient location, this raised timber frame home presents an exciting opportunity for renovators with the vision to invest keep, make it your own or 'flip'.

The home features three good-sized bedrooms - main bedroom with ensuite, plus a central bathroom complete with both shower and bath. An open-plan kitchen, dining, and living area provides a functional layout ready for transformation.

Outside, you'll find ample parking, a small shed, and generous under-house storage, adding practicality and versatility.

Ideally located just a short drive to the main precinct, the property sits close to everything you need - OTR service station, medical centre, IGA supermarket, Mannum Golf Course, day care, kindergarten, and school all nearby.

A fantastic chance to secure a property with strong potential in a highly sought-after area - opportunities like this don't last long.

TYPE: For Sale

INTERNET ID: 300P189143

SALE DETAILS

\$400,000

CONTACT DETAILS

Murray Bridge

201A Adelaide Road

Murray Bridge, SA

08 8531 9200

RLA: 62833

Ali Bolt

0437 290 698

For more information or for a FREE market appraisal of your property, please contact Ali Bolt on 0437 290 698.

CT - Volume 5846 Folio 118

Council - Mid Murray

Council Rates - TBA

Zoning - Established Neighbourhood - EN

Disclaimer:

We have in preparing this information used our best endeavours to ensure that the information contained herein is true and accurate but accept no responsibility and disclaim all liability in respect of any errors, omissions, inaccuracies, or misstatements that may occur. Prospective purchasers should make their own enquiries to verify the information contained herein. Elders Real Estate RLA62833

- Bedrooms: 3
- Bathrooms: 1
- Car Parks: 4









2A Berryman Avenue,
MANNUM

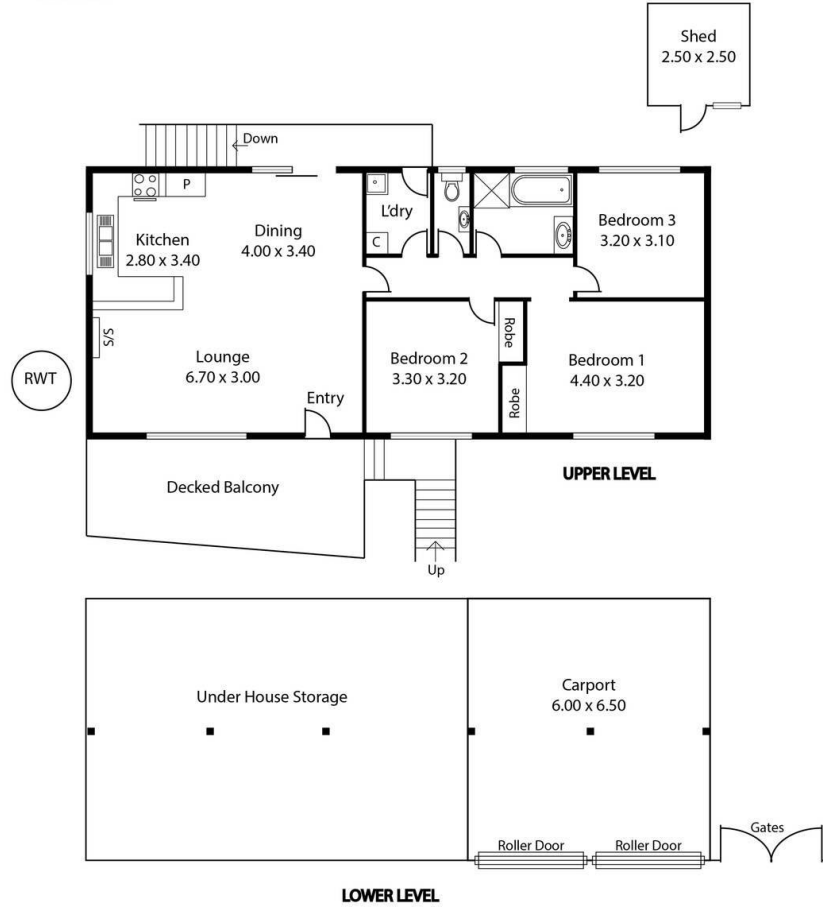

Living:	106.08 sqm
Balcony:	18.55 sqm
Carport:	39.00 sqm
Total:	163.63 sqm

This Drawing is for illustration purposes only.
Not To Scale. All measurements are internal and approximate.
Details intended to be relied upon should be independently verified.

Produced by Open2view.com