



## 41 Shiffner Street, VIOLET TOWN, VIC 3669

### Premiere 2 Bedroom Modern Unit – First Time Offering – Front Position

Now released to the sale market for the very first time, this stylish and contemporary two bedroom unit enjoys a sought-after front position, capturing pleasant outlooks toward the adjoining country reserve.

Designed and constructed using thermally efficient tilt-panel construction, the home delivers enhanced durability, reduced energy costs, and year-round comfort.

Step inside to a spacious open-plan layout that seamlessly combines the kitchen, meals, and generous lounge area—an inviting space perfect for everyday living or relaxed entertaining. The modern, quality kitchen features an electric oven, ceramic cooktop, island preparation bench with built-in storage drawers, and a handy corner nook ideal for a study spot or extra storage.

Fresh new carpets have been installed throughout, and both bedrooms are well-sized with built-in robes and peaceful views to the private courtyard. Climate comfort is assured with split-system reverse-cycle air-conditioning.

A standout feature is the large 6m x 6m under-roof carport, providing excellent access,

The particulars contained herein are supplied for information only and shall not be taken as a representation in any respect on the part of the vendor or its agent. Interested parties should contact the nominated person or office for full and current details.

**TYPE:** For Sale

**INTERNET ID:** 300P189611

#### SALE DETAILS

**\$420,000**

#### CONTACT DETAILS

**Euroa**

27 Binney Street  
EUROA, VIC  
03 5795 2294

**Brendan Allen**  
0499 229 007

off-street parking, and versatile space for outdoor entertaining. The easy-care yard, low-energy heat-pump hot water system, and NBN connection further enhance everyday practicality.

Positioned in a well-maintained complex of just six units, this home combines modern low-maintenance living, and lifestyle convenience. It presents an ideal opportunity for first-home buyers, downsizers, or astute investors seeking quality, comfort, and long-term value. Property available for short settlement.

- Bedrooms: 2
- Bathrooms: 1
- Double carport







## Unit 1, 41 Shiffner Street, Violet Town

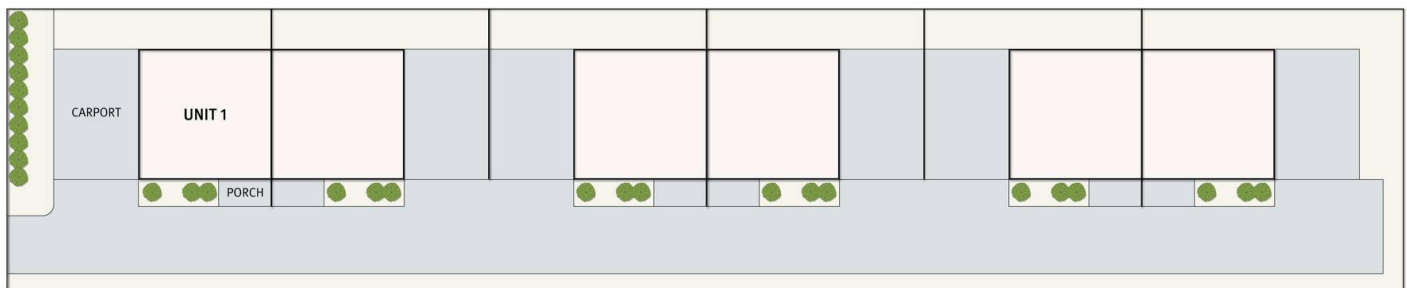
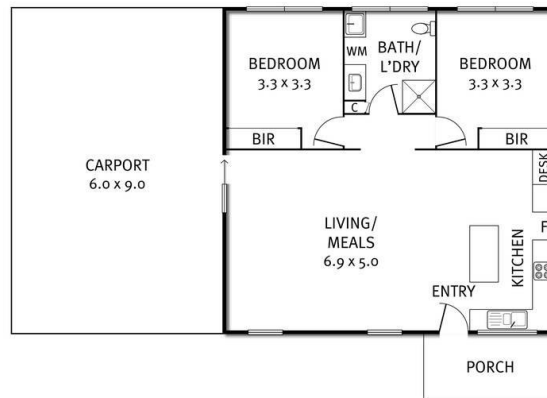

THE ABOVE PLAN IS AN ARTIST'S IMPRESSION ONLY, IT INCLUDES ELEMENTS THAT ARE FOR DISPLAY PURPOSES ONLY AND MAY NOT BE TO SCALE.  
LANDSCAPING SHOWN IS INDICATIVE ONLY. DIMENSIONS ARE APPROXIMATE.