



108 Pike Creek Road, LYRUP, SA 5343

Executive Waterfront living – Productive Almond Operation

Set across 19.5 hectares with approximately 330 meters of Pike Creek frontage, this immaculately presented horticultural holding offers a rare blend of productive capability and Waterfront lifestyle.

The 14.5 hectare Almond orchard is in peak production with highly sought after varieties such as Non Pareil, Carmel, Peerless and Independence. The Riverland region is widely regarded as one of Australia's premier irrigated horticultural areas, supported by fertile soils, a favorable climate, reliable water security, modern delivery systems, crop diversity and excellent access to domestic and export markets via major freight routes.

At the heart of the property is an expansive Mount Gambier stone residence. With a total roof area of approximately 420 sqm, the home features wrap-around verandahs and is thoughtfully oriented to capture uninterrupted views across Pike Creek. This outstanding executive home comprises Four generous bedrooms, Office, Family and Dining, Formal lounge, Alby Turnerâ##built kitchen, Spacious laundry, Main bathroom and ensuite and Double garage under main roof.

Surrounded by established gardens, fruit orchard and vegetable patch, the home offers

The particulars contained herein are supplied for information only and shall not be taken as a representation in any respect on the part of the vendor or its agent. Interested parties should contact the nominated person or office for full and current details.

TYPE: For Sale

INTERNET ID: 300P190315

SALE DETAILS

**Expressions of Interest
closing 16th Feb 2026**

CONTACT DETAILS

Elders Riverland
2 East Terrace
LOXTON, SA
8588 6066
RLA: 62833

David Kanizay
0408 834 586

comfort, privacy and a strong connection to its natural setting.

Infrastructure is extensive and well suited to both commercial horticultural operations and personal use, including 18.6m x 12.8m packing shed, 31m x 8.6m storage shed, Workers Accommodation, 31m x 6.4m implement shed, Chemical shed, Storage shed and pump shed.

Pike Creek is a quiet, sheltered waterway ideal for canoeing, fishing, skiing or simply unwinding with family and friends on warm, sunny days. Suited to owner-operators, investors or those seeking a premium Riverland property.

Expressions of Interest close 5pm 16th February 2026. For more information or to arrange your private inspection contact Dave Kanizay or Karen Nash today

Disclaimer: In preparing this information we have used our best endeavours to ensure details contained herein are true and accurate, however we accept no responsibility and disclaim all liability in respect of any errors, omissions, or inaccuracies. Prospective purchasers should make their own enquiries to verify the information contained herein.
RLA62833

Other features: 3 Phase Power, Area Views, Openable Windows, Prestige Homes, River Views, Water Front

- Land Area 19.5 hectares
- Building Area: 330.00 square metres
- Bedrooms: 5
- Bathrooms: 2
- Car Parks: 20
- Double garage
- Ensuite









The particulars contained herein are supplied for information only and shall not be taken as a representation in any respect on the part of the vendor or its agent. Interested parties should contact the nominated person or office for full and current details.

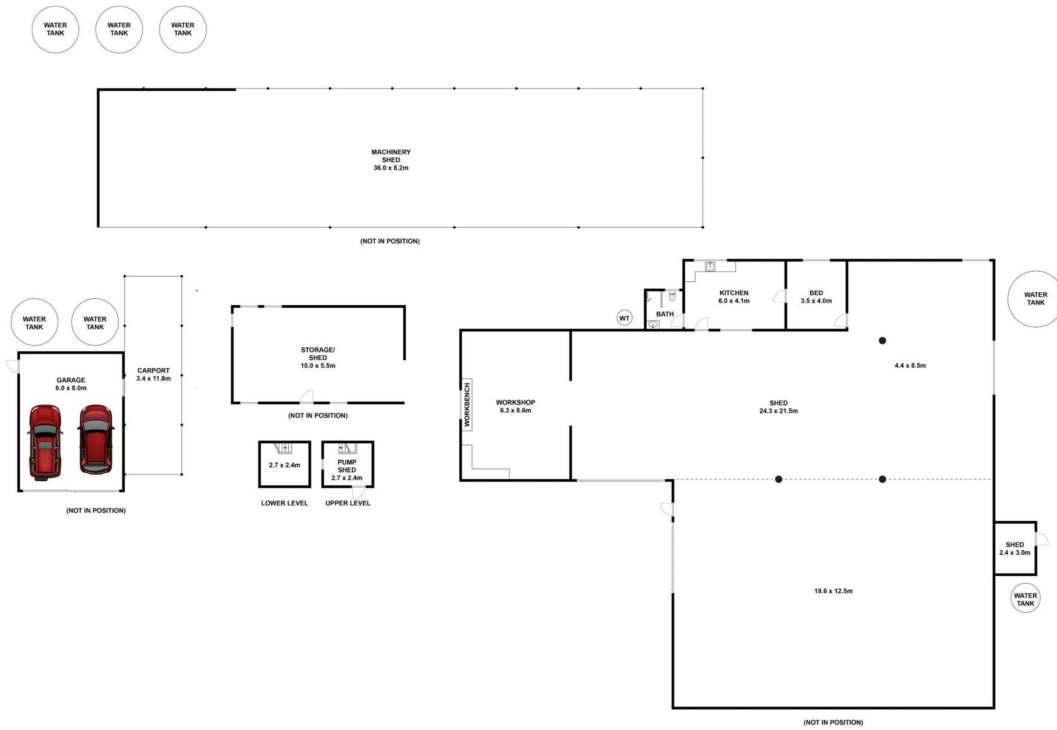

Approx House Area 330m²

Whilst bwrm.com.au has made every attempt to ensure the accuracy of the floor plan contained here, measurements are approximate and no responsibility is taken for any error, omission, or mis-statement. This plan is for illustrative purposes only.

108 Pike Creek Road, Lyrup

Elders Real Estate