



## 6 Aldenhoven Street, BERRI, SA 5343

### Comfort, Convenience & Affordability!

Presenting this recently upgraded home offering an appealing combination of affordability, comfort, and practical living.

At the front of the home, a light-filled lounge room provides flexibility and may also be utilised as a more formal dining space. The refreshed kitchen has been thoughtfully upgraded and features generous storage, a practical layout ideal for everyday living, and a built-in breakfast bar for casual meals.

Accommodation comprises three comfortable bedrooms, all equipped with ceiling fans. A substantial living area positioned at the rear of the floor plan creates an ideal space for relaxed day-to-day living and family gatherings.

The garage provides access through to a workshop space, with an adjoining home office-perfect for those requiring a dedicated workspace away from the main living areas.

Outdoors, the expansive entertaining area overlooks the in-ground swimming pool, offering a welcoming setting for family enjoyment throughout the warmer months.

**TYPE:** For Sale

**INTERNET ID:** 300P190753

#### **SALE DETAILS**

**\$420,000**

#### **CONTACT DETAILS**

**Elders Riverland**

2 East Terrace  
LOXTON, SA  
8588 6066  
RLA: 62833

**Raphael Liddle**

0405 005 138

Ideally positioned on Aldenhoven Street and surrounded by quality residential homes, this property is conveniently located just a short drive from the town centre, schools, and local amenities, delivering an exceptional lifestyle of ease and accessibility.

Property Particulars:

Land Size 1,122m<sup>2</sup>

Date Built 1964

Council Rates \$2,300 p/a approximately

Solar System

Outdoor entertaining

In ground swimming pool - salt

Carport

Garage

Split system heating and cooling

Ducted Evaporative air-conditioning

Disclaimer: In preparing this information we have used our best endeavours to ensure details contained herein are true and accurate, however we accept no responsibility and disclaim all liability in respect of any errors, omissions, or inaccuracies. Prospective purchasers should make their own enquiries to verify the information contained herein.  
RLA62833

- Land Area 1,122.00 square metre
- Bedrooms: 3
- Bathrooms: 2
- Car Parks: 2
- Double garage







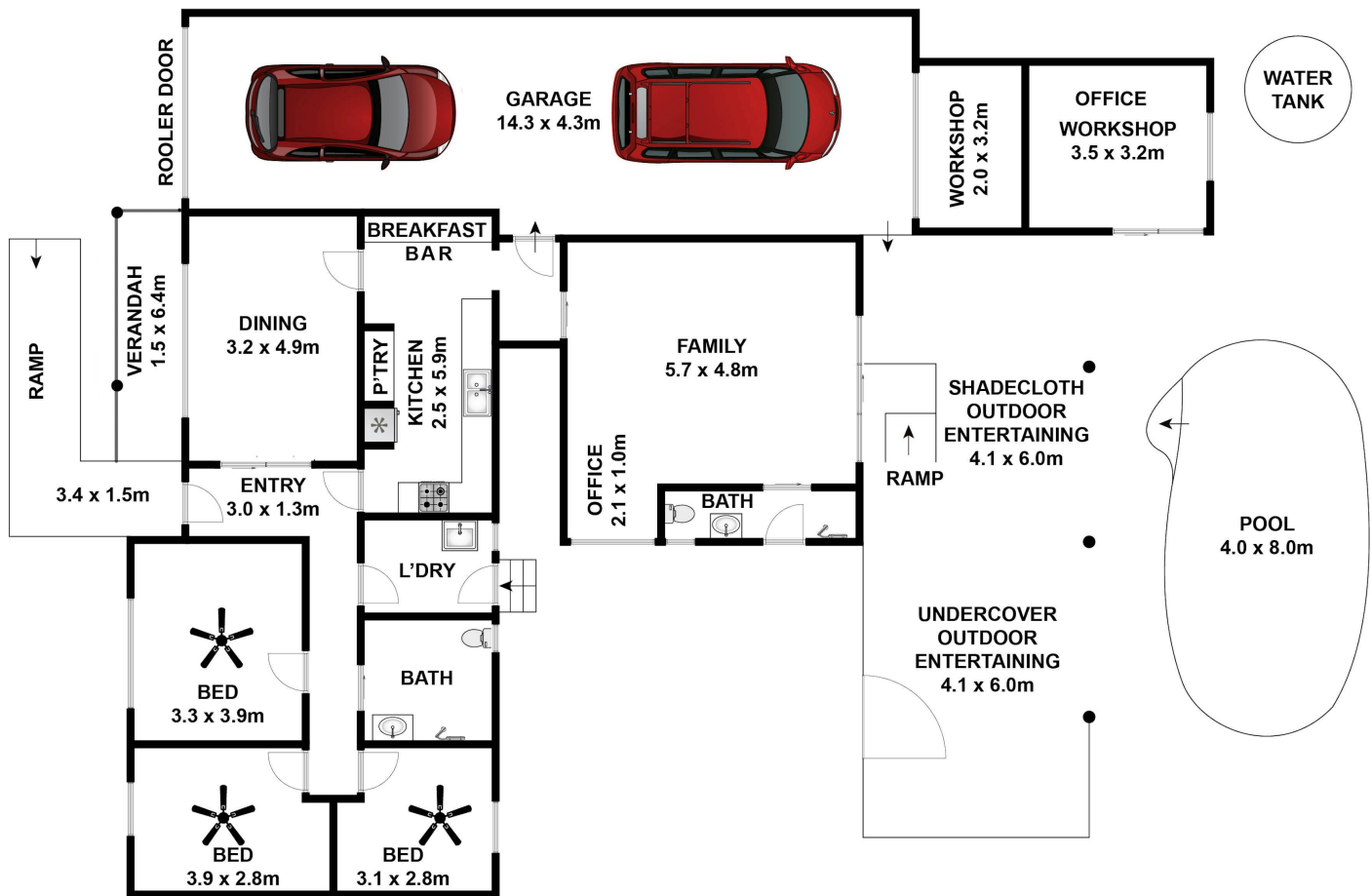

Approx House Area 189m<sup>2</sup>

Whilst [bwrn.com.au](http://bwrn.com.au) has made every attempt to ensure the accuracy of the floor plan contained here, measurements are approximate and no responsibility is taken for any error, omission, or mis-statement. This plan is for illustrative purposes only.

6 Aldenhoven Street, Berri

Elders

Real Estate