



## 105 Graves Road, MANSFIELD, VIC 3722

### Where Country Living Feels Effortless

Set across 10 acres of gently rolling countryside, this solid brick residence delivers space, privacy, and a true sense of calm. Built in 1977 by a trusted local builder, the home offers four well-proportioned bedrooms and two bathrooms, providing a comfortable foundation for family life or a relaxed rural escape.

Mature gardens surround the home, creating a peaceful, established setting, while Fords Creek traces the rear boundary, bringing a natural sense of serenity to the landscape. Practical features including a bore and shed support everyday country living, while the expansive skies and quiet environment make it easy to slow down and feel at home.

#### Property highlights:

- Private and tranquil 10-acre holding
- Established gardens with a timeless feel
- Bore water supply and functional shed
- Spacious home with opportunity to update and personalise

The particulars contained herein are supplied for information only and shall not be taken as a representation in any respect on the part of the vendor or its agent. Interested parties should contact the nominated person or office for full and current details.

**TYPE:** For Sale

**INTERNET ID:** 300P191545

#### SALE DETAILS

**\$1,290,000**

#### CONTACT DETAILS

,

**Catherine Pigdon**  
0419 001 528

- Lovely rural outlook
- Convenient location just 6 minutes from Mansfield

With sealed road access and town amenities close by, this property offers the ideal blend of rural freedom and everyday convenience. A place to unwind, grow, and enjoy the best of country living.

- Land Area 10 acres
- Bedrooms: 4
- Bathrooms: 2
- Car Parks: 2
- 3 car garage
- Double carport











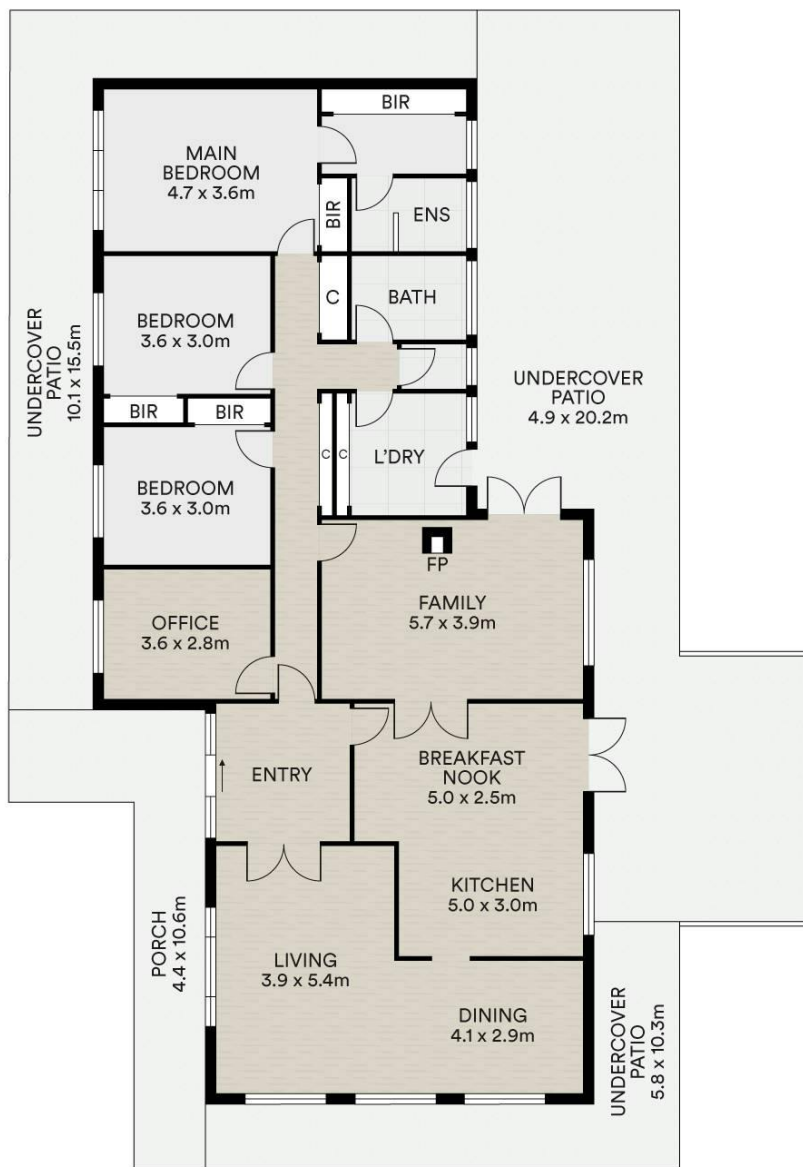

All information contained in this document is from sources we believe to be accurate, however we cannot guarantee its accuracy. Interested persons should make and rely on their own enquiries in relation to measurements, dimensions, layout, furniture and descriptions.