



6/80a Murray Road, WILLASTON, SA 5118

Neat, Chic and Completely Move in Ready

This beautifully presented, one-owner home has been lovingly maintained and showcases a level of care that is immediately evident. Built in 2016 by Sterling Homes, this brick veneer residence remains in pristine condition sitting on an approx 280m2 allotment, offering a stylish and move in ready opportunity for its next owners.

Set among other quality homes in a quiet, well-kept community, the property delivers a relaxed and low stress lifestyle. Every space has been thoughtfully designed and immaculately maintained, creating a home that feels both modern and welcoming.

At the front of the home, the spacious master suite offers floor to ceiling built in robes and an exceptionally generous ensuite. Directly across the hallway is bedroom four, ideal as a guest room, nursery, or home office, complete with carpet flooring and block-out blinds. The remaining two bedrooms are equally neat and tidy, featuring carpeted floors, built in robes, and block out blinds.

The open plan kitchen, living, and dining area forms the heart of the home. Fresh tiled floors and tasteful décor enhance the home's contemporary feel while making everyday living and entertaining effortless. The kitchen is both stylish and practical, featuring ample overhead and under-bench storage, a corner pantry, stainless steel

TYPE: For Sale

INTERNET ID: 300P192309

SALE DETAILS

\$689,000 - \$719,000

CONTACT DETAILS

Barossa

127 Murray Street

Tanunda, SA

(08) 8562 2883

RLA: 62833

Teri Wenske

0409 687 465

The particulars contained herein are supplied for information only and shall not be taken as a representation in any respect on the part of the vendor or its agent. Interested parties should contact the nominated person or office for full and current details.

appliances, a dishwasher, gas cooktop, and electric oven.

Step outside to a low maintenance backyard designed for easy entertaining and family enjoyment. A three-year-old deck provides the perfect space to host guests, complete with a retractable umbrella included in the sale. A separate fenced area ensures pets can be kept secure, while the concrete edging around the home adds a polished and cohesive finish.

Additional features include reverse cycle ducted heating and cooling for year-round comfort, a single car garage with manual roller door, and additional off-street parking at the front.

A recent rental appraisal has been completed with an expected return of between \$560 - \$590 per week.

Whether you're a first-home buyer, retiree, or investor, this stylish and impeccably kept property is one not to be missed. Be sure to attend the open inspections to secure this standout home.

Property Information

Council: Gawler Council

Council Rates: \$508 per quarter

Strata Fees: \$167 per quarter

Zoning: GN General Neighbourhood

Local Government Description: Residential

Year Built: 2016

Land Size: 280m2 approx.

Disclaimer:

We have in preparing this information used our best endeavours to ensure that the information contained herein is true and accurate but accept no responsibility and disclaim all liability in respect of any errors, omissions, inaccuracies, or misstatements that may occur. Prospective purchasers should make their own enquiries to verify the information contained herein. Elders Real Estate RLA62833

- Land Area 280.00 square metres
- Building Area: 145.00 square metres
- Bedrooms: 4
- Bathrooms: 2
- Single carport







6/80A Murray Road,
WILLASTON

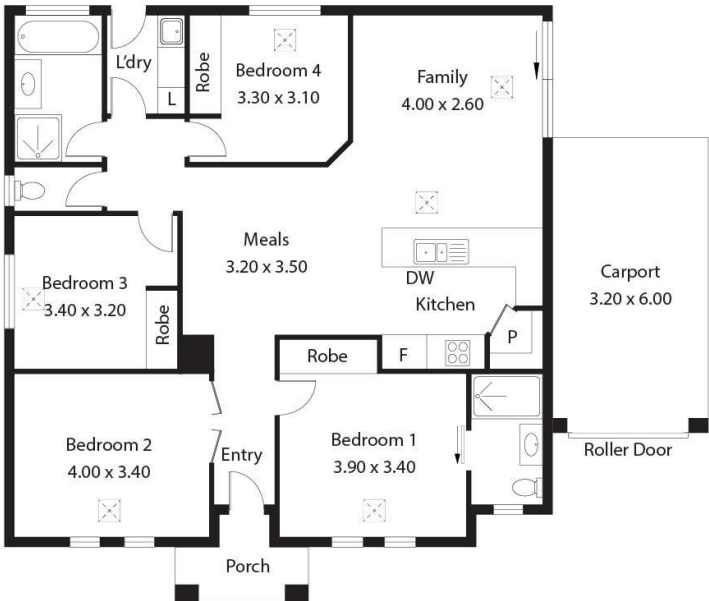

Living:	119.83SQ.M
Porch:	3.79SQ.M
Carport:	19.20SQ.M
TOTAL:	142.82SQ.M

This Drawing is for illustration purposes only. All measurements are internal and approximate. Details intended to be relied upon should be independently verified.