



23 Woods Road, YARRAWONGA, VIC 3730

Rock solid residence in central Yarrowonga.

Positioned on a generous corner allotment in the heart of Yarrowonga, this rock-solid brick veneer residence presents an outstanding opportunity for first home buyers, investors, or those seeking the perfect weekend escape.

Enjoy the convenience of a central location just moments from the main street, Lake Mulwala, local schools, and a range of everyday amenities. Offering great bones and plenty of scope to update or personalise, this home is packed with potential.

Inside, the property features four well-proportioned bedrooms, a central bathroom, and an original kitchen ready for renovation or immediate use. The expansive open-plan meals and living area provides a comfortable space for family living and entertaining.

Additional features include ducted evaporative cooling, ducted natural gas heating, and a freestanding gas heater for year-round comfort. Outside, the home you will discover dual car accommodation, a private and secure courtyard, and multiple shedding options-ideal for additional storage.

Whether you're looking to move straight in, renovate, or invest, this is a fantastic

The particulars contained herein are supplied for information only and shall not be taken as a representation in any respect on the part of the vendor or its agent. Interested parties should contact the nominated person or office for full and current details.

TYPE: For Sale

INTERNET ID: 300P192417

SALE DETAILS

\$559,000

CONTACT DETAILS

**Elders Real Estate
Yarrowonga**
48 Belmore Street
Yarrowonga, VIC
03 5743 9500

Xavier Leslie
0409 324 037

opportunity to secure a solid home in a highly sought-after Yarrawonga location.

Other features: Carpeted, Close to Schools, Close to Shops, Close to Transport, Exhaust, Heating, Openable Windows

- Land Area 596.00 square metres
- Bedrooms: 4
- Bathrooms: 1
- Double carport

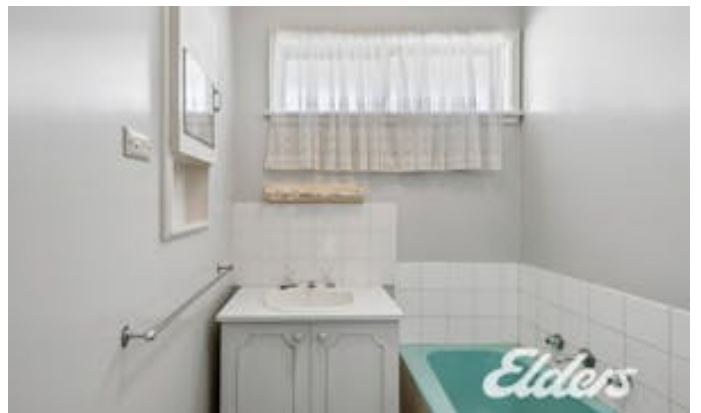



23 Woods Rd, Yarrawonga

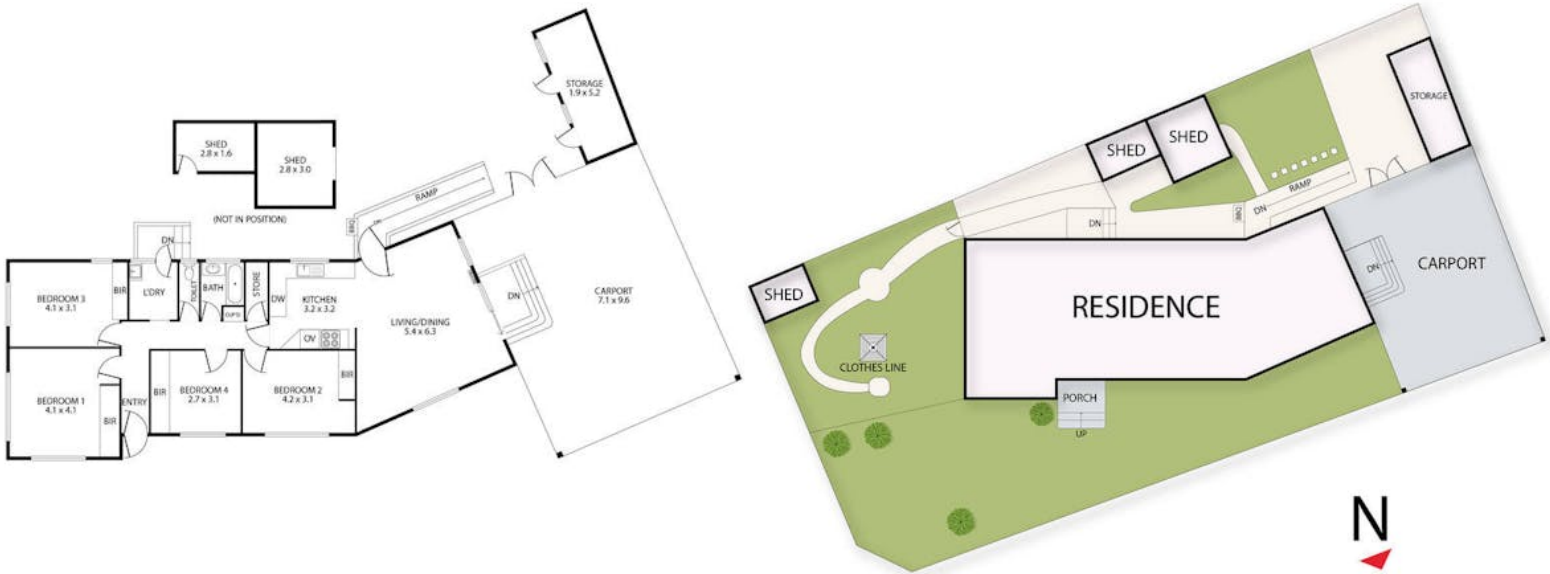

THE ABOVE PLAN IS AN ARTIST'S IMPRESSION ONLY, IT INCLUDES ELEMENTS THAT ARE FOR DISPLAY PURPOSES ONLY AND MAY NOT BE TO SCALE. LANDSCAPING SHOWN IS INDICATIVE ONLY. DIMENSIONS ARE APPROXIMATE.