



20 Wilkinson Avenue, HAYBOROUGH, SA 5211

Perfect Starter or Holiday Retreat

Set amongst the seaside suburb of Hayborough with just short stroll to the popular Hayborough beach sits this solid brick home set on 418sqm block.

Upon entering this property, you feel a sense of privacy with a purpose-built screen that takes you through to the front door. As you enter the home you are greeted with an open galley style living and kitchen area, which takes you out through the back glass sliding doors to an outdoor entertaining deck that overlooks the backyard where you can soak in the warmth of the sun and the sea breezes whilst enjoying your morning coffee.

From the living area you will find two carpeted bedrooms and there is also a combined bathroom and laundry with a separate toilet.

A split system located in the living area offers you year-round comfort.

The backyard benefits from a 3m x 6m shed which provides plenty of storage options for gardening tools and the like. There is also plenty of off-street parking.

TYPE: For Sale

INTERNET ID: 300P192462

SALE DETAILS

\$625,000 - \$680,000

CONTACT DETAILS

Elders Victor Harbor
11-13 Victoria Street
VICTOR HARBOR, SA
08 8555 9000
RLA: 62833

Deb Meagher
0429 009 132

This is the perfect property if you are starting your real estate journey or looking for a beach side retreat.

This cottage does lend itself to an upper-level construction which would enhance the sea view with 9m height allowed (stc approvals).

Inspections by appointment only.

Disclaimer: We have in preparing this information used our best endeavours to ensure that the information contained herein is true and accurate but accept no responsibility and disclaim all liability in respect of any errors, omissions, inaccuracies or misstatements that may occur. Prospective purchasers should make their own enquiries to verify the information contained herein. RLA 62833

- Land Area 418.00 square metres
- Bedrooms: 2
- Bathrooms: 1
- Car Parks: 2







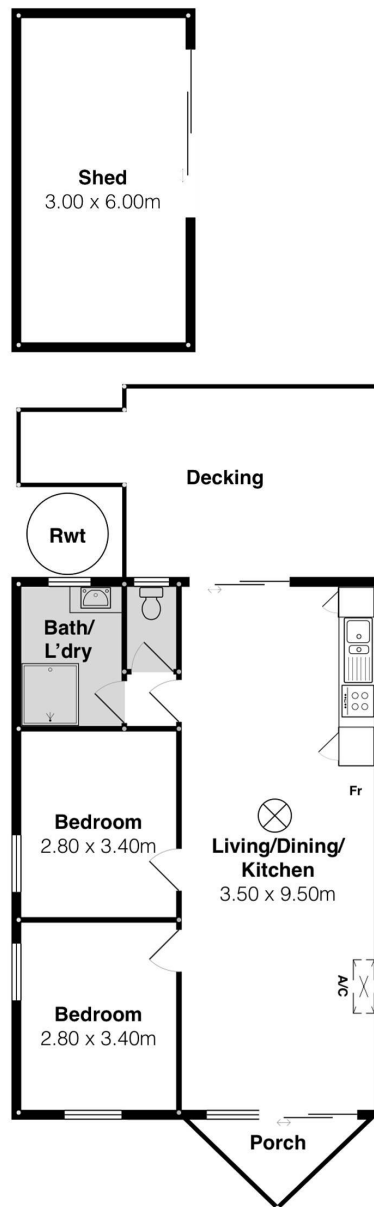

20 Wilkinson Ave, Hayborough

Scale in metres. This drawing is for illustration purposes only. All measurements are approximate and details intended to be relied upon should be independently verified.



PRODUCED BY
SOUTH COAST STUDIOS