



2/9 Davoren Court, VICTOR HARBOR, SA 5211

Relaxed Living Backing onto Nature in Central Victor

Positioned in Victor central and tucked away on a quiet cul-de sac, this charming two bedroom strata titled homette in a group of just two, sits on a low-care allotment of around 308sqm with the gorgeous outlook and private gate to rear tranquil nature reserve - a peaceful retreat that truly sets it apart.

Built circa 1992, the home presents in crisp neutral tones and is filled with natural light. A sunlit bay window enhances the welcoming lounge, complete with split system reverse cycle air conditioning and ceiling fan, before flowing effortlessly through to the central kitchen and casual meals area, where sliding glass doors frame serene reserve views.

The compact all-electric kitchen is perfectly positioned for easy conversation and connection, overlooking both the dining area and nature beyond. Centrally located, the main bathroom includes a shower, bath, and vanity, complemented by a separate WC and laundry for added practicality. Both bedrooms are well-proportioned, with the master featuring built-in robes, while the second bedroom offers flexibility as a guest room, home office, or creative space.

Secure single garage has an auto roller door and personal door plus a toolshed for storage.

TYPE: For Sale

INTERNET ID: 300P194705

SALE DETAILS

\$520,000 - \$570,000

CONTACT DETAILS

Elders Victor Harbor
11-13 Victoria Street
VICTOR HARBOR, SA
08 8555 9000
RLA: 62833

Paul Smith
0417 624 833

Outside, established front gardens keep maintenance to a minimum, while the neat, fully fenced rear yard with paved patio area provides a private and secure setting with a seamless connection to nature.

Ideal investment opportunity with six month lease to current tenant or thinking of downsizing but maybe not quite yet, this is an opportunity to embrace low-maintenance living in a highly sought-after central Victor location.

Disclaimer: We have in preparing this information used our best endeavours to ensure that the information contained herein is true and accurate but accept no responsibility and disclaim all liability in respect of any errors, omissions, inaccuracies or misstatements that may occur. Prospective purchasers should make their own enquiries to verify the information contained herein. RLA 62833

Other features: Close to Schools, Close to Shops, Openable Windows, Window Treatments

- Land Area 308.00 square metres
- Bedrooms: 2
- Bathrooms: 1
- Single garage

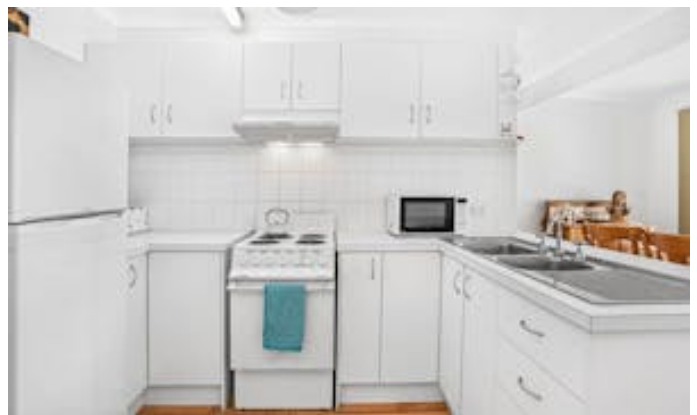



2/9 Davoren Ct Victor Harbor

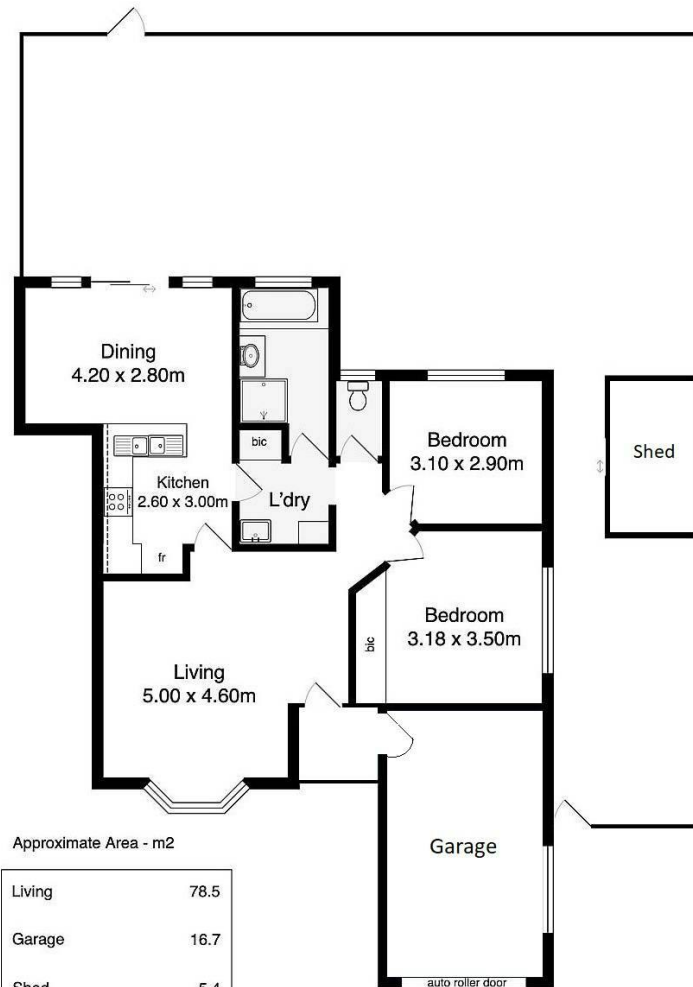

Approximate Area - m2

Living	78.5
Garage	16.7
Shed	5.4
Total	100.6



All measurements are approximate and for display purposes only