



## 1127 Grubben Road, HENTY, NSW 2658

Lifestyle property Henty

**26.06 hectares, 64.39 acres**

'Glenmore' 1127 Grubben rd is set on 64 acres (approx.) of open, arable land just 4.9km's from the center of Henty, this lifestyle holding is perfectly positioned a short drive from Henty but with a true country outlook.

Comfortable well built 4 bedroom brick home with new carpet & recently painted, large pantry, wood heater, ducted cooling & single car garage.

### Property Features

- Bitumen road to front entrance
- Mains water connected.
- Large dam & seasonal creek.
- Gently undulating, open land suited to cropping, & grazing.
- Hayshed, small machinery shed, 2 stand shearing shed (in need of repairs).

**TYPE:** For Sale

**INTERNET ID:** 300P194821

**SALE DETAILS**

**CONTACT AGENT**

**CONTACT DETAILS**

**Holbrook**

138 Albury Street  
Holbrook, NSW  
02 6036 2444

**Ewen Scholz**  
0428 293 817

The perfect combination, right here in Henty.

- Lifestyle and Location - Halfway between Albury & Wagga Wagga (approximately 65 kilometres each way).

Henty is a small town offering a great array of services including - supermarket, hardware, electrical store, hotel, club, bakery, primary schools, sporting facilities, pharmacy and bank along with a doctor's surgery and hospital.

Henty is located midway between Albury and Wagga Wagga on the Olympic Highway, just over 60 kilometres each way. The XPT train service offers an excellent service, stopping at Henty twice daily to Melbourne and Sydney.

Disclaimer: All information contained herein is gathered from sources we believe to be reliable. However, we cannot guarantee its accuracy and interested persons should rely on their own enquiries to verify the information contained in this document.

- Land Area 26.06 hectares
- Bedrooms: 4
- Bathrooms: 1

## HOMESTEAD

<b>Bedrooms</b>	<b>4</b>
<b>Bathrooms</b>	<b>1</b>







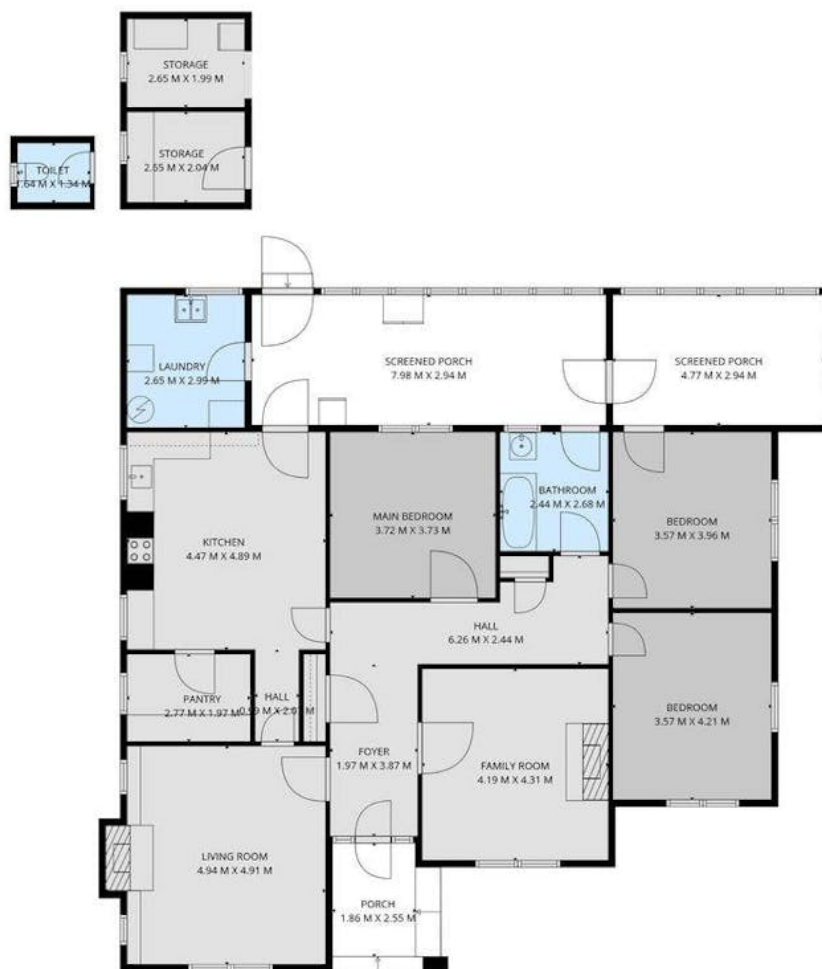

**TOTAL: 154 m<sup>2</sup>**  
 1st floor: 154 m<sup>2</sup>  
 EXCLUDED AREAS: SCREENED PORCH: 37 m<sup>2</sup>, PORCH: 7 m<sup>2</sup>, STORAGE: 11 m<sup>2</sup>,  
 FIREPLACE: 1 m<sup>2</sup>, WALLS: 15 m<sup>2</sup>

SIZES AND DIMENSIONS ARE APPROXIMATE, ACTUAL MAY VARY