



## 16 Scenic View Drive, SECOND VALLEY, SA 5204

### The Bach - Where Every Day Is a Holiday

Welcome to "The Bach", where there is an easy sense of calm the moment you arrive. Elevated to capture sweeping sea and hillside views, this warm and welcoming home offers a relaxed coastal lifestyle just a short stroll from the beach.

Filled with natural light, the open-plan living, dining and kitchen space is the heart of the home, framed by large picture windows and timber ceilings that add warmth and character. A combustion heater and split system keep things comfortable year-round, while recent updates bring a fresh, modern feel without losing the home's personality.

Step outside and the expansive front deck (possibly the biggest deck in Second Valley) becomes an extension of the living space. With an electric awning and elevated outlook, it's the perfect place to unwind, entertain, or simply take in the view.

Three bedrooms provide comfortable accommodation, including warm, natural-fibre carpet, ceiling fans, with the front two bedrooms holding outstanding sea views. A second toilet off the rear verandah for added convenience. Outside, established fruit trees, two tanks, and a versatile powered shed - complete with recent upgrades and salon space - offer flexibility for hobbies, storage or a home business.

**TYPE:** For Sale

**INTERNET ID:** 300P194838

#### SALE DETAILS

**\$775,000 to \$810,000**

#### CONTACT DETAILS

**Normanville**

91 Main Road  
Normanville, SA  
08 8598 6100

**Cassie Edwards**

0400 856 900

In recent years, the home has undergone a series of thoughtful upgrades, including:

- Painted internally and externally, including the shed (2021)
- Renovated bathroom (2020) with a custom glass feature shower screen
- New tongue and groove flooring and carpet (approx. 2022)
- Retractable flyscreens installed to front and rear doors (2021)
- Second toilet added to rear verandah (2024)
- Shed upgraded with power and extended to include salon space (2024)
- Air conditioning installed to shed (2025)
- Electric retractable awning added to front deck

Second Valley is one of the Fleurieu's most loved coastal pockets, known for its crystal-clear waters, sheltered beach, and dramatic cliffs that create a truly special landscape. It's a place where days are spent fishing, snorkelling, or exploring nearby walking trails, and evenings are often shared with neighbours in a welcoming, laid-back community.

This is a home with genuine character, where the pace slows, and the ocean is always within reach.

Walk in - Walk out negotiable.

If you can see yourself enjoying morning coffees on the deck and evenings by the fire, we'd love to show you through. Get in touch to arrange your inspection.

Disclaimer: We have in preparing this information used our best endeavours to ensure that the information contained herein is true and accurate but accept no responsibility and disclaim all liability in respect of any errors, omissions, inaccuracies or misstatements that may occur. Prospective purchasers should make their own enquiries to verify the information contained herein. RLA 62833

Other features: Ocean Views, Openable Windows, Toilet Facilities

- Land Area 711.00 square metres
- Building Area: 145.00 square metres
- Bedrooms: 3
- Bathrooms: 1
- Car Parks: 3



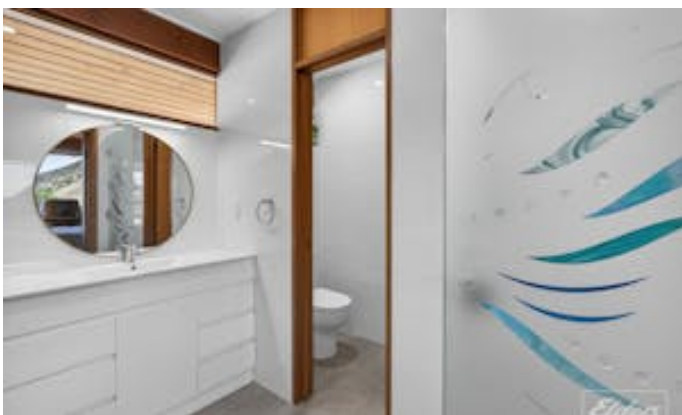





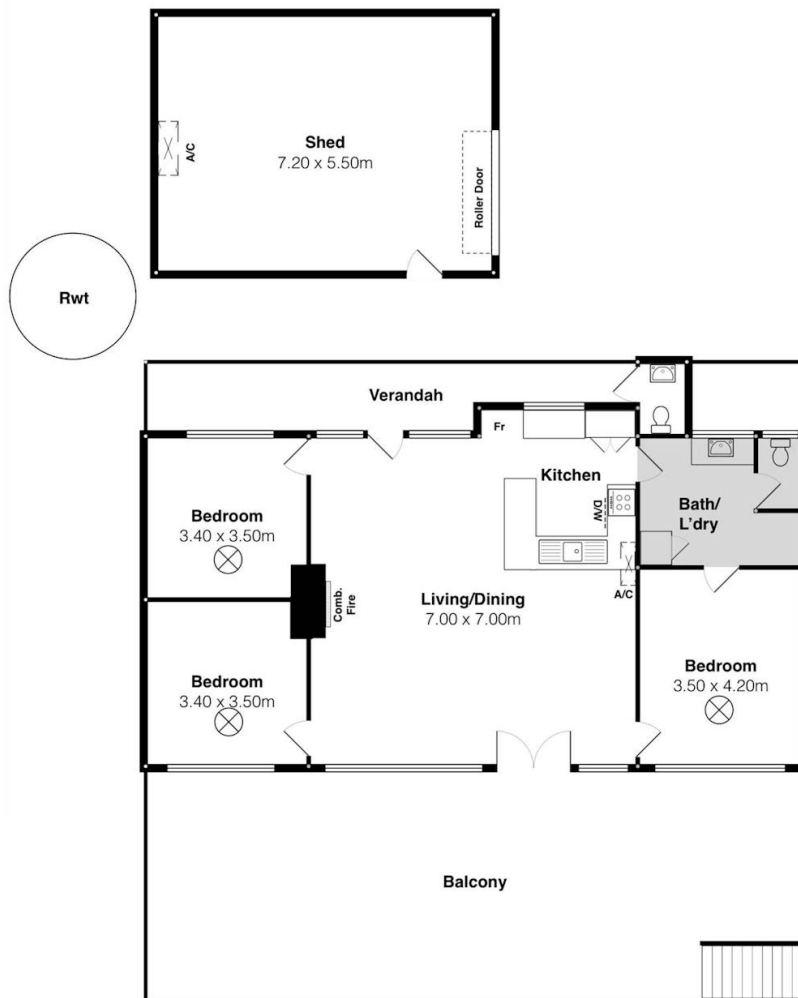

16 Scenic View Dr, Second Valley

Scale in metres. This drawing is for illustration purposes only. All measurements are approximate and details intended to be relied upon should be independently verified.



PRODUCED BY  
SOUTH COAST STUDIOS