



35 Reserve Drive, MURRAY BRIDGE, SA 5253

Immaculate Residence of Grand Proportions

Positioned in a highly sought-after westside pocket directly opposite Christian Reserve netball courts, this 2010 Hickinbotham home delivers space, comfort, and exceptional functionality.

Step inside to discover heritage-inspired décor throughout, ceiling fans in every room, and a thoughtfully designed floorplan that caters perfectly to family life or downsizing. The home features a spacious formal lounge and dining area at the front, a central open-plan kitchen, living, and dining zone, plus a separate family room at the rear. Built-in cabinetry surrounds the central living area, providing stylish and practical storage. Every detail has been meticulously cared for and must be seen to be fully appreciated, a true credit to the current owner.

The kitchen is a standout with a walk-in pantry, expansive bench and cupboard space, quality appliances including a Miele dishwasher, and abundant storage.

Accommodation is generous with large bedrooms, including a master suite complete with a massive walk-in robe, ensuite with his and hers basins, and additional bedrooms serviced by a three-way bathroom and laundry that provides further storage.

TYPE: For Sale

INTERNET ID: 300P195086

SALE DETAILS

Best Offers (Guide \$950k)

CONTACT DETAILS

Murray Bridge
201A Adelaide Road
Murray Bridge, SA
08 8531 9200
RLA: 62833

Jack Freestone
0435 207 475

Comfort and efficiency are front of mind with reverse cycle ducted air conditioning, a gas log heater, roller shutters for security and climate control, a full security system, and a 7.7 kilowatt solar system paired with an 11 kilowatt battery. Rainwater is plumbed directly to the home.

Outdoors, an expansive gable-roof paved pergola offers the ultimate entertaining space, while the rear yard includes a large 9 metre by 6 metre Colourbond shed with 15-amp power for use as a workshop or additional storage. The home also features dual driveway access, a double carport, and lush manicured gardens, making it as impressive outside as it is inside.

Located moments from Adelaide Road, local schools, shopping, and essential amenities, this property combines lifestyle, convenience, and long-term value.

Key Features:

- 2010 Hickinbotham home in a prized westside location
- Dual driveway access with double carport and lush manicured gardens
- Heritage-inspired décor with immaculate presentation
- Spacious formal lounge and dining area at the front
- Central open-plan kitchen, living, and dining area with separate family room at the rear
- Built-in cabinetry surrounds the central living area
- Ceiling fans throughout
- Kitchen with walk-in pantry, expansive bench and cupboard space, Miele dishwasher, and abundant storage
- Master suite with massive walk-in robe and ensuite
- Large additional bedrooms
- Three-way bathroom and laundry providing extra storage
- Reverse cycle ducted air conditioning and gas log heater
- Roller shutters and full security system
- 7.7 kw solar system with 11 kw battery and rainwater plumbed to the home
- Expansive gable-roof paved pergola for year-round entertaining
- Large 9m x 6m Colourbond shed with 15-amp power
- Close to Adelaide Road, schools, shopping, and local amenities

This home is a complete package offering space, versatility, and lifestyle, perfect as the ultimate family home or a relaxed retiree retreat.

CT - Volume 5909 Folio 805

Council - Rural City of Murray Bridge

Council Rates - \$3767 pa

Zoning - Township

Disclaimer: We have in preparing this information used our best endeavours to ensure that the information contained herein is true and accurate but accept no responsibility and disclaim all liability in respect of any errors, omissions, inaccuracies, or misstatements that may occur. Prospective purchasers should make their own enquiries to verify the information contained herein.

Elders Real Estate RLA 62833

Other features: 3 Phase Power, Close to Schools, Close to Shops, Close to Transport, Security System

- Land Area 767.00 square metres
- Bedrooms: 4
- Bathrooms: 2
- Car Parks: 5









35 Reserve Drive,
MURRAY BRIDGE

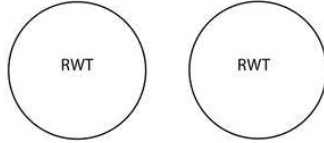

SS = Security Shutters

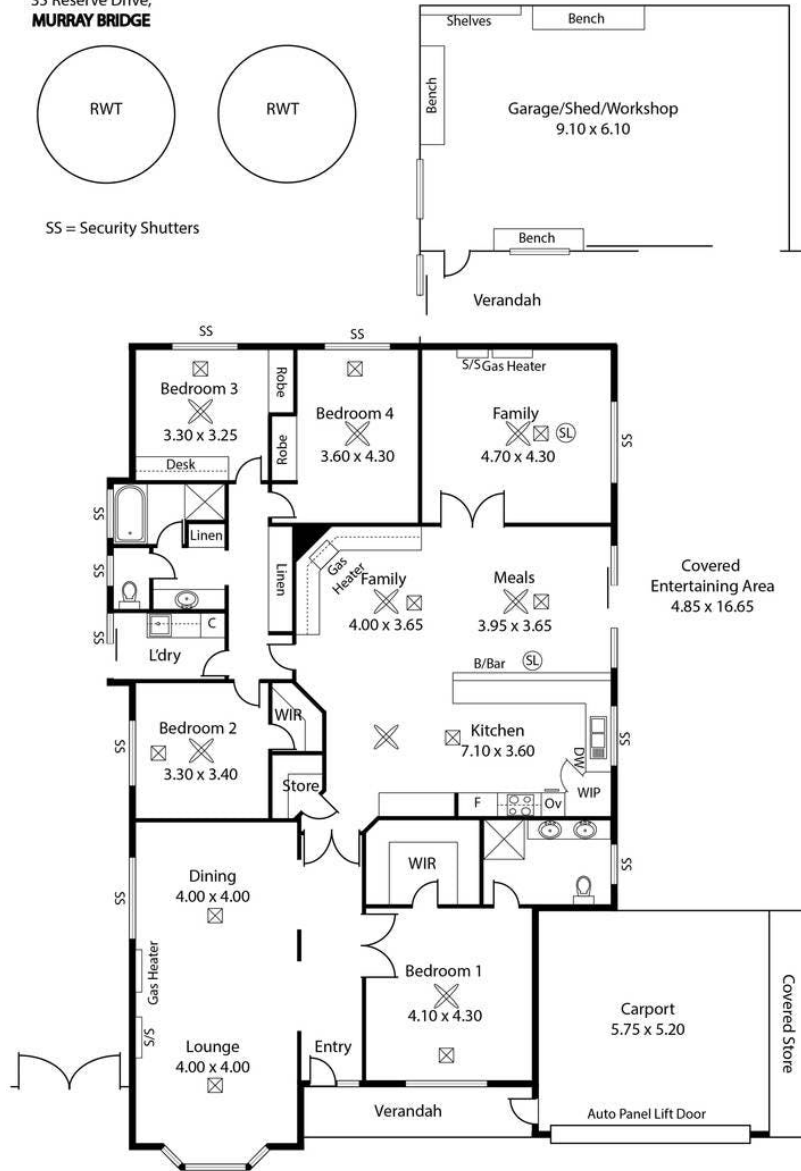

Living:	231.12 sqm
Verandah:	7.30 sqm
Ent. Area:	91.30 sqm
Gar/Shed/Work:	55.51 sqm
Carport/Cov. Store:	36.00 sqm
Total:	421.23 sqm

This Drawing is for illustration purposes only.
Not To Scale. All measurements are internal and approximate.
Details intended to be relied upon should be independently verified.
Produced by Open2view.com