

## 2/51 Hovell Street, YARRAWONGA, VIC 3730

"Tightly Held, Low-Maintenance & Right in the Heart of Town"

One of only two on the block, this tightly held and rarely offered residence presents an outstanding opportunity to secure a low-maintenance home in an unbeatable central Yarrowonga location.

Positioned close to the supermarket, one block from the main street and only steps to the local bowls club, the convenience on offer is exceptional.

Inside, the home has been thoughtfully updated with a refurbished kitchen, new flooring throughout, and a light-filled open-plan living area. Two well-proportioned bedrooms include built-in robes, central bathroom, a separate toilet and multiple climate options ensure year-round comfort.

Outdoors, the property is designed for effortless living and entertaining, featuring two generous undercover areas. The main alfresco includes adjustable rotating louvers for all-season use, while a second private rear area provides additional flexibility. With instant turf and minimal upkeep required, it's perfectly suited to those seeking a true low-maintenance lifestyle.

**TYPE:** For Sale

**INTERNET ID:** 300P195427

**SALE DETAILS**

**\$539,000**

**CONTACT DETAILS**

**Elders Real Estate  
Yarrowonga**  
48 Belmore Street  
Yarrowonga, VIC  
03 5743 9500

**Leigh Ramsdale**  
0408 385 150

Complete with a secure lock-up garage, this is a rare offering in a highly sought-after central position, ideal for downsizers, investors, or lifestyle buyers.

Other features: Carpeted, Close to Schools, Close to Shops, Close to Transport, Exhaust, Heating, Openable Windows

- Land Area 369.00 square metres
- Bedrooms: 2
- Bathrooms: 1
- Car Parks: 1
- Single garage





2/51 Hovell St, Yarrawonga

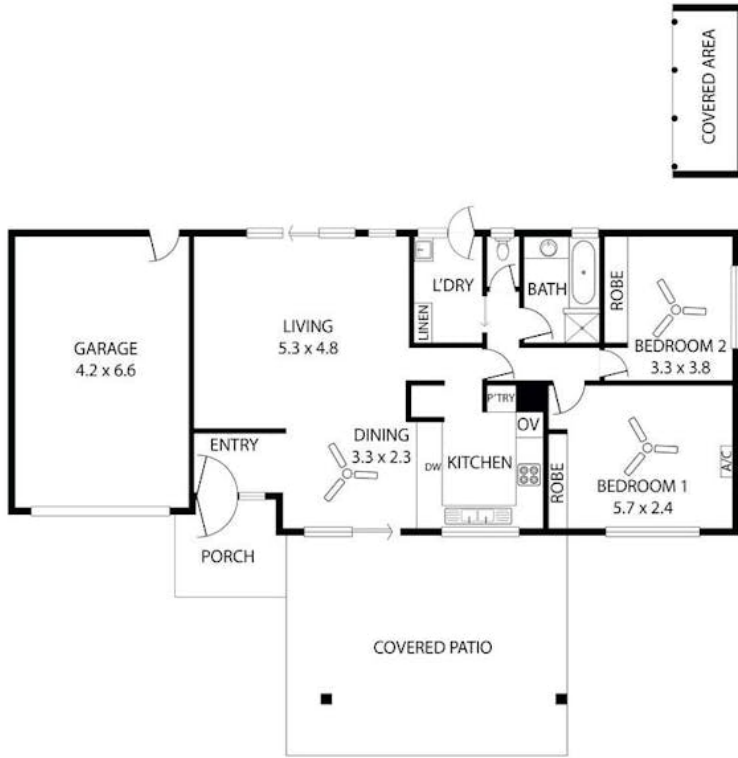

THE ABOVE PLAN IS AN ARTIST'S IMPRESSION ONLY, IT INCLUDES ELEMENTS THAT ARE FOR DISPLAY PURPOSES ONLY AND MAY NOT BE TO SCALE. LANDSCAPING SHOWN IS INDICATIVE ONLY. DIMENSIONS ARE APPROXIMATE.