



## 24 William Street, BIRDWOOD, SA 5234

Family Living starts here in a Great Location

The Ultimate Family Home, nestled on a generous 903sqm allotment, this quality built Marshall Thompson home offers the perfect blend of space, comfort and functionality. Featuring 4 spacious bedrooms- including a master with an ensuite and built in robes with the addition of another bathroom this home is ideal for growing families.

The renovated kitchen is the heart of the home, complemented by both a lounge and separate family room, giving everyone space to relax and come together. Year round comfort is assured with reverse cycle heating and cooling as well as a superb combustion wood heater for those cosy winter nights.

Outside , you'll love the magnificent outdoor entertaining area which seamlessly flows from the double length carport to the private and secure backyard, perfect for the children and pets, With 16 solar panels helping to reduce power bills this home is as efficient as it is inviting.

Located just walking distance to everything Birdwood has to offer, schools, shops cafes and more, this is an opportunity to secure a true lifestyle in a sought after township.

**TYPE:** For Sale

**INTERNET ID:** 300P195949

**SALE DETAILS**

**Contact Agent**

**CONTACT DETAILS**

**Elders Real Estate Clare Valley / Burra**

230 Main North Road

Clare, SA

08 8842 9300

**Stuart Woodman**

- Land Area 903.00 square metres
- Bedrooms: 4
- Bathrooms: 2
- Car Parks: 1
- Single garage









24 William Street,  
**BIRDWOOD**

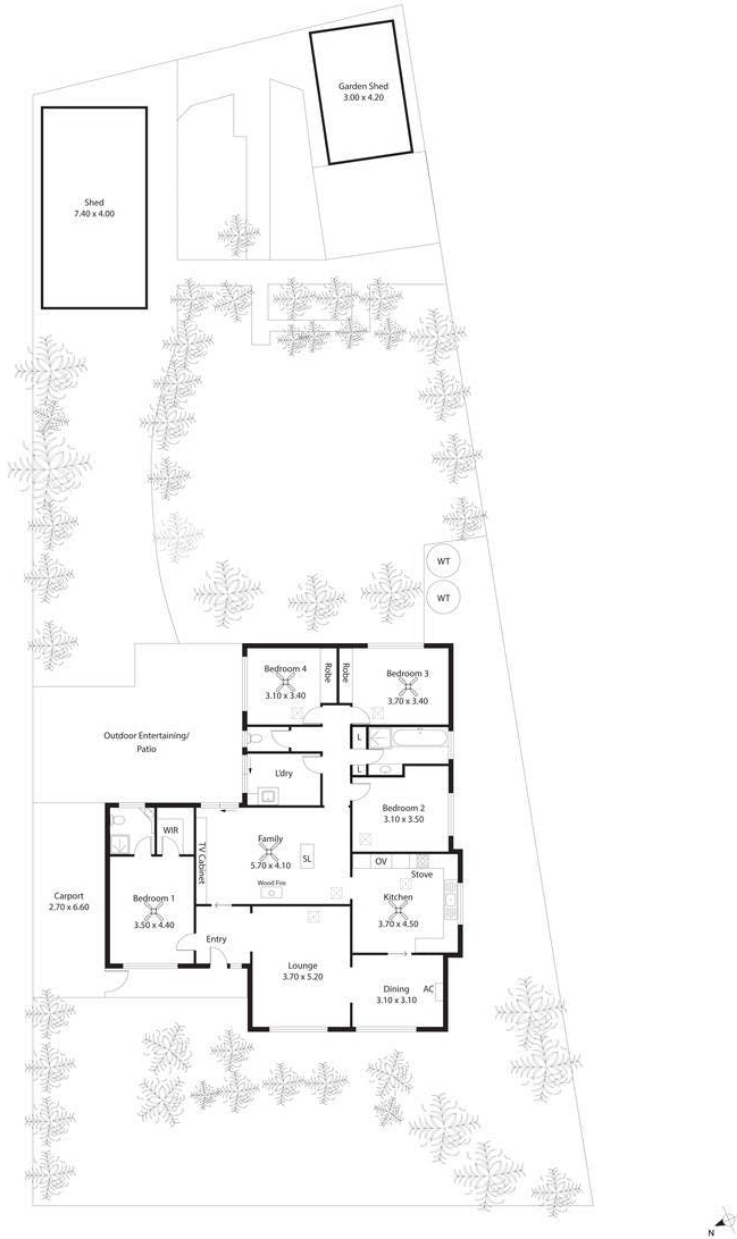

Living:	180.135Q.M
Carport:	17.825Q.M
Shed:	42.205Q.M
Outdoor:	50.005Q.M
<b>TOTAL:</b>	<b>296.155Q.M</b>

This Drawing is for illustration purposes only. All measurements are internal and approximate. Details intended to be relied upon should be independently verified.

24 William Street,  
**BIRDWOOD**

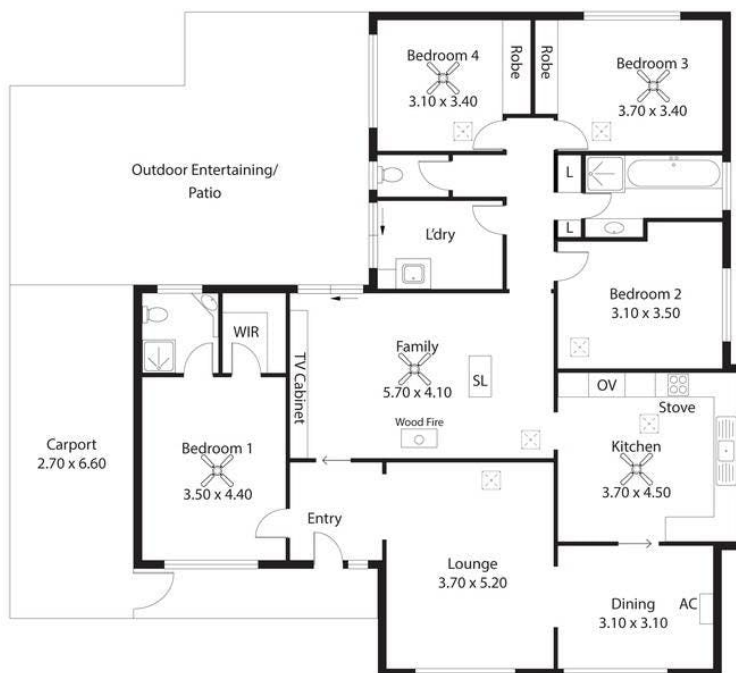

Living:	180.13SQ.M
Carport:	17.82SQ.M
Shed:	42.20SQ.M
Outdoor:	50.00SQ.M
<b>TOTAL:</b>	<b>290.15SQ.M</b>



This Drawing is for illustration purposes only. All measurements are internal and approximate. Details intended to be relied upon should be independently verified.