



127 Walkoms Lane, GOULBURN, NSW 2580

A gorgeous lifestyle property or country getaway to call your own

20.17 hectares, 49.84 acres

Elders proudly present to the market "Donofield Park"

Rarely does a lifestyle property of this calibre come to market in the highly sought after Bannister, Southern Tablelands area. The property consisting of 50 acres of lush, improved pasture, set amongst a backdrop of rolling hills will not disappoint the astute buyer looking for a country getaway or a place to call home. Located just 10 minutes from the thriving community of Crookwell, 20 minutes from the central hub of Goulburn and 1 hour and 20 minutes from Canberra, this property is perfectly located for all your work and lifestyle needs.

Property Highlights

- The custom-built Rawson home, completed in late 2022, has been crafted to a high quality and is immaculately presented, with picture windows overlooking the established landscaped gardens, a heated 10 metre inground pool and separate spa, perfect for relaxing on those cool winter nights.

TYPE: For Sale

INTERNET ID: 300P196409

SALE DETAILS

**\$1,975,000 -
\$2,100,000**

CONTACT DETAILS

Elders Real Estate

88 Hume Street
Goulburn, NSW
02 4824 4466

Kia Scott

0417 497 356

- The home exudes space and country charm with 4 oversized bedrooms all with built in robes, 2 bathrooms with freestanding baths and double basins and 3 lounge areas providing space and comfort for the whole family.

- The oversized alfresco area overlooking the pool and spa is perfect for entertaining family and friends or to sit, relax and take in the sun setting behind the distant hills.

- The home boasts a 5.9-kilowatt solar system, reverse cycle heating and cooling as well as a large built in woodfire to keep you toasty and warm during the cooler months.

- The spacious chef's kitchen, with 90cm electric oven and gas cook top with separate butler's pantry is sure to inspire the budding chef.

- Water is a feature of this property with 375,000L of water storage as well as an electric bore, 2 dams (1 being spring fed) and gravity fed water troughs to the 2 paddocks and near new cattle yards with crush.

- The property has been consistently running 15 cows and calves at foot and has been used for pasture hay production by the current owners.

- A powered 4-bay enclosed machinery shed, and workshop provides space and storage for all your equipment and farming needs.

Inspired country design on lifestyle acres of this quality close to amenities is rare but you really can have it all.

For all enquiries and inspections please reach out to Kia Scott

- Land Area 20.17 hectares
- Bedrooms: 4
- Bathrooms: 2

HOMESTEAD

Bedrooms	4
Bathrooms	2







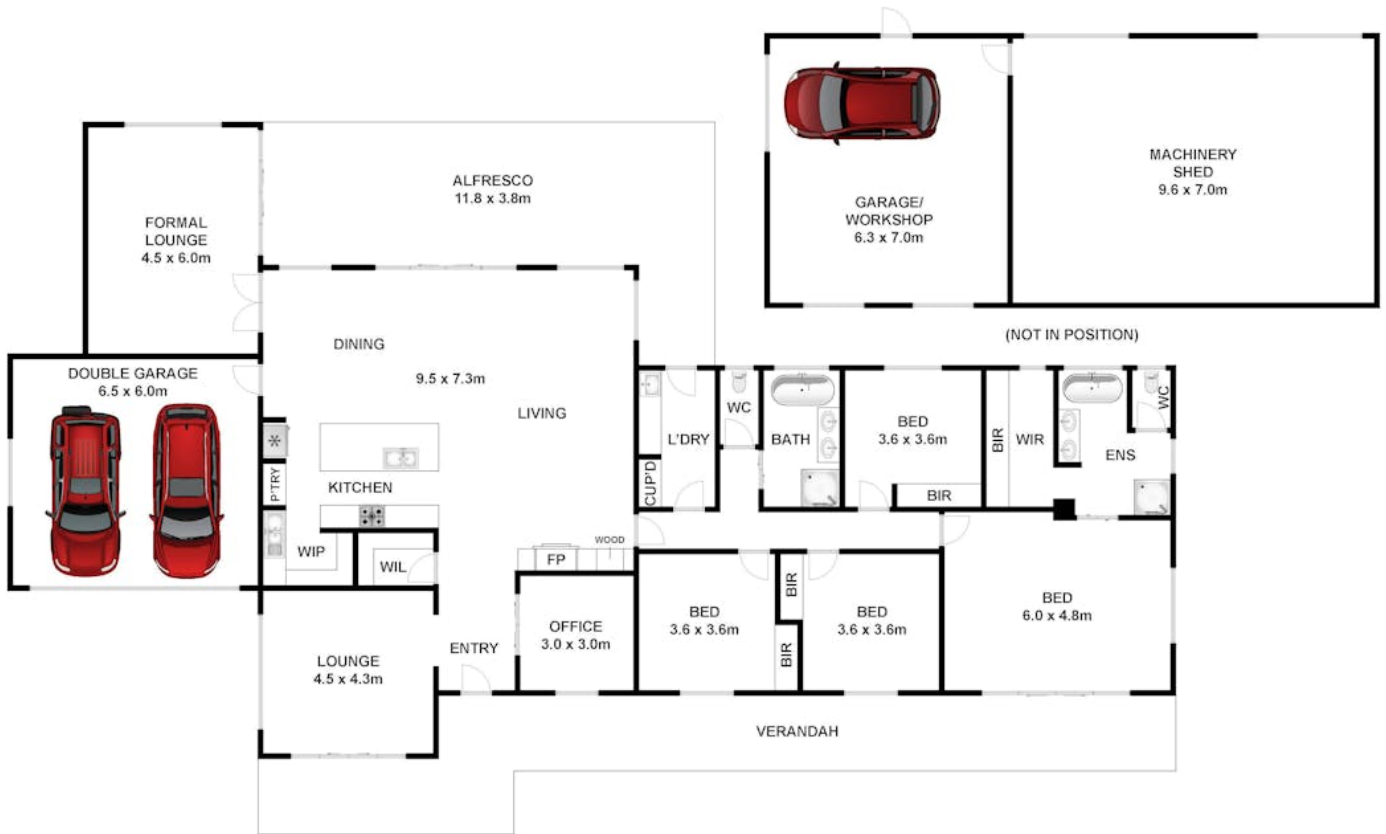

Whilst bwrn.com.au has made every attempt to ensure the accuracy of the floor plan contained here, measurements are approximate and no responsibility is taken for any error, omission, or mis-statement. This plan is for illustrative purposes only.

127 Walkoms Lane, Bannister