



## 8 Leah Drive, YARRAWONGA, VIC 3730

### The Ultimate Blend of Comfort & Convenience

This spacious and well-appointed family home delivers the perfect balance of comfort, functionality, and outdoor entertaining. Set on a generous allotment with genuine side access and ample room for a pool, 8 Leah Drive offers lifestyle flexibility for families, first home buyers or retirees.

Inside, the home features four well-sized bedrooms, including a master suite complete with walk-in robe, ensuite, and separate toilet for added privacy and convenience.

Multiple living zones include a spacious open-plan kitchen, dining and lounge area, plus a separate second living room ideal for families needing additional space to relax or entertain.

The well-equipped kitchen set in the heart of the home includes a gas cooktop, electric oven, dishwasher, and ample storage with easy access to the large outdoor entertaining space.

Comfort is assured year-round with gas ducted heating, evaporative cooling, and a split system air conditioner, off set by the Solar System

The particulars contained herein are supplied for information only and shall not be taken as a representation in any respect on the part of the vendor or its agent. Interested parties should contact the nominated person or office for full and current details.

**TYPE:** For Sale

**INTERNET ID:** 300P197140

#### SALE DETAILS

**\$675,000**

#### CONTACT DETAILS

**Elders Real Estate  
Yarrowonga**  
48 Belmore Street  
Yarrowonga, VIC  
03 5743 9500

**Leigh Ramsdale**  
0408 385 150

Outdoors, the property continues to impress with two alfresco areas - a large undercover entertaining space perfect for gatherings, plus an additional rear undercover area providing even more versatility. The oversized garden shed, secure double garage, and excellent side access further enhance the practicality of this impressive property.

A fantastic opportunity to secure a quality family home with space, comfort, and outstanding outdoor appeal in one of Yarrowonga's more convenient residential locations.

Headline Options:

Other features: Carpeted, Close to Schools, Close to Shops, Close to Transport, Exhaust, Heating, Openable Windows

- Land Area 659.00 square metres
- Bedrooms: 4
- Bathrooms: 2
- Car Parks: 2
- Double garage
- Ensuite







# 8 Leah Dr, Yarrawonga

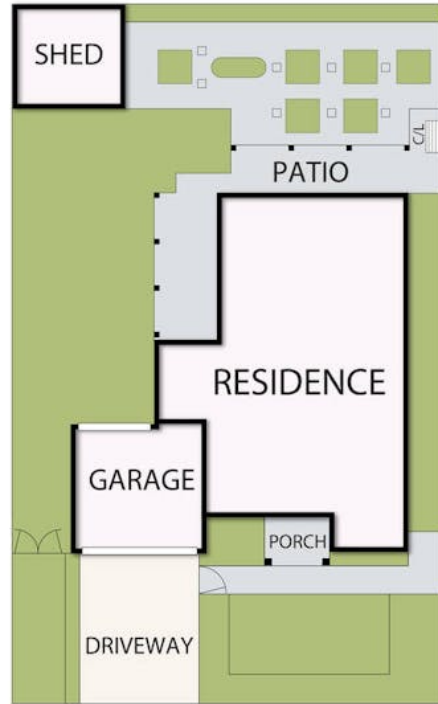

Xavier Leslie  
0409 324 037



Leigh Ramsdale  
0408 385 150

THE ABOVE PLAN IS AN ARTIST'S IMPRESSION ONLY, IT INCLUDES ELEMENTS THAT ARE FOR DISPLAY PURPOSES ONLY AND MAY NOT BE TO SCALE. LANDSCAPING SHOWN IS INDICATIVE ONLY. DIMENSIONS ARE APPROXIMATE.