



17 Jasmine Drive, WHYALLA STUART, SA 5608

SECURE YOUR PORTFOLIO WITH THIS PROVEN INVESTMENT

*** INSPECTION BY APPOINTMENT ONLY DUE TO TENANCY ***

Allotment size: 537m²

Council rates: \$1,869.11 per annum

Water supply & sewer rates: approx \$165 per quarter

Year built: 1970

Zoned: General neighbourhood

Occupancy: Currently tenanted \$290 per week until 12 February 2027

An outstanding investment opportunity in the heart of Whyalla Stuart, this well-positioned property at 17 Jasmine Drive offers immediate rental income with a secure tenant already in place until February 2027. Conveniently located close to local shops, schools, public transport, parks, and everyday amenities, it provides the lifestyle and convenience tenants seek. The property also enjoys easy access to Whyalla's major employment hubs, sporting facilities, and community services, supporting

The particulars contained herein are supplied for information only and shall not be taken as a representation in any respect on the part of the vendor or its agent. Interested parties should contact the nominated person or office for full and current details.

TYPE: For Sale

INTERNET ID: 300P197508

SALE DETAILS

\$289,000

CONTACT DETAILS

Elders Real Estate - Whyalla

2 Patterson Street

Whyalla, SA

08 8644 4600

RLA: 62833

Jake Pope

0437 829 177

ongoing rental demand. With a long-term tenancy secured and a desirable location, this is a smart addition to any investment portfolio.

Welcoming entry leading into a comfortable carpeted lounge room

Kitchen and meals featuring air-conditioning and freestanding oven

Three generously sized, carpeted bedrooms

Master bedroom complete with split-system air-conditioning, ceiling fan, and mirrored built-in robes

Well-appointed tiled bathroom with separate bath and walk-in shower

Functional laundry with separate toilet and direct outdoor access

Convenient built-in storage cupboards in the hallway

Low maintenance front and rear yards

Large shed providing excellent storage or workshop space

Secure off-street parking with roller door access

Disclaimer: We have in preparing this information used our best endeavours to ensure that the information contained herein is true and accurate but accept no responsibility and disclaim all liability in respect of any errors, omissions, inaccuracies, or misstatements that may occur. Prospective purchasers should make their own enquiries to verify the information contained herein. Elders Real Estate RLA62833

- Land Area 537.00 square metres
- Bedrooms: 3
- Bathrooms: 1
- Double garage
- Double carport







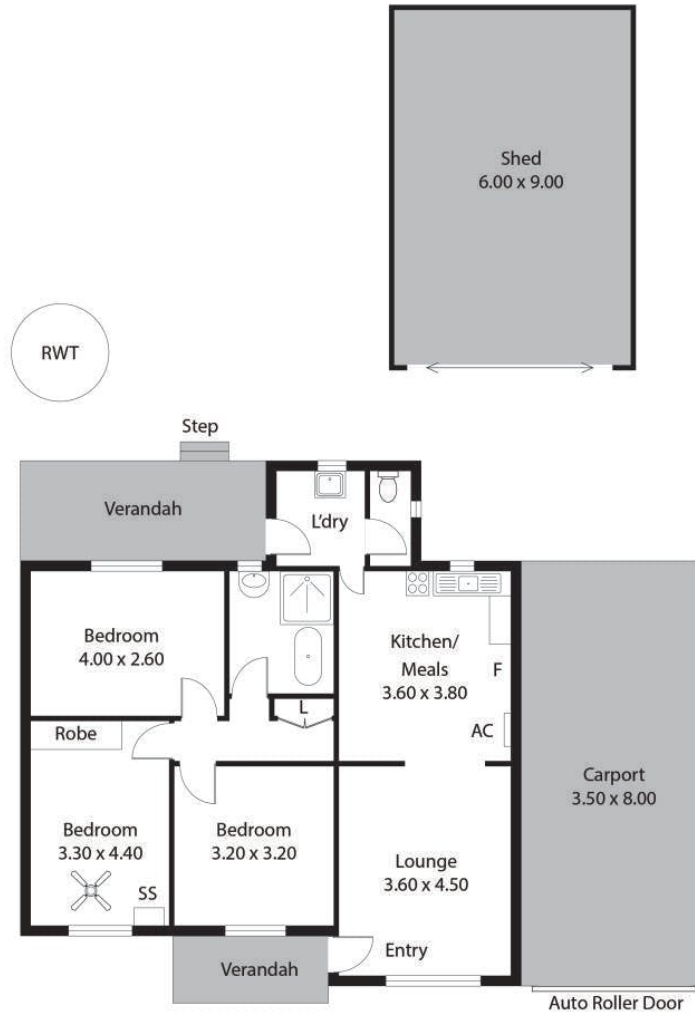

Living:	80.74sqm
Verandah:	14.36sqm
Carport:	28.00sqm
Shed:	54.00sqm
Total:	177.10sqm

This drawing is for illustration purposes only. All measurements are internal and approximate. Details intended to be relied upon should be independently verified.
Produced by Open2view.com

