



169 Scotts Creek Shack Road, MORGAN, SA 5320

Premium Holiday Destination Home in a Popular River Front Location

This family friendly holiday home has almost everything you could wish for on the river.

Scott's Creek has proven to be a popular place for families of all ages to enjoy skiing. The beautifully lawned, fully reticulated, and landscaped property features terracing with stairs down to the river where the dock for your ski boat awaits.

With an elevated family friendly holiday home on two levels with such features as a spacious open plan lounge dining room leading into a well-appointed kitchen, with three double bedrooms upstairs and a fourth downstairs, there is room for all the family and your friends. Other creature comforts include reverse cycle air conditioning and ceiling fans upstairs with the added benefit of a second toilet downstairs.

This property has a generous 9m x 6m boat shed with concrete floor providing safe storage for your boat, ski gear and lawn mower. With a spacious 8m x 5.6m entertaining area with retractable blinds providing the perfect place to enjoy a barbecue with friends and family while taking in the uninterrupted views of the river.

Quality holiday homes such as this are rare in the current market. As this property is

The particulars contained herein are supplied for information only and shall not be taken as a representation in any respect on the part of the vendor or its agent. Interested parties should contact the nominated person or office for full and current details.

TYPE: For Sale

INTERNET ID: 300P197600

SALE DETAILS

\$1,300,000

CONTACT DETAILS

Elders Riverland

2 East Terrace

LOXTON, SA

8588 6066

RLA: 62833

Wayne Kleemann

0417 000 988

being offered for sale with furniture, fixtures and fittings included, the only thing you need is to sit back with a cool drink, relax and enjoy the stunning surroundings.

Disclaimer:

We have in preparing this information used our best endeavours to ensure that the information contained herein is true and accurate but accept no responsibility and disclaim all liability in respect of any errors, omissions, inaccuracies, or misstatements that may occur. Prospective purchasers should make their own enquiries to verify the information contained herein. Elders Real Estate RLA62833

- Bedrooms: 4
- Bathrooms: 1
- Double garage







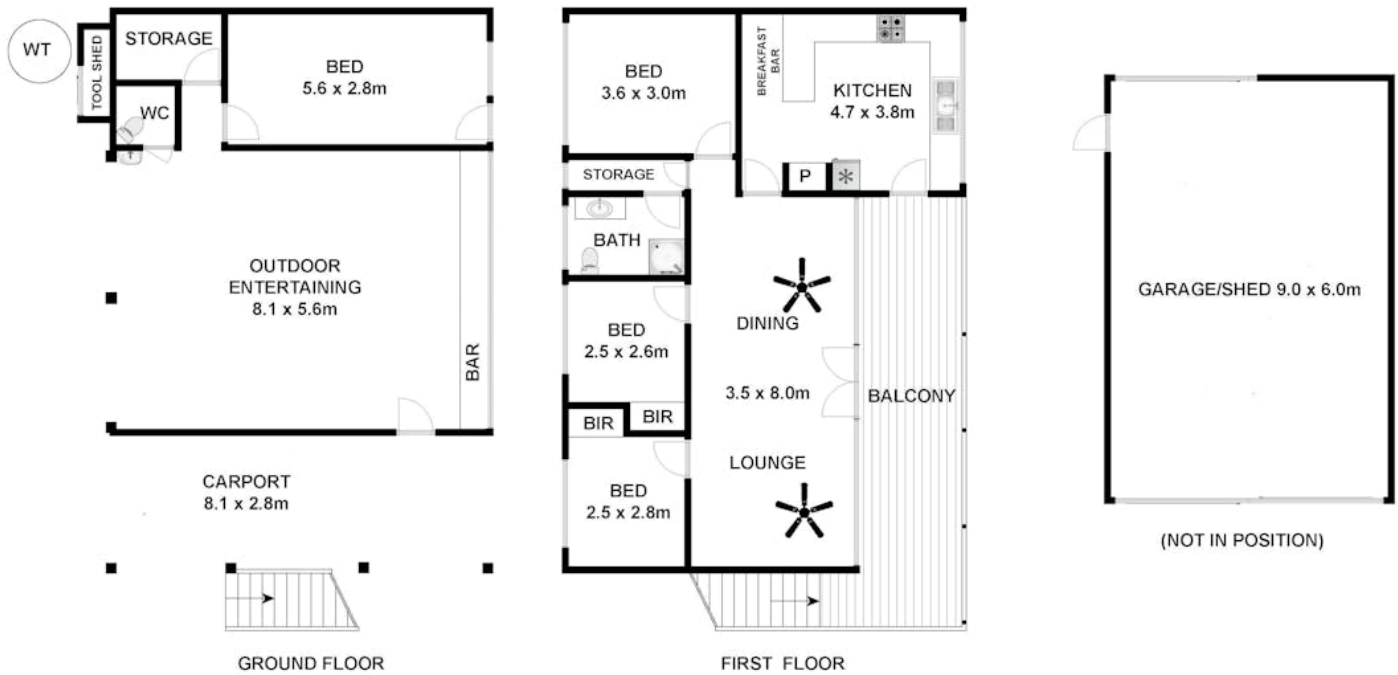

Approx House Area 108m²

Whilst bwrn.com.au has made every attempt to ensure the accuracy of the floor plan contained here, measurements are approximate and no responsibility is taken for any error, omission, or mis-statement. This plan is for illustrative purposes only.

169 Scotts Creek Shack Road, Morgan