

128 Penrice Road, PENRICE, SA 5353

Character Home, Corner Block and in Need of Modernising

Known as a Row Cottage, this character home has 8 main rooms with numerous doors and access making this a versatile floorplan to keep as-is or change the layout to better suit your needs.

Currently utilised as a 4-bedroom home but could also be a 3-bedroom with study option and separate dining and lounge areas.

The home is allegedly one of the first built in the area, so yes! It has some cracks appearing (wouldn't we all have cracks if we were that old).

This home is ripe for a new owner to take charge and bring this historical home back to life with some love and care and modernising into the 21st century. With numerous other Airbnb's in the quaint area of Penrice this could be one avenue of choice with its close proximity to the main street of Angaston and all that offers, as well as close to other major towns across the beautiful Barossa Valley with cafes, restaurants, wineries, bakeries and hotels all within easy reach.

Set on a corner block allotment of approximately 1,230m2 there is also the opportunity

The particulars contained herein are supplied for information only and shall not be taken as a representation in any respect on the part of the vendor or its agent. Interested parties should contact the nominated person or office for full and current details.

TYPE: For Sale

INTERNET ID: 300P25356

SALE DETAILS

\$540,000 - \$580,000

CONTACT DETAILS

Barossa

127 Murray Street

Tanunda, SA

(08) 8562 2883

RLA: 62833

Damien Geyer

0438 878 181

to discuss with council the possibility of subdividing the rear section off (accessible to Salem Road) helping you to fund the renovation project you have in mind.

Other features include solar panels for lower utility costs, rainwater tank, carport and shed parking, low maintenance lawn yards, and dual access from Penrice Road, or Salem Road.

Disclaimer:

We have in preparing this information used our best endeavours to ensure that the information contained herein is true and accurate but accept no responsibility and disclaim all liability in respect of any errors, omissions, inaccuracies, or misstatements that may occur. Prospective purchasers should make their own enquiries to verify the information contained herein. Elders Real Estate RLA62833

Other features: Close to Schools, Close to Shops, Heating, Toilet Facilities

- Land Area 1,230.00 square metre
- Building Area: 167.00 square metres
- Bedrooms: 3
- Bathrooms: 1
- Single garage
- Single carport







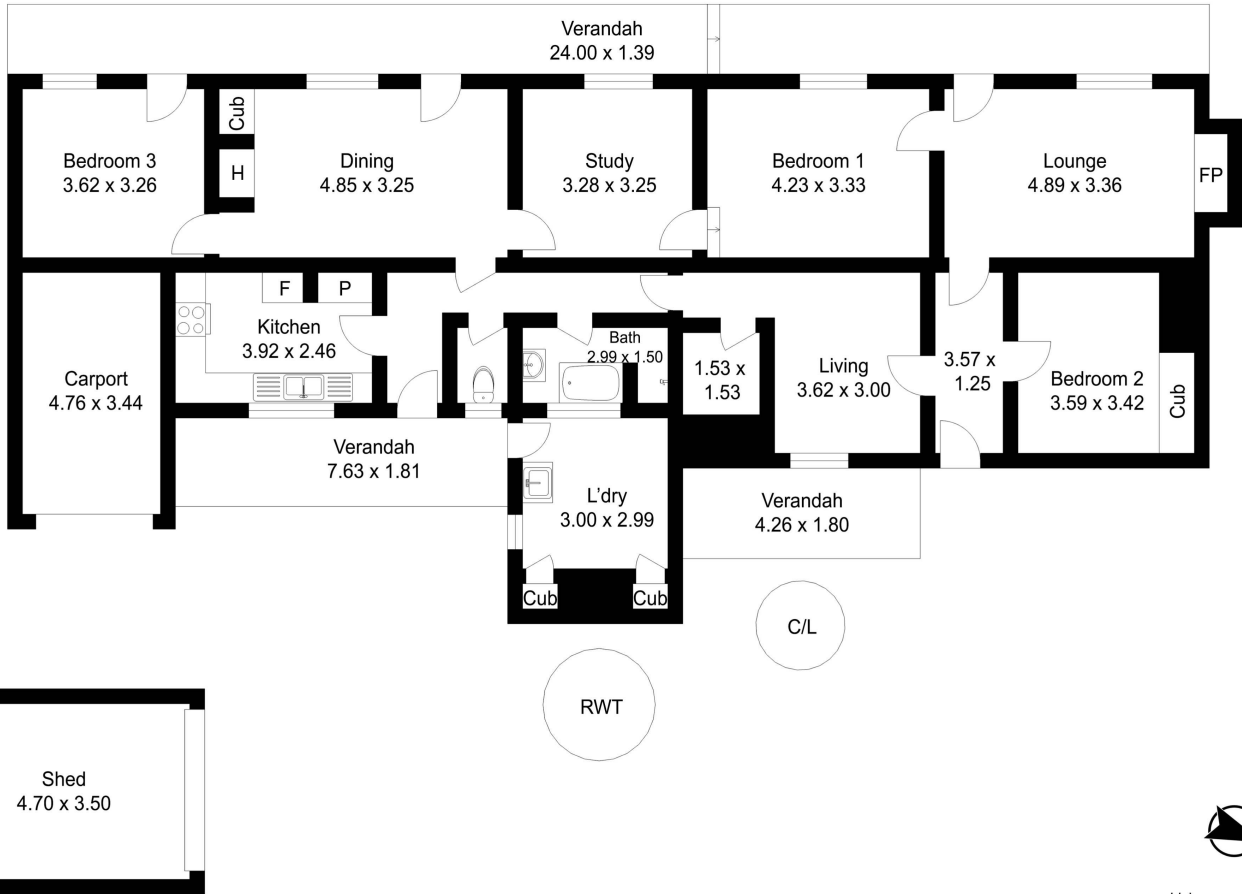

128 Penrice Road, **Penrice**

Living:	160m ²
External:	71 m ²
Carport:	16 m ²
Total:	247 m ²

Disclaimer: All measurements are approximate and are provided for illustrative purposes only. While every effort has been made to ensure accuracy, actual dimensions may vary. Interested parties should conduct their own enquiries.