

## 95 Gladstone Avenue, CONISTON, NSW 2500

### Commercial Warehouse Opportunity!

Elders Real Estate Wollongong are PROUD to offer this perfectly positioned Commercial Property

- Huge street exposure
- Located Along popular Gladstone Avenue Wollongong
- Easy access in and out of the Wollongong CBD
- Property would suite a variety of businesses
- Currently used as a smash repair business, with existing use
- 1 half of property available for lease only
- Office and Warehouse space

This Business location will not disappoint!

**TYPE:** For Lease  
**INTERNET ID:** 36P2780  
**RENTAL DETAILS**  
**Rent / Lease:**  
**Expressions Of Interest**

**CONTACT DETAILS**  
**Elders Real Estate Wollongong**  
353 Crown Street  
WOLLONGONG, NSW  
02 4228 7878  
**Daniel Niceski**  
0408 422 876

It offers you a truly rare opportunity to secure and establish your business

This property definitely is a must see!

Call today and schedule your private inspection.

- Available Now
- Land Area 1,400.00 square metre
- Commercial Type:
- Building Area: 112.00 square metres



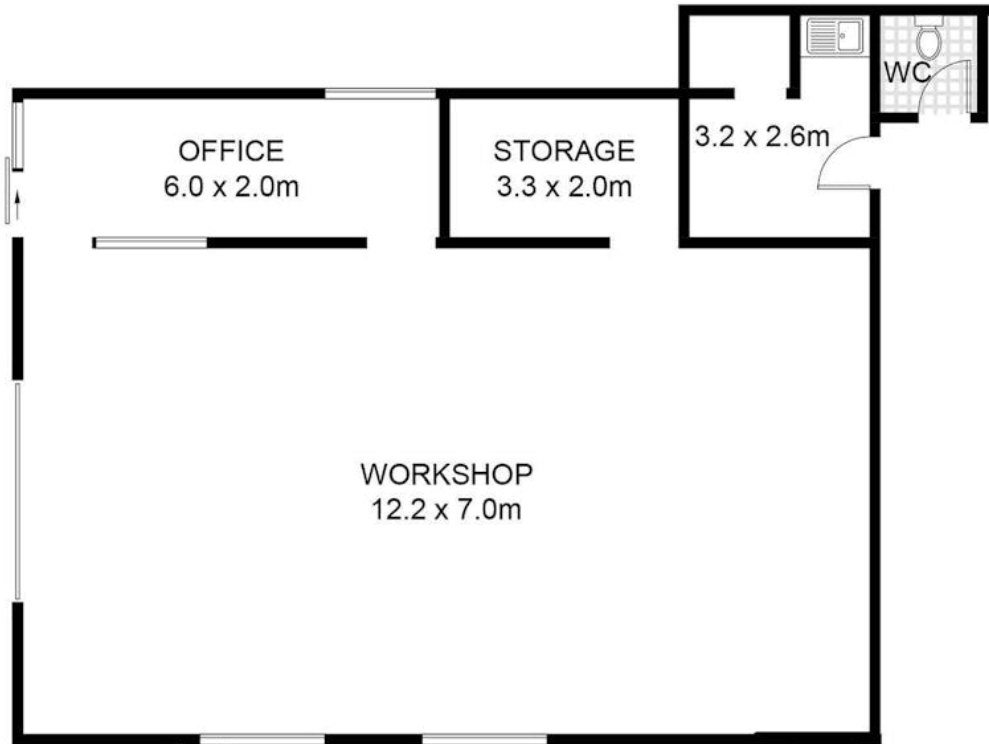

## 95 Gladstone Avenue, Wollongong

Approximate Gross Internal Area = 372.3 sq m

Scale in metres. Indicative only. Dimensions are approximate. All information contained herein is gathered from sources we believe to be reliable. However, we cannot guarantee its accuracy and interested persons should rely on their own enquiries. Some images may contain digital furniture.