



122-126 Montague Street, NORTH WOLLONGONG, NSW 2500

Brand New A-Grade Industrial /Commercial Warehouses | Prime Wollongong Location - Two Location's

122 Montague street 3 x 500m² Warehouses - Ready for immediate occupancy

39 Montague street 16 x 200m² Warehouses â## Under Construction

Elders Real Estate Wollongong is proud to present this brand-new boutique industrial/commercial development, offering premium warehouse spaces in one of Wollongong's most sought-after locations.

If you're seeking a corporate A-grade industrial or commercial facility, this is an opportunity not to be missed.

Property Highlights

- Three (3) warehouse options available
- Sizes ranging from 500m² to 1,680m²

The particulars contained herein are supplied for information only and shall not be taken as a representation in any respect on the part of the vendor or its agent. Interested parties should contact the nominated person or office for full and current details.

TYPE: For Lease
INTERNET ID: 36P2982
RENTAL DETAILS
Rent / Lease:
[Expressions Of Interest](#)

CONTACT DETAILS
Elders Real Estate Wollongong
 353 Crown Street
 WOLLONGONG, NSW
 02 4228 7878
Lou Niceski
 0414 287 093

- 23 on-site parking spaces
- Mezzanine levels included
- 3-phase power
- High-clearance roller doors
- Truck access with off-street parking
- Modern kitchen and bathroom amenities
- Prominent high-exposure corner position

Strategically positioned in a highly visible and easily accessible location, surrounded by established businesses and major national brands.

- Approx. 5 minutes to Wollongong CBD
- Within the University of Wollongong and Innovation Campas precinct
- Approx. 15 minutes to Port Kembla Harbour
- Around 1 hour to Sydney CBD and Sydney Airport

Ideal For

- Warehousing & logistics
- Trade and service businesses
- Light manufacturing
- Showroom + warehouse users

This development offers the perfect combination of modern design, accessibility, and functionality, making it ideal for a wide range of commercial, industrial, and trade-based businesses.

For further information or to arrange an inspection, please contact: Elders Real Estate Wollongong 4228 7878

- Commercial Type:
- Building Area: 500.00 square metres



The particulars contained herein are supplied for information only and shall not be taken as a representation in any respect on the part of the vendor or its agent. Interested parties should contact the nominated person or office for full and current details.

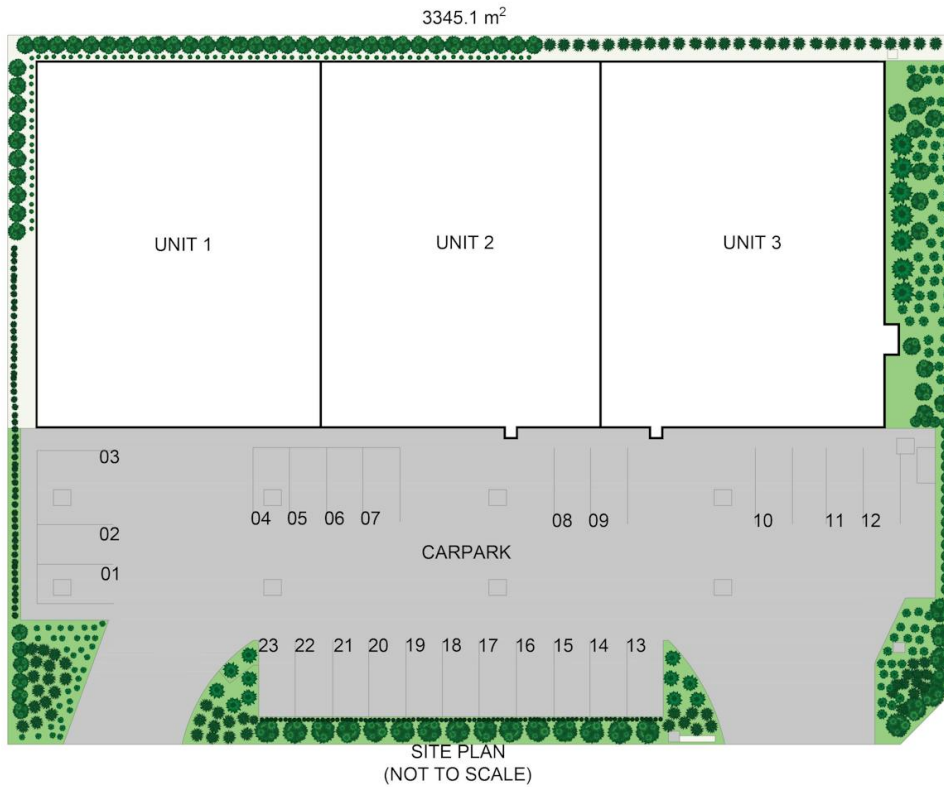

Units 1, 2 3, 122-124 Montague Street, North Wollongong

Scale in metres. Indicative only. Dimensions are approximate. All information contained herein is gathered from sources we believe to be reliable. However, we cannot guarantee its accuracy and interested persons should rely on their own enquiries. Some images may contain digital furniture.

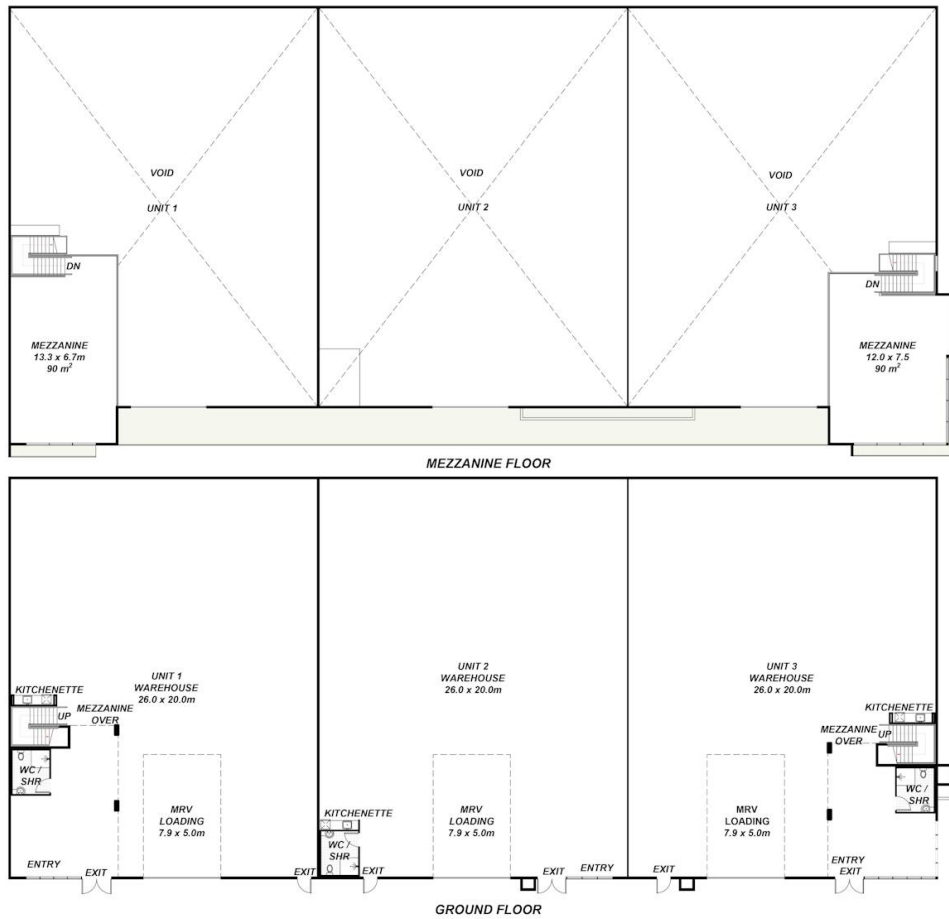

Units 1, 2 3, 122-124 Montague Street, North Wollongong

Scale in metres. Indicative only. Dimensions are approximate. All information contained herein is gathered from sources we believe to be reliable. However, we cannot guarantee its accuracy and interested persons should rely on their own enquiries. Some images may contain digital furniture.