



OUTLINE INDICATIVE ONLY. BOUNDARY LINES ARE APPROXIMATE AND TO BE USED AS A GUIDE ONLY.
BUYERS SHOULD CONDUCT THEIR OWN INDEPENDENT ENQUIRIES TO
DETERMINE THE PROPERTY BOUNDARIES.



6 Petringa Crescent, SPRINGWOOD, QLD 4127

UNBEATABLE LOCATION!

First home buyers and investors, pay attention! This lowset brick and tile property features three bedrooms, one bathroom, a tidy kitchen and separate living and dining areas. A blank canvas if you will!

An outdoor entertaining space directly off the kitchen/dining is the perfect space to unwind. Spend Summers in the inground swimming pool surrounded by a flat grassed backyard, ready for a game of cricket. Conveniently located in Springwood, close to all amenities and walking distance to John Paul College and Saint Edwards Catholic College, this property is surely desirable.

Marketing Agent Nathan Strudwick said, "This is a fantastic opportunity to enter the market or extend your portfolio. Everything you could need at your fingertips in this A-grade location - walk to Roundabout Caf !"

Inside:

- Three bedrooms
- Central bathroom with separate toilet

The particulars contained herein are supplied for information only and shall not be taken as a representation in any respect on the part of the vendor or its agent. Interested parties should contact the nominated person or office for full and current details.

TYPE: For Sale

INTERNET ID: 37P6345

SALE DETAILS

[Contact Agent](#)

CONTACT DETAILS

Elders Real Estate Shailer Park

4/54 Bryants Road
Shailer Park, QLD
(07) 3440 8500

Nathan Strudwick
0455 588 777

- Family kitchen with electric cooktop & overlooking the backyard
- Separate living and dining
- Split system air conditioning
- Ceiling fans
- Security screens

Outside:

- 784m2 block
- Covered entertaining terrace
- Inground saltwater swimming pool
- Double lock up garage

SERVICES:

- Town water & sewerage
- NBN connected

LOCATION:

- Walk to John Paul College
- Walk to Saint Edwards Catholic College
- Walk to bus stop
- Walk to Chatswood Road Woolworths
- Walk to Chatswood Hills State Primary School
- Easy access to the M1 Motorway
- Walking distance to parks and Springwood Conservation Park
- 5 minutes to Springwood Busway
- 8 minutes to the Logan Hyperdome and Brisbane busway
- 5 minutes to Ikea and the Logan Home Centre
- 30 minutes to Brisbane CBD
- 40 minutes to the Gold Coast

Other features: Close to Schools, Close to Shops, Close to Transport

- Land Area 784.00 square metres
- Bedrooms: 3
- Bathrooms: 1
- Double garage









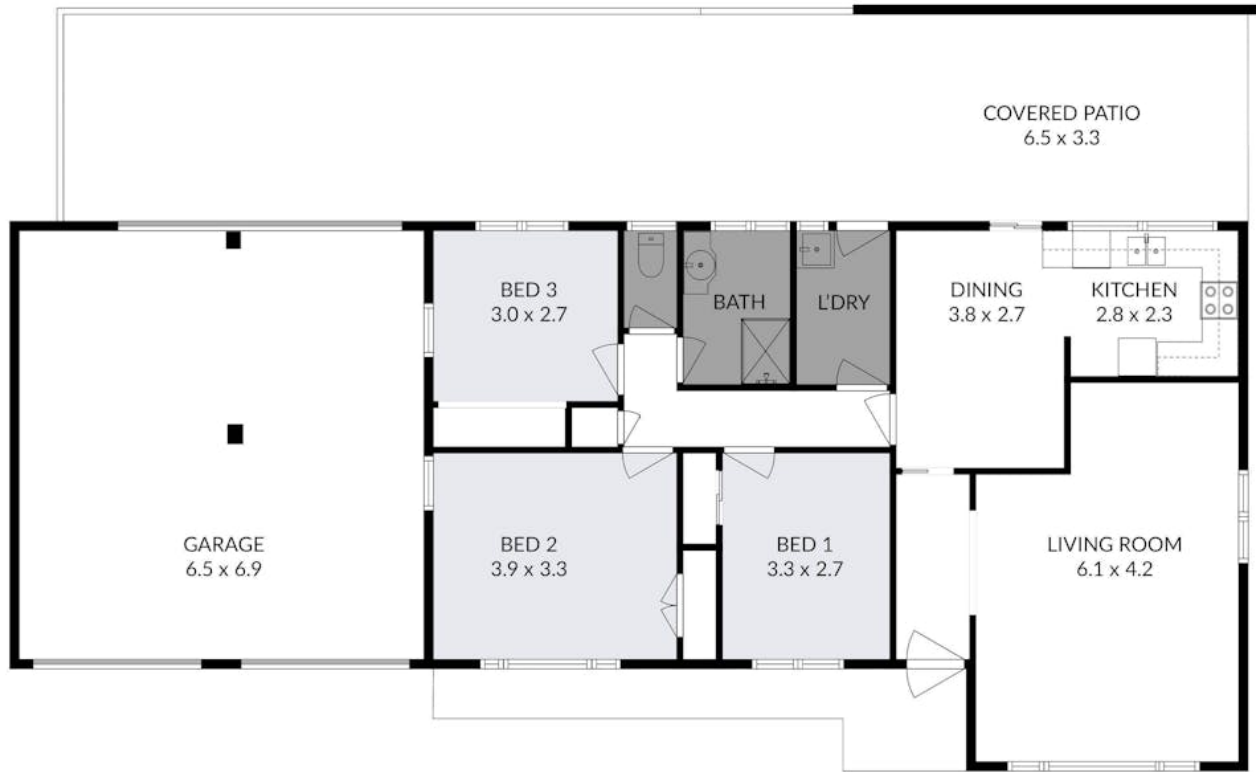

6 PETRINGA CRESCENT, SPRINGWOOD

Bed 3 Bath 1 Car 2

Nathan Strudwick 0432 165 631

Measurements are approximate only and no responsibility is taken for any error, omission, or mis-statement. This is for illustrative purposes only and should be used as such by any prospective purchaser.