

27B Rising Street, SHAILER PARK, QLD 4128

Expansive Family Living on 1,604m² with Pool, Shed & Solar

Set privately on a huge 1,604m² block, this impressive Shailer Park home delivers the space, flexibility and lifestyle families are always searching for. With five bedrooms, three bathrooms, a study, multiple living zones, a salt chlorinated pool and powered shed, this is a property designed for growing families who need room to spread out.

Inside, the floor plan offers outstanding separation across two levels. The lower level features a spacious rumpus room, separate living area, bedroom, study and a beautifully updated kitchen, family and dining zone. The kitchen is a standout, complete with stone-look laminate benchtops, generous storage, gas cooktop, modern cabinetry and a large island bench.

Upstairs, the accommodation continues with three additional bedrooms, including the master bedroom with walk-in robe and ensuite. A wide balcony adds another relaxed space to enjoy, while split system air conditioning throughout keeps the home comfortable year-round.

Outside, the home continues to impress. The large covered rear deck overlooks the backyard and creates the perfect space for entertaining, while the salt chlorinated pool adds instant lifestyle appeal. The powered shed, double car accommodation, expansive

TYPE: For Sale

INTERNET ID: 37P6468

SALE DETAILS

CONTACT AGENT

CONTACT DETAILS

Elders Real Estate Shailer Park

4/54 Bryants Road
Shailer Park, QLD
(07) 3440 8500

Luke Van Wijk
0438 015 656

driveway and 13kW solar system with 10kW inverter make this home as practical as it is impressive.

With established gardens, a private setting and a block size rarely found in this location, this is a home that offers genuine space, flexibility and lifestyle in one complete package.

Luke van Wijk says: "This is the kind of property families are always asking us for - a big block, a large home, multiple living areas, a pool, powered shed and solar. The 1,604m² allotment gives you genuine space, while the floor plan offers fantastic flexibility for growing families, teenagers, guests or those working from home. It's a rare lifestyle opportunity in Shailer Park."

INSIDE:

- 5 bedrooms plus study
- 3 bathrooms including ensuite to master bedroom
- Master bedroom with walk-in robe
- Spacious rumpus room downstairs
- Separate living area plus open family/dining zone
- Updated kitchen with gas cooktop, island bench and excellent storage
- Split system air conditioners throughout
- Ceiling fans and light-filled interiors
- Upper-level balcony
- Practical two-level layout ideal for larger families

OUTSIDE:

- Huge 1,604m² block
- Salt chlorinated swimming pool
- Large covered rear deck, approx. 8.7m x 4.9m
- 6m x 6m powered shed
- Double car accommodation
- Expansive driveway with excellent off-street parking
- 13kW solar system with 10kW inverter
- Established gardens and private surrounds
- Large backyard with room for kids and pets
- Excellent separation between the home, shed, pool and entertaining areas

LOCATION

- Close to Logan Hyperdome

- Close to Brisbane busway (a major public transport hub)
- Instant access to the M1 Motorway
- 5 minutes to John Paul College
- 20 minutes to Movieworld, Wet'n'Wild & Dreamworld
- 30 minutes to Brisbane airport
- 30 minutes to Brisbane
- 40 minutes to Gold coast

Other features: Close to Schools, Close to Shops, Close to Transport, Pool

- Land Area 1,604.00 square metre
- Bedrooms: 5
- Bathrooms: 3
- Double garage





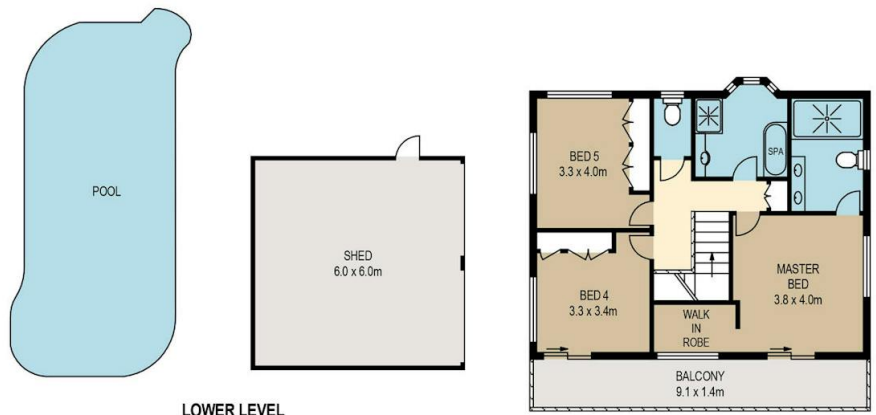

LOWER LEVEL

UPPER LEVEL



LOWER LEVEL



PLANS SHOWN ONLY INDICATIVE OF LAYOUT. DIMENSIONS ARE APPROXIMATE.
 All information contained herein is gathered from sources we believe to be reliable.
 However we cannot guarantee its accuracy and interested persons should rely on their own enquiries.



27B RISING STREET

Created by RealScope®
 www.realscope.com.au