



120-130 Windsor Street, WOODFORD, QLD 4514

Sweeping Lawns , Super size Home ,Massive Farm shed on 8.02 HA on 2 Titles

Quality built Spacious 360M2 split-level family home. This has been a much loved family home for approx. 40 years the original part was built in 1985, and extended & completed in 1995; a master builder's own vision where the workmanship, and use of Australian timbers throughout is testament to attention to detail throughout . Storage galore we counted approx. 55 cupboards

Approx 20 Acres -There is separate town water and power to both blocks â## the property is accessed by a tree lined wide nature strip quite the private entry .

Taps around the front lawn

Mowed areas around house and shed with the balance of the property bush

Features include :

Five generous size bedrooms, each with built in cupboard space. â##

Fifth upstairs bedroom occupying the entire top floor as a master retreat featuring huge private bathroom, lounge room and bedroom. â##

The particulars contained herein are supplied for information only and shall not be taken as a representation in any respect on the part of the vendor or its agent. Interested parties should contact the nominated person or office for full and current details.

TYPE: For Sale

INTERNET ID: 41P3195

SALE DETAILS

Contact Agent

CONTACT DETAILS

Woodford / Kilcoy

119 Archer Street

Woodford, QLD

07 5496 1333

Robyn Anthes

0413 997 824

Separate large kitchen with expansive windows overlooking property. ## plenty of bench space

Open plan living, dining, fireplace with 9 ft ceilings and skylights. ##

Spacious office with external access. ## perfect if you work from home

Downstairs lounge and fireplace.

Family bathroom with stain glass feature. ##

Spacious laundry with ramp access to outside. ## separate toilet

4 Skylights in total

Sunroom

80 square metre car port easily fitting four vehicles.

The Farm Shed

375 square metre shed/workshop with raised floor, multiple access garages, 3 phase power (house and shed on separate switchboards and meters) ## Comes with some hidden gems

Garden shed

Small waterhole boundary fenced

Minutes drive to Woodford central , 25 Minutes to Caboolture and Train station

Please call Robyn 0413 997824 for inspections 7 days a week

DISCLAIMER, Elders Gold Property its directors, employees and related entities believe that the information contained herein is gathered from sources we deem to be reliable. However, no representation or warranties of any nature whatsoever are given, intended or implied. Any interested parties should rely on their own inquiries.

Other features: 3 Phase Power

- Land Area 8.02 hectares
- Bedrooms: 5
- Bathrooms: 2
- Double garage
- 4 car carport



120 - 130 WINDSOR STREET, WOODFORD

LAND - 1000sqm (0.12 ha)

0 10 20 30 40 50 60 70 80 90 100



120 - 130 WINDSOR STREET, WOODFORD

APPROX FLOOR AREA - 2500sq

0 10 20 30 40 50 60 70 80 90 100









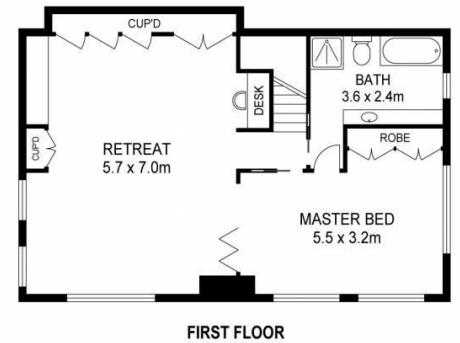
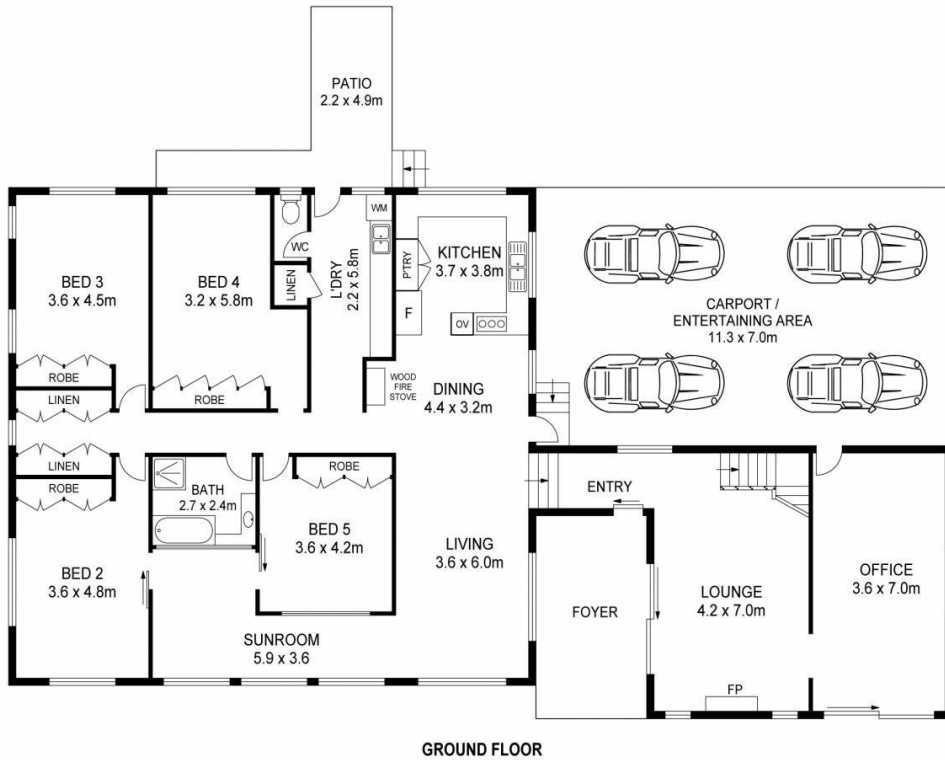

120 - 130 WINDSOR STREET, WOODFORD

APPROX FLOOR AREA : 359m²



For illustrative purposes only. Not an engineering plan.

Whilst all effort is taken to be correct, this plan may contain inaccuracies or omissions and should be used only as a guide.
No representations are made as to the condition, operability or legal status of anything depicted.