



## 21 Cecil Baldwin Close, WEST KEMPSEY, NSW 2440

### Rock Solid & Ready To Go!

With the recent Covid-19 restrictions we would like to advise that the following government guidelines, face masks and check-in will be required upon entry to private inspections. We are also offering virtual inspections upon request.

At Elders Lifestyle Group we are continuing to serve the needs of our customers, with a focus on ensuring our clients are well serviced throughout this period. We are here to support you and provide guidance during these times. If we can assist you with any of your property needs please do not hesitate to get in touch. We thank you for your understanding as we navigate through this period together.

Brick homes in this price range are a rare commodity in this market, especially roomy three bedrooms residences which makes this Torrens Title property worthy of serious consideration. Having three bedrooms, ensuite and large living/dining area makes it an easy fit for your family and with a large rear yard you have space for the kids pet. Alternatively investors should this property has a long, successful and profitable history and as there is a tenant in place you could be reaping the benefits immediately upon settlement.

Property Details -

Council Rates: Contact Agent (pa approx)

**TYPE:** Sold

**INTERNET ID:** 5P13200

**SALE DETAILS**

**\$378,000**

**CONTACT DETAILS**

**Leah Elford**  
0428 295 952

Land Size: 490 sqm

Rental Potential: \$360 per week

DISCLAIMER: The information contained in the advertising of this property is based on information provided to the agents, and the vendor and agents expressly disclaim any liability arising therefrom. The accuracy of the information cannot be guaranteed, and prospective purchasers should make their own enquiries and form their own judgement as to these matters.

Other features: Carpeted

- Land Area 490.00 square metres
- Bedrooms: 3
- Bathrooms: 2
- Car Parks: 1
- Ensuite





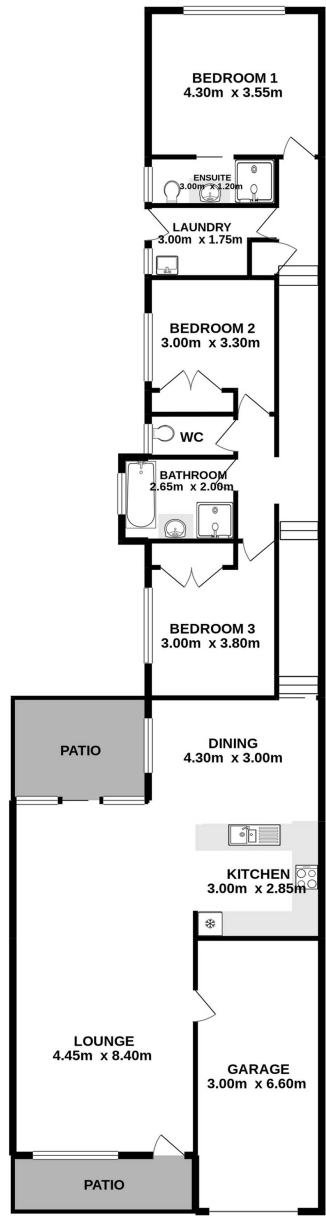

21 Cecil Baldwin Close West Kempsey TOTAL FLOOR AREA: 151.5 sq.m. approx.  
Measurements are approximate. We do not take liability for any information supplied. OpenView does not take any responsibility for any information supplied.