



EAST GOSFORD NSW 2250

Private resort style waterfront living with Jetty and Boathouses

Immersed in breathtaking panoramas of Brisbane Water, capturing sweeping views from every angle, this architect-designed home offers private waterfront living at its finest. This full brick mansion is poised on a rare 2,218 sqm double block waterfront landholding & exclusive streets in East Gosford with just a short stroll to parklands, cafes, shops, schools and a short drive to several beautiful coastal beaches, Erina Fair shopping Centre, Gosford CBD & the M1 interchange.

Features:

- Luxury mansion overlooks private boathouse, slipway and jetty
- Grand interiors are enhanced with soaring high ceilings
- Paved alfresco setting surrounds wet-edge swimming pool
- Granite kitchen has a gas stove, an island bench, walk-in pantry
- Impressively scaled bedrooms appointed with built-in robes
- Private guest quarters adjoin the waterfront indoor spa pool
- Palatial master complete with oversized En-suite and balcony

The particulars contained herein are supplied for information only and shall not be taken as a representation in any respect on the part of the vendor or its agent. Interested parties should contact the nominated person or office for full and current details.

TYPE: For Sale

INTERNET ID: 69P2012

SALE DETAILS

Expression Of Interest

CONTACT DETAILS

**Elders Real Estate
Hornsby**

502 / 88-90 George Street
Hornsby, NSW
02 9987 0198

Kelvin(Chen) Gao
0403 303 419

- Gas fireplace, plantation shutters, ducted air conditioning
- Four-car lock-up garage with a giant storage area, covered access to the property
- Walking distance to Caroline Bay Park and coastal walks, Japanese Gardens/art gallery

Convenient and fast transactions, we recommend contacting a Mortgage Broker Nancy Dai 0432 408 911 or Nancy@oceanfortunes.com . (24/7 reply)

Disclaimer: The information presented has been furnished from sources we deem to be reliable. We have no reason to doubt its accuracy, however, we cannot guarantee it. All interested parties should rely on their enquiries to determine the accuracy of this information. To view our Privacy Policy, please visit our Elders Real Estate website.

Other features: Close to Schools, Close to Shops, Close to Transport, Pool, Spa

- Bedrooms: 5
- Bathrooms: 3
- 4 car garage
- Ensuite







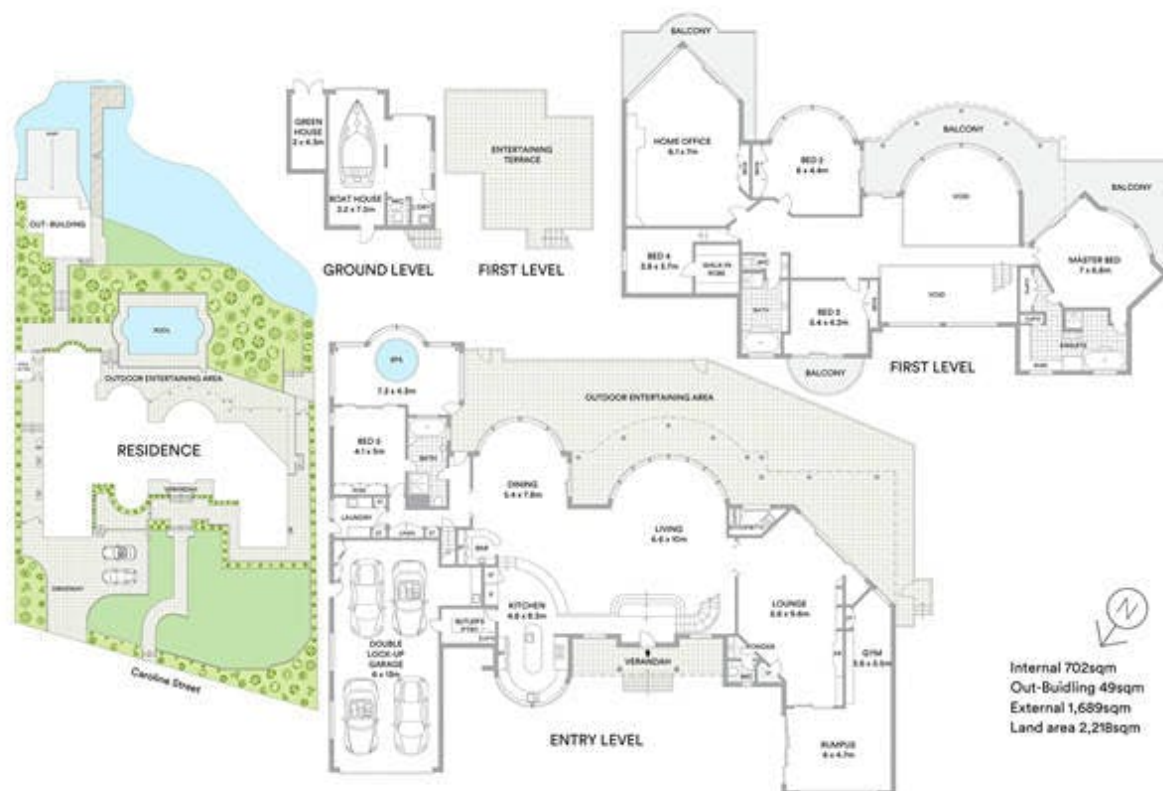

Scale in metres. Indicative only. All information contained herein is obtained from sources we believe to be accurate. We cannot guarantee its accuracy. Interested persons should make and rely on their own enquiries.