



## 259 Campbells Road, DUNGAY, NSW 2484

### Elevated Rural Retreat

Stunning views of Mt Warning and the surrounding valley are enjoyed from a huge timber entertaining deck along with memorable sunsets. The home has been renovated and is move in ready for a family wanting to enjoy this rural, peaceful location at the end of a quiet road. 3 good sized bedrooms, open plan living with views from every room including the bath tub.

This 50 acre elevated property is only minutes to Murwillumbah and a 30 minute drive to Tweed Coast and Gold Coast beaches. There are fruit trees and a vegie garden with room for a horse or your very own menagerie.

#### Property Features

- \* Fireplace
- \* Stunning Views
- \* Separate Garage and Workshop
- \* Large Entertaining Deck

**TYPE:** Sold

**INTERNET ID:** 71P0974

#### SALE DETAILS

**\$1,300,000**

#### CONTACT DETAILS

**Tweed Valley & Coolangatta**  
1/36-42 Main Street & 3/70 Griffith Street  
Murwillumbah & Coolangatta, NSW/QLD  
02 5602 2950

**Craig Dudgeon**  
0408 188 184

\* Wine Cellar

Don't delay and call Craig Dudgeon today!! 0408188184

Disclaimer:

All information contained herein is gathered from sources we believe to be reliable. Elders Tweed Valley and its staff will not be held responsible for any act or omission arising from the accuracy of such material.

We cannot guarantee its accuracy and interested persons should rely on their own enquiries.

Other features: Area Views, Bush Retreat, Exhaust

- Land Area 50.48 acres
- Bedrooms: 3
- Bathrooms: 1
- Double garage

















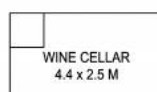
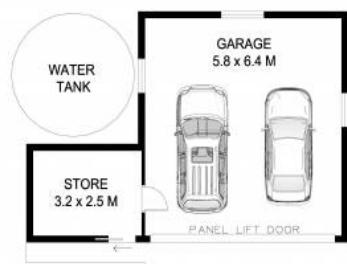

**BASEMENT**

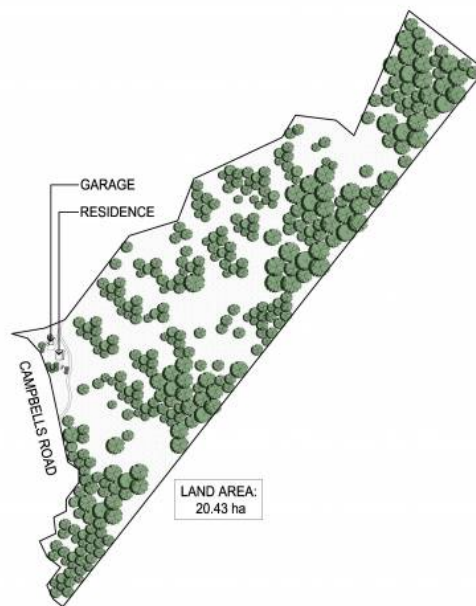

**SITE PLAN**

0 1 2 3 4 5

Scale in metres. Indicative only. Dimensions are approximate. All information contained herein is gathered from sources we believe to be reliable. However we cannot guarantee its accuracy and interested persons should rely on their own enquiries.

INTERNAL : 199 SQ.M.  
EXTERNAL : 108 SQ.M.



**259 Campbells Road, Dungay**

