



## 130 Hammond Drive, CLOTHIERS CREEK, NSW 2484

### Views of the Stunning Tweed Valley

This elevated 12.35 acre property makes you feel like living in the clouds. Perched conveniently between Murwillumbah and the Tweed Coast in a quiet location many of us dream of. 3 Bedrooms 1 bathroom with a huge shed for 3 vehicles, 13.5kw of solar and ample storage. This is a highly regarded street and represents a great opportunity to capitalise on this stunning location.

#### Property Features

- \* 3 Bedrooms
- \* 1 Bathrooms
- \* 12.35 Acres with dam
- \* Huge 13.5kw solar system
- \* Large shed for every hobby

**TYPE:** Sold

**INTERNET ID:** 71P1097

#### SALE DETAILS

**\$1,335,000**

#### CONTACT DETAILS

##### **Tweed Valley & Coolangatta**

1/36-42 Main Street & 3/70 Griffith Street  
Murwillumbah & Coolangatta, NSW/QLD  
02 5602 2950

##### **Craig Dudgeon**

0408 188 184

- 10 minutes to Murwillumbah
- 25 minutes to Tweed Heads
- 25 minutes to Kingscliff
- 25 minutes to Gold Coast International Airport
- 50 minutes to Byron
- 1hr 30 minutes to Brisbane

Don't delay and call Craig Dudgeon 0408188184 or Dan Smith 0415 650 852 today!!

Disclaimer:

All information contained herein is gathered from sources we believe to be reliable. Elders Tweed Valley and its staff will not be held responsible for any act or omission arising from the accuracy of such material.

We cannot guarantee its accuracy and interested persons should rely on their own enquiries.

Other features: Area Views

- Land Area 12.35 acres
- Building Area: 110.00 square metres
- Bedrooms: 3
- Bathrooms: 1
- 3 car garage

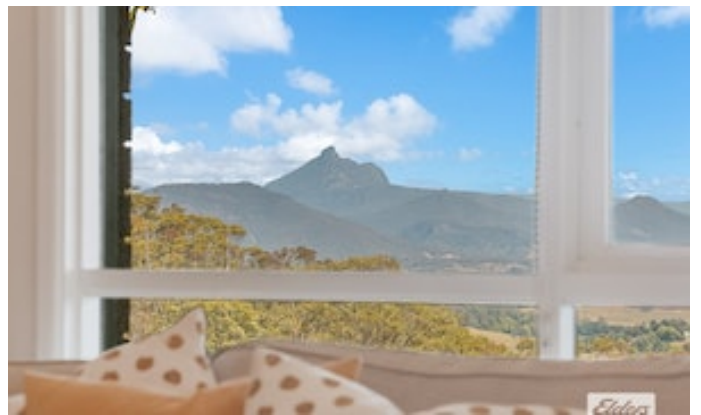









**RESIDENCE**

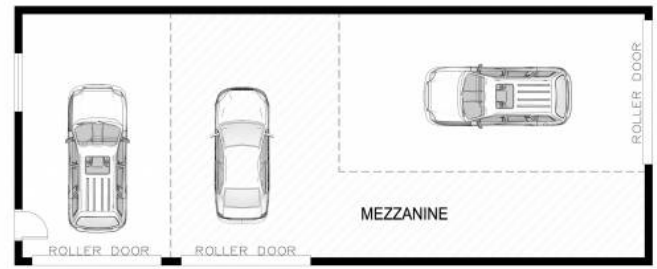

**SHED/GARAGE**  
15.9 x 6.1 M



Scale in metres. Indicative only. Dimensions are approximate. All information contained herein is gathered from sources we believe to be reliable. However we cannot guarantee its accuracy and interested persons should rely on their own enquiries.

INTERNAL : 106 SQ.M.  
EXTERNAL : 93 SQ.M.  
SHED/GARAGE: 97 SQ.M.



130 Hammond Drive, Clothiers Creek

