



1372 Myrtle Mountain Road, MYRTLE MOUNTAIN, NSW 2550

"Bowerdale" – A Piece of Candelo's History on 30 Acres

Built in 1923 as the original farmhouse for "Bowerdale", this charming residence is a rare offering - rich in history, thoughtfully updated, and set on just over 12.2 hectares (30 acres) of gently undulating, productive land. All this, less than 10 minutes from the stunning village of Candelo.

The current owners have undertaken extensive renovations to ensure modern comfort while preserving the home's heritage soul. A new roof (2020), beautifully appointed kitchen, wide original timber floorboards, fresh paint throughout, stunning pressed tin ceilings and the addition of double-glazed windows create a home that feels both timeless and practical.

Light-filled living areas and the kitchen face north, opening seamlessly onto a stunning verandah overlooking the classic cottage garden - the perfect place for morning coffee or long lunches with friends.

The land itself is a standout feature. A seam of rich basalt soil supports thriving, productive fruit trees - including a prolific banana tree that will keep family and friends well supplied (and inspire plenty of creative banana recipes!). A large Chook house with spacious fenced area is perfect for free range egg production and the enclosed veggie

The particulars contained herein are supplied for information only and shall not be taken as a representation in any respect on the part of the vendor or its agent. Interested parties should contact the nominated person or office for full and current details.

TYPE: For Sale

INTERNET ID: 78P1315

SALE DETAILS

\$1,150,000

CONTACT DETAILS

Elders Real Estate Bega

Shop 3/248 Carp Street
Bega, NSW
02 6492 1799

Rodney McDonald

0410 529 517

patch is productive and safe from local wildlife.

The property is well fenced, with all paddocks serviced by troughs or a dam, and a bore providing reliable water for both gardens and stock.

Previously home to Candelo Stockfeeds, the shedding is exceptional for a property of this scale - offering outstanding storage, workshop space or scope for a range of rural pursuits. A detached studio provides the ideal home office, creative space or private gym.

Sustainability is also front of mind with a 7.2kW solar system and Tesla battery, delivering energy efficiency and long-term savings. Two 40,000L water tanks with significant catchment off the house and sheds secures the residential water and a 50,000L concrete stock tank is fed by the bore and excess rain water.

This is the perfect lifestyle property - historic, productive and beautifully presented - ready for its next chapter.

If you've been dreaming of space, privacy and a genuine connection to the land, "Bowerdale" is ready to welcome you home.

- Land Area 30 acres
- Bedrooms: 3
- Bathrooms: 1









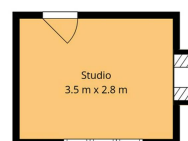

1372 Myrtle Mountain Road
MYRTLE MOUNTAIN

TOTAL: 150 m2
1st floor: 150 m2
EXCLUDED AREAS: VERANDAH: 88 m2, WALLS: 12 m2
Measurements Are Approximate And Should Be Used As a Guide Only.

