

3 Lipman Street, SALISBURY, SA 5108

Renovate or Develop

Please note: Best and final offers will need to be submitted by 5pm Wednesday 14th of January.

Located in a very handy position with easy access to school, shopping, public transport and more this property offers you lots of potential.

The 1962 built solid brick home consists of 3 bedrooms, a lounge room and dining room. The home has high ceilings, timber floors, a split system air conditioner, rear verandah and out the back is a shed.

The property is in need of some TLC and those up for a bit of work could give the home a fresh start or there is a possibility to develop the property (subject to council consent).

The block is 710sqm.

TYPE: For Sale

INTERNET ID: 80P4758

SALE DETAILS

\$650,000 - \$695,000

CONTACT DETAILS

Elders Real Estate Gawler

37 Murray Street

GAWLER, SA

08 8522 1988

RLA: 64256

Christopher Hurst

0412 897 020

Ready to make an offer? Head to eldersgawler.com.au, select the property, and click

The particulars contained herein are supplied for information only and shall not be taken as a representation in any respect on the part of the vendor or its agent. Interested parties should contact the nominated person or office for full and current details.

the 'Make an Offer' tab to submit your offer online in just a few steps.

All information contained herein is gathered from sources deemed to be reliable. However, we cannot guarantee its accuracy and interested persons should seek their own enquiries.

- Land Area 710.00 square metres
- Bedrooms: 3
- Bathrooms: 1
- Single garage





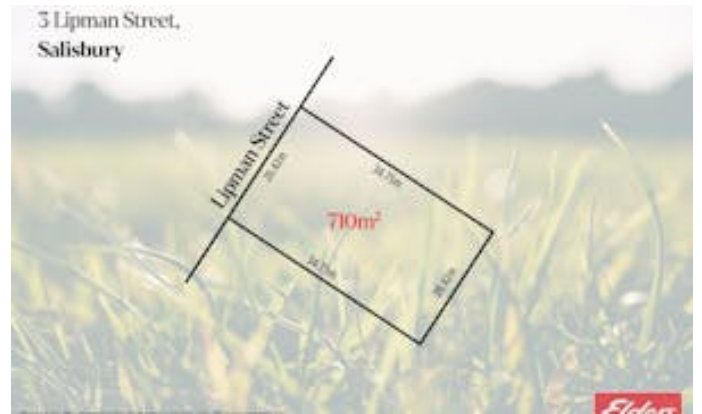

3 Lipman Street,
SALISBURY

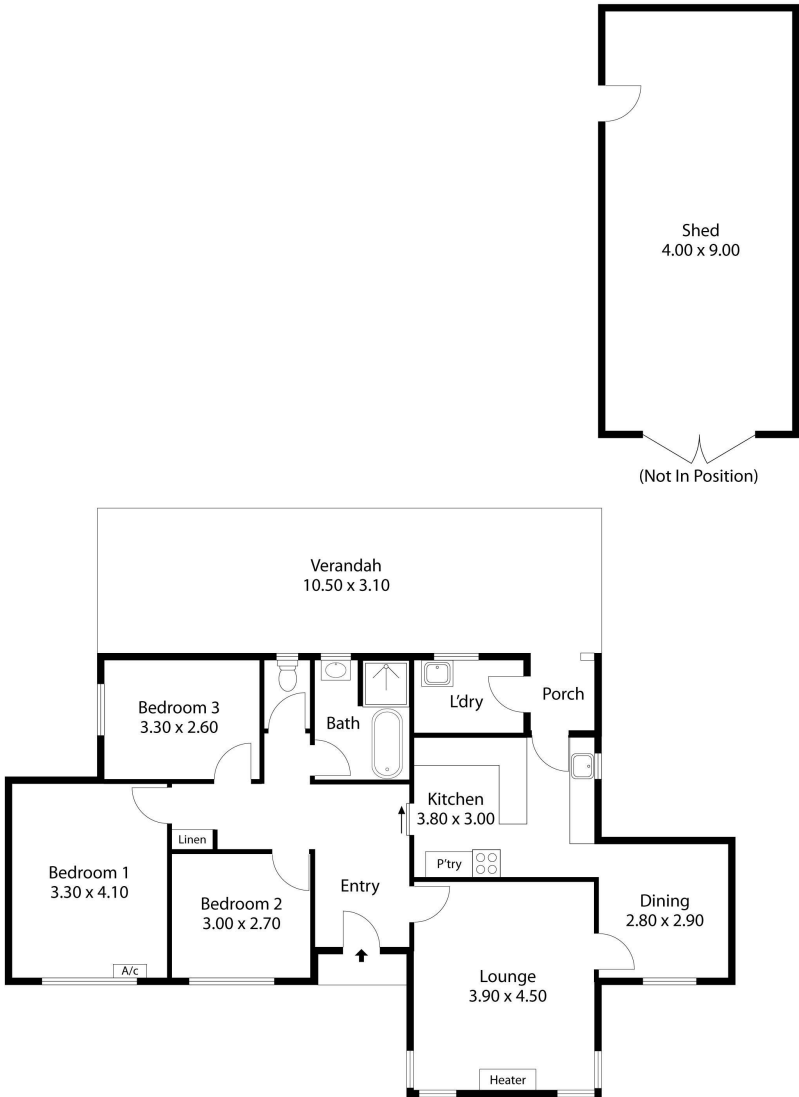

Living:	98.68SQ.M
Verandah:	33.00SQ.M
Shed:	36.00SQ.M
TOTAL:	167.68SQ.M



This Drawing is for illustration purposes only. All measurements are internal and approximate. Details intended to be relied upon should be independently verified.