



## 23 Mount Terrace, GAWLER SOUTH, SA 5118

On a Big Block in a Great Spot.

Situated in a very handy location close to schools, shops and more this property has lots of potential.

The 3 bedroom 1970's built home has a lounge room, dining room and a central kitchen. There is a slow combustion heater, timber floor boards, a front and rear verandah plus a large shed.

All located on a big 1017sqm (quarter acre block) this property offers buyers the opportunity to renovate or develop (subject to council consent).

Ready to make an offer? Head to [eldersgawler.com.au](http://eldersgawler.com.au), select the property, and click the 'Make an Offer' tab to submit your offer online in just a few steps.

All information contained herein is gathered from sources deemed to be reliable. However, we cannot guarantee its accuracy and interested persons should seek their own enquiries.

**TYPE:** For Sale

**INTERNET ID:** 80P4803

**SALE DETAILS**

**\$500,000 - \$550,000**

**CONTACT DETAILS**

**Elders Real Estate Gawler**

37 Murray Street

GAWLER, SA

08 8522 1988

RLA: 64256

**Christopher Hurst**

0412 897 020

- Land Area 1,017.00 square metre
- Bedrooms: 3
- Bathrooms: 1
- Single garage











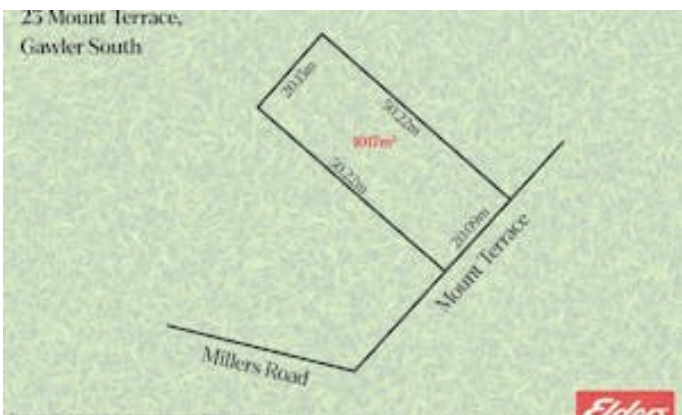

23 Mount Terrace  
**GAWLER SOUTH**

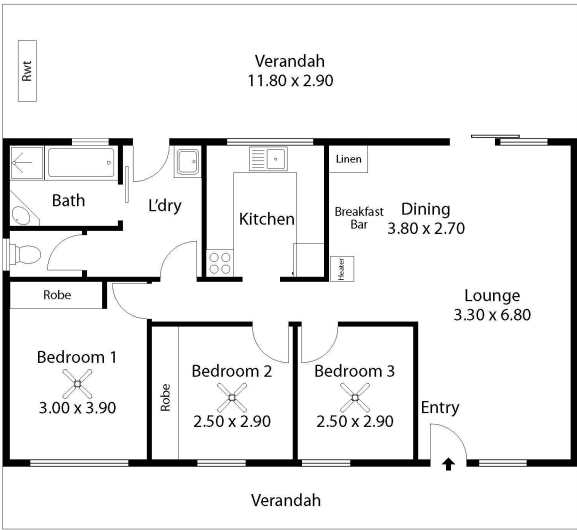
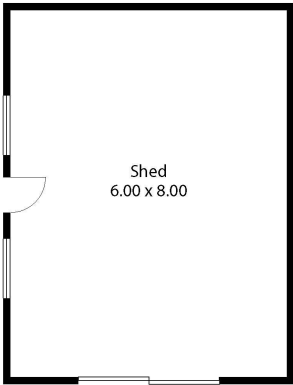

Living:	84.83SQ.M
Verandah:	56.81SQ.M
Shed:	48.00SQ.M
<hr/>	
<b>TOTAL:</b>	<b>186.64SQ.M</b>



This Drawing is for illustration purposes only. All measurements are internal and approximate. Details intended to be relied upon should be independently verified.